

Before you can use the machine, you must set up the machine.
Please read this "Quick Setup Guide" for proper set up instructions.

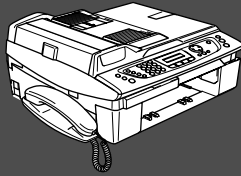

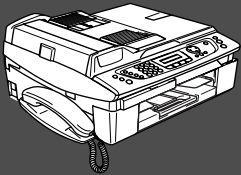



Setting Up the Machine









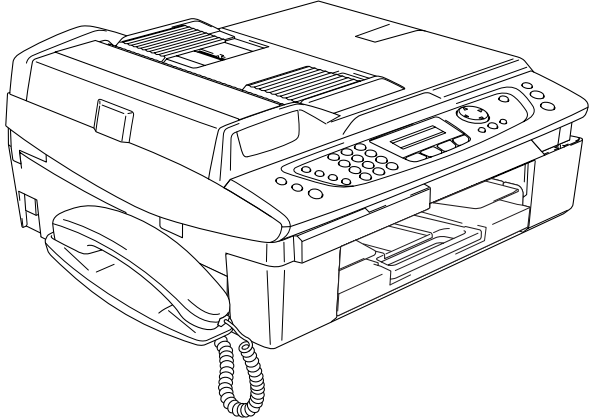
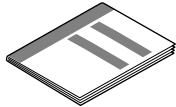
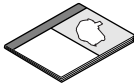

Setup is Complete!

To find the best solution for your problem or question, access the Brother Solutions Center:
<http://solutions.brother.com>
Keep this "Quick Setup Guide" and User's Guide in a convenient place for quick and easy reference at all times.

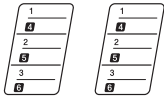
 Warning		 Hint	 User's Guide
Indicates warnings that must be observed to prevent possible personal injury.	Indicates cautions that must be observed to use the machine properly or to prevent damage to the machine.	Indicates notes and useful tips to remember when using the machine.	Indicates reference to the User's Guide.

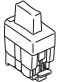
■ Getting Started

Carton Components

	 Quick Setup Guide		
	 User's Guide		
	 Power Cord		
 Telephone Line Cord	 One Touch Labels	 Telephone Handset	
 Black (LC900BK)	 Magenta (LC900M)	 Yellow (LC900Y)	 Cyan (LC900C)
Ink Cartridges			

Carton components may differ from one country to another.
Save all packing materials and the carton.

Control Panel

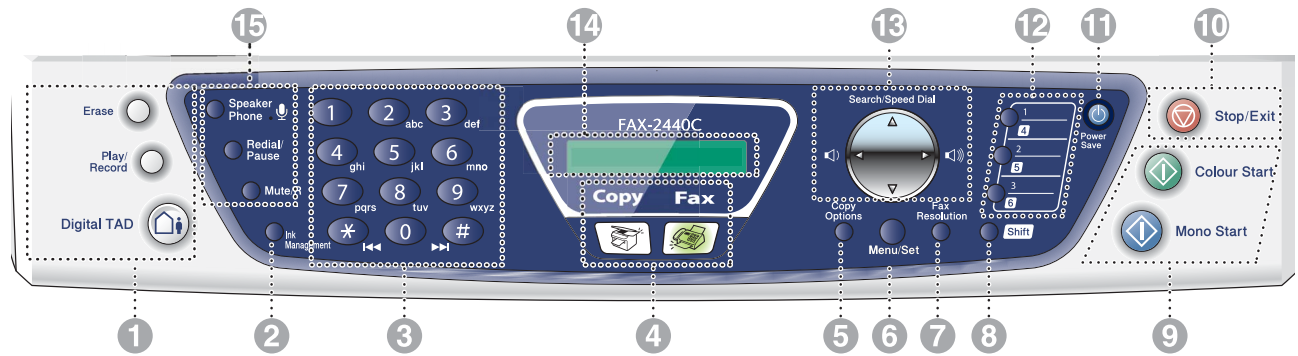

1. Message Center keys	6. Menu/Set key	11. Power Save key
2. Ink Management key	7. Fax Resolution key	12. One Touch keys
3. Dial Pad	8. Shift	13. Navigation keys
4. Mode keys	9. Start keys	14. Liquid Crystal Display (LCD)
5. Copy Options key	10. Stop/Exit key	15. Fax and Telephone keys



For the details of the control panel, see "Control panel overview" in Chapter 1 of the User's Guide.

Table of Contents

Setting Up the Machine

1. Removing the Protective Parts	4
2. Installing the Handset	4
3. Loading Paper	4
4. Installing the Phone Line and Power Cord	5
5. Installing the Ink Cartridges	6
6. Print Quality Check	8
7. Setting the Date and Time	9
8. Setting Your Station ID	9
9. Selecting a Receive Mode	10
10. Setting Up the Message Center	10
11. Using the FAX as a Printer or for PC-FAX Send	11

Replacement Consumables

Ink Cartridge	12
---------------------	----

Setting Up the Machine

1 Removing the Protective Parts

- 1 Remove the protective tape.

2 Installing the Handset

- 1 Connect the curled handset cord to the handset.

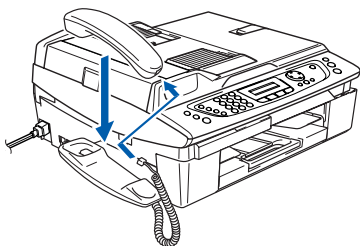

3 Loading Paper



You can load up to 100 sheets of 80 g/m² paper.
For more details, see "About paper" in Chapter 1 of the User's Guide.

- 1 Pull the paper tray completely out of the machine and remove the output paper tray.

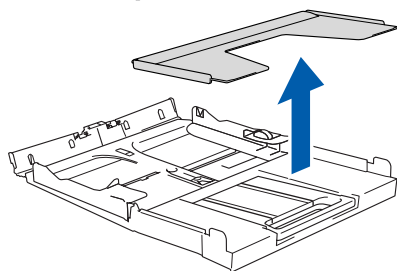
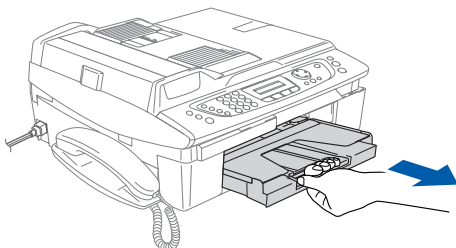

- 2 Press and slide the paper guide to fit the paper width.

Paper Side Guide

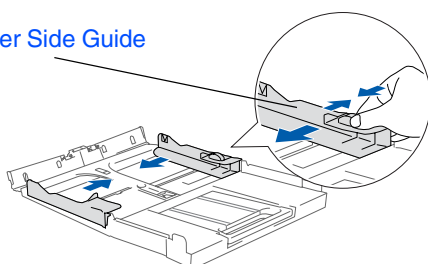

- 3 Pull out the paper support and unfold the paper support flap.

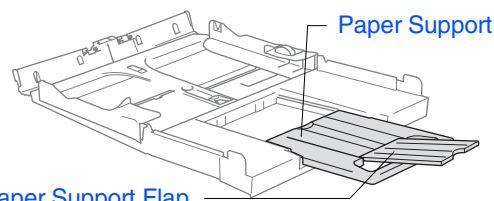

- Use the paper support flap for Letter, Legal and A4 size paper.

- 4 Fan the stack of paper well to avoid paper jams and mis-feeds.

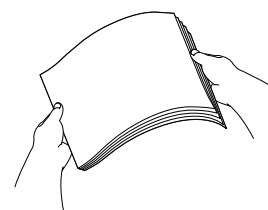

- 5 Gently insert the paper into the paper tray print side down and top edge first. Check that the paper is flat in the tray and below the maximum paper mark.

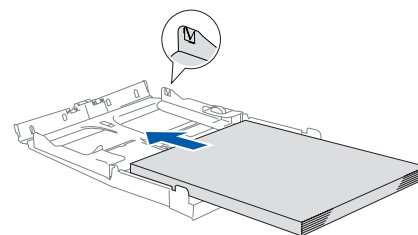

- Make sure the paper side guides touch the side of the paper.
- Be careful that you do not push the paper in too far; it may lift at the back of the tray and cause paper feed problems.

- 6 Put the output paper tray back on and push the paper tray firmly back into the machine.

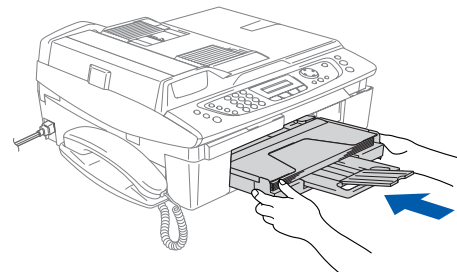

4

Installing the Phone Line and Power Cord

1 Connect the power cord.

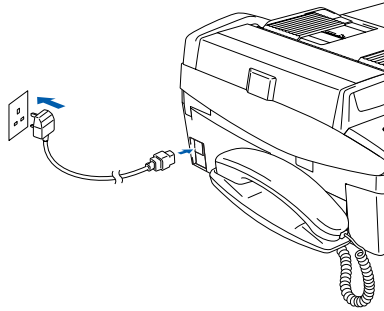

(Example for the U.K.)

2 Connect the telephone line cord. Connect one end of the telephone line cord to the socket on the machine marked **LINE** and the other end to a modular wall socket.

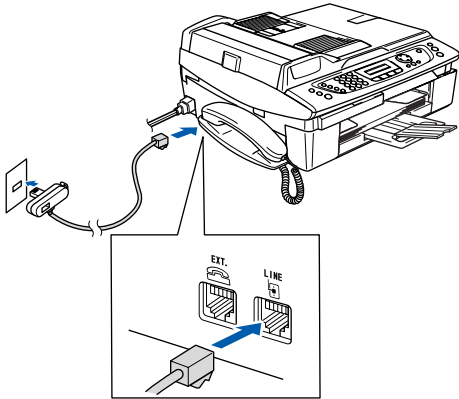

(Example for the U.K.)

Warning

- The machine must be fitted with an earthed plug.
- Since the machine is grounded through the power outlet, you can protect yourself from potentially hazardous electrical conditions on the telephone network by keeping the power switched on when you connect the machine to a telephone line. Similarly, you can protect yourself when you want to move your machine by disconnecting the telephone line first and then the power cord.



If you are sharing one phone line with an external telephone, connect it as shown below.

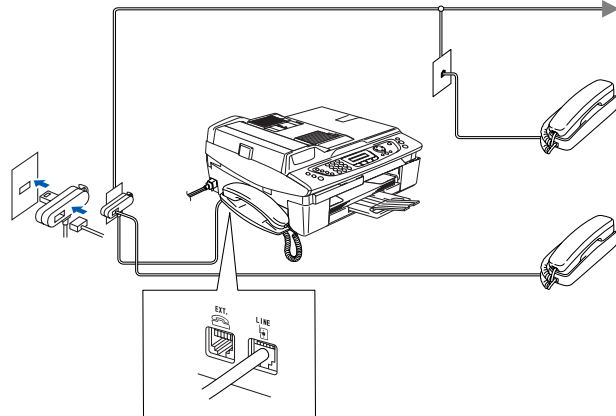

(Example for the U.K.)



If you are sharing one phone line with an external telephone answering machine, connect it as shown below.



For more details, see "Connecting an external device to your machine" in Appendix of the User's Guide.

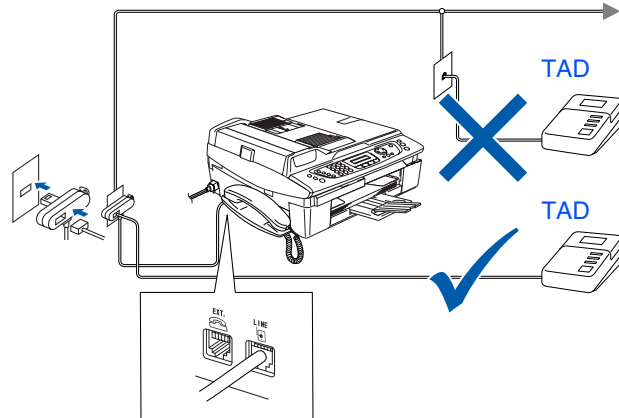

(Example for the U.K.)

Setting Up the Machine

5 Installing the Ink Cartridges



Warning

If ink gets in your eyes wash them with water immediately, and if irritation occurs consult a doctor.

- 1 Make sure that the power is turned on.
The LCD shows:

No Cartridge

- 2 Lift the scanner cover from the right-hand side of the machine until it locks securely into open position.

Scanner Cover

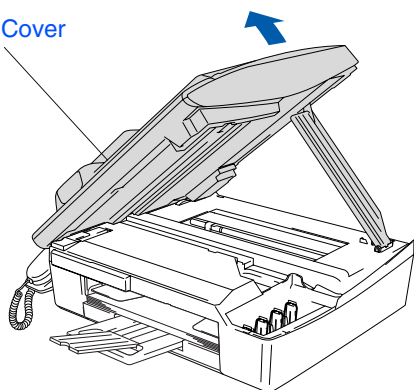

- 3 Remove the protective parts.

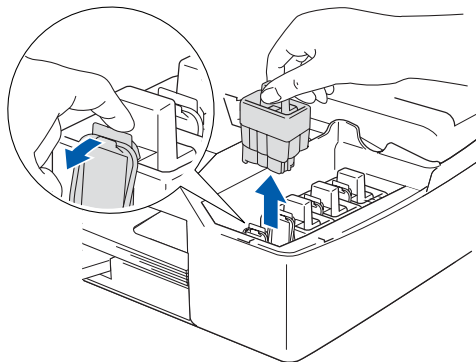

Do not throw away the protective parts.
You will need them when you transport the machine.

- 4 Take out the ink cartridge.

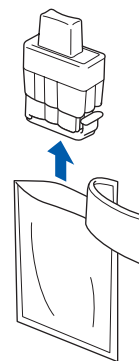

- 5 Carefully remove the bottom cap.



DO NOT touch the area shown in the illustration below.

Opening

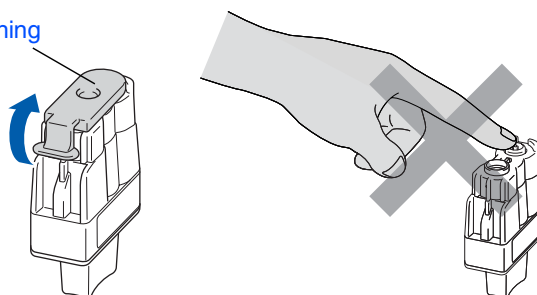

If the cartridge cover comes off when you open the bag the cartridge will not be damaged.

Keep the ink cartridge in an upright position when you insert it into the slot.

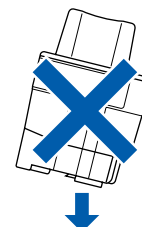

6 Press firmly down on the ink cartridge until the hook snaps over it, taking care to match the slot colour (A) with the cartridge colour (B), as shown in the diagram below.

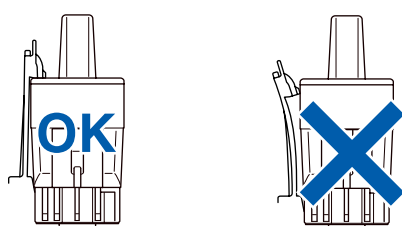
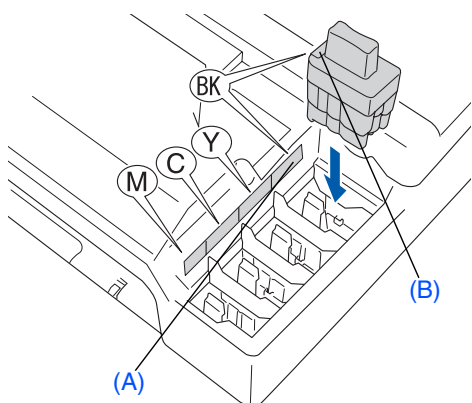

7 Lift the scanner cover to release the lock. Gently push the scanner cover support down and close the scanner cover.

 If **Install** shows on the LCD after you install the ink cartridges, check to make sure the ink cartridges are installed correctly.

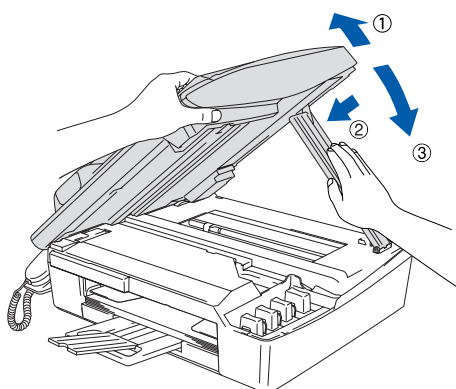

The machine will clean the ink tube system for use for the first time. This process will occur only once, the first time ink cartridges are installed. The cleaning process will last approximately four minutes.

The LCD shows:

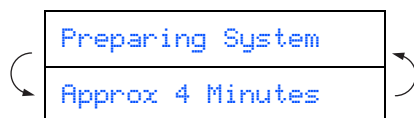

- **DO NOT** remove ink cartridges if you do not need to replace them. If you do so, it may reduce the ink quantity and the machine will not know the quantity of ink left in the cartridge.
- **DO NOT** shake the ink cartridges. If ink stains your body or clothing, wash with soap or detergent immediately.
- **DO NOT** insert and remove the cartridges repeatedly. If you do so, the ink may seep out of the cartridge.
- Brother inkjet machines are designed to work with ink of a particular specification and work to a level of optimum performance when used with genuine Brother ink cartridges. Brother cannot guarantee this optimum performance if ink or ink cartridges of other specifications are used. Brother does not therefore recommend the use of cartridges other than genuine Brother cartridges with this machine or the refilling of empty cartridges with ink from other sources. If damage is caused to the print head or other parts of this machine as a result of the use of ink or ink cartridges other than genuine Brother products due to the incompatibility or lack of suitability of those products with this machine, any repairs required as a result will not be covered by the warranty.



- If you mix the colours by installing an ink cartridge in the wrong position, you must clean the print head by running several cleaning cycles after correcting the cartridge installation. (See "Cleaning the print head" in chapter 12, *Troubleshooting and Routine Maintenance in the User's Guide*.)
- Once you open an ink cartridge, install it in the machine and use it up within six months of installation. Use unopened ink cartridges by the expiration date written on the cartridge package.

Setting Up the Machine

6

Print Quality Check

- 1 After the cleaning cycle is finished, the LCD shows:

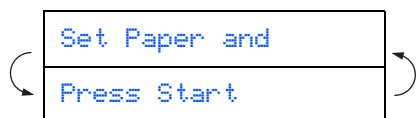

- 2 Make sure the paper is loaded in the paper tray.

Press **Colour Start**.

The machine starts printing the PRINT QUALITY CHECK SHEET (only during initial ink cartridge installation).

- 3 Check the quality of the four colour blocks formed by the short lines printed on the sheet.
(BLACK/ CYAN/ YELLOW/ MAGENTA)

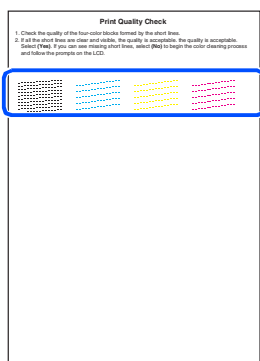

Avoid touching the printed surface of the paper immediately after printing, the surface may not be completely dry and may stain your fingers.

- 4 The LCD shows:

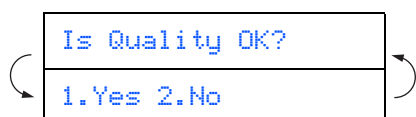

- 5 If all lines are clear and visible, press **1** on the dial pad to finish the quality check.

---OR---

If you can see missing short lines, press **2** on the dial pad and go to **6**.

OK

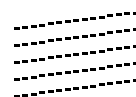

Poor

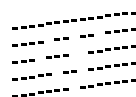

- 6 The LCD asks you if the print quality is OK for black and colour. Press **1** or **2** on the dial pad.

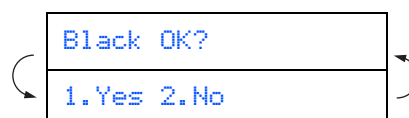

After making your selection **1 (Yes)** or **2 (No)** for both black and colour, the LCD shows:

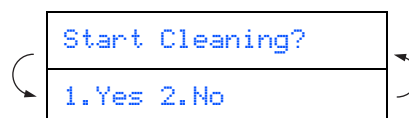

Press **1 (Yes)**, the machine will then start cleaning the colours.

After cleaning is finished, press **Colour Start**. The machine starts printing the PRINT QUALITY CHECK SHEET again and goes back to step **3**.

7 Setting the Date and Time

- 1 Press **Menu/Set**.
- 2 Press **0**.
- 3 Press **2**.
- 4 Enter the last two digits of the year on the dial pad, and then press **Menu/Set**.

Year: 2004

 (e.g. Enter **0 4** for 2004.)
- 5 Enter the two digits for the month on the dial pad, and then press **Menu/Set**.

Month: 03

 (e.g. Enter **0 3** for March.)
- 6 Enter the two digits for the day on the dial pad, and then press **Menu/Set**.

Day: 01

 (e.g. Enter **0 1**.)
- 7 Enter the time in 24-hour format on the dial pad, and then press **Menu/Set**.

Time: 15:25

 (e.g. Enter **1 5, 2 5** for 3:25 P.M.)
- 8 Press **Stop/Exit**.

 If you want to repeat input, press **Stop/Exit** to start from Step 1.

8 Setting Your Station ID

You should store your name and fax number to be printed on all fax pages that you send.

- 1 Press **Menu/Set**.
- 2 Press **0**.
- 3 Press **3**.
- 4 Enter your fax number (up to 20 digits) on the dial pad, and then press **Menu/Set**.

Fax: _
- 5 Use the dial pad to enter your name (up to 20 characters), and then press **Menu/Set**.

Name: _



- Refer to the following chart for entering your name.
- If you need to enter a character that is on the same key as the previous character, press  to move the cursor to the right.

Press key	One time	Two times	Three times	Four times
2	A	B	C	2
3	D	E	F	3
4	G	H	I	4
5	J	K	L	5
6	M	N	O	6
7	P	Q	R	S
8	T	U	V	8
9	W	X	Y	Z



For more details, see "Setting the Station ID" in Chapter 2 of the User's Guide.

- 6 Press **Stop/Exit**.



If you want to repeat input, press **Stop/Exit** to start from Step 1.

Setting Up the Machine

9 Selecting a Receive Mode

There are three possible receive modes: **Fax Only**, **Fax/Tel** and **Manual**.

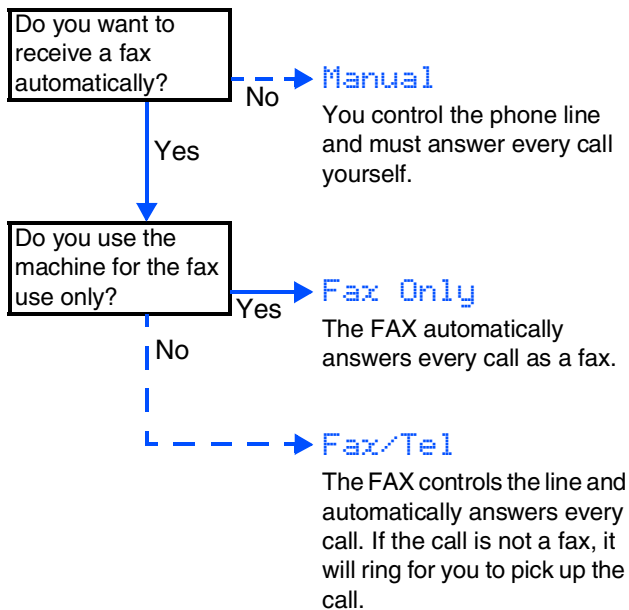

- 1 Press **Menu/Set**.
- 2 Press **0**.
- 3 Press **1**.
- 4 Press **▲** or **▼** to select the mode.
- 5 Press **Menu/Set**.
- 6 Press **Stop/Exit**.

 For more details, see “Setup Receive” in Chapter 4 of the User’s Guide.

10 Setting Up the Message Center

You must record an outgoing message in order to use the Message Center mode.

- 1 Record Message Center Outgoing Message (Msg Ctr Ogm).

 See “Recording Message Center Outgoing Message” in Chapter 7 of the User’s Guide.

- 2 Activate Message Center mode.

Press and hold  until it lights and the LCD shows:



Light



 If the Message Center Mode is ON, it overrides your Receive Mode setting. The built-in digital Message Center answers voice calls. If the call is a fax, you can receive a fax automatically. For more details, see “Message Center” in Chapter 7 of the User’s Guide.

Using the FAX as a Printer or for PC-FAX Send

You can download the Brother Printer Driver and PC-FAX Send driver from the Brother Solutions Center for use with FAX-2440C.

Visit us at:

<http://solutions.brother.com>



- *Please download the Printer Driver first before connecting the machine to your computer with the USB cable.*
- *You must use an appropriate USB 2.0 interface cable. If you don't have one, please purchase a USB 2.0 interface cable that is no longer than 2 metres.*
- *Your machine has a full speed USB 2.0 interface. This interface is compatible with Hi-Speed USB 2.0; however, the maximum data transfer rate will be 12 Mbits/s. The machine can also be connected to a computer that has a USB 1.1 interface.*

■ Replacement Consumables

Ink Cartridge

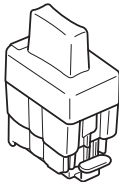
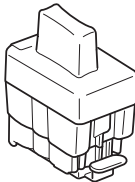
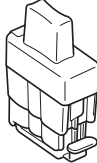
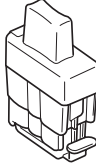
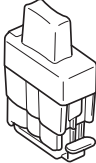
Black (Standard)	Black (High Yield)	Magenta	Yellow	Cyan
LC900BK	LC900HYBK	LC900M	LC900Y	LC900C
				

Trademarks

The Brother logo is a registered trademark of Brother Industries, Ltd.

Brother is a registered trademark of Brother Industries, Ltd.

© Copyright 2004 Brother Industries, Ltd. All rights reserved.

Each company whose software title is mentioned in this manual has a Software License Agreement specific to its proprietary programs.

All other brand and product names mentioned in this manual are registered trademarks of their respective companies.

Compilation and Publication

Under the supervision of Brother Industries Ltd., this manual has been compiled and published, covering the latest product descriptions and specifications.

The contents of this manual and the specifications of this product are subject to change without notice.

Brother reserves the right to make changes without notice in the specifications and materials contained herein and shall not be responsible for any damages (including consequential) caused by reliance on the materials presented, including but not limited to typographical and other errors relating to the publication.

This product is designed for use in a Professional Environment.

At your side.
brother®



UK
LF7336001①