

# HL-2170W

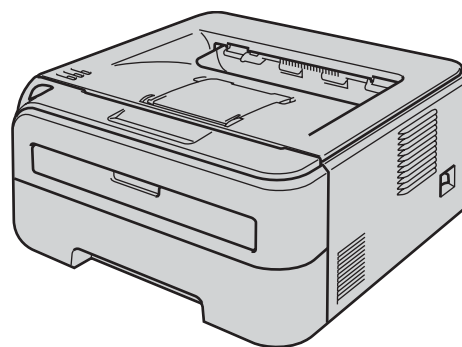

Before you can use the printer, you must set up the hardware and install the driver. Please read this 'Quick Setup Guide' for proper set up and installation instructions.

## STEP 1

Setting Up the Machine



## STEP 2

Installing the Printer Driver

**Setup is Complete!**







How to use the printer, see the User's Guide on the CD-ROM.



Keep this 'Quick Setup Guide' and the supplied CD-ROM in a convenient place for quick and easy reference at all times.



## Symbols used in this guide

 Warning	 Electrical Hazard	 Hot Surface	 Caution
Warnings tell you what to do to prevent possible personal injury.	Electrical Hazard icons alert you to a possible electrical shock.	Hot Surface icons warn you not to touch machine parts that are hot.	Cautions specify procedures you must follow or avoid to prevent possible damage to the printer or other objects.

 Improper Setup	 Note	 User's Guide Network User's Guide
Improper Setup icons alert you to devices and operations that are not compatible with the printer.	Notes tell you how you should respond to a situation that may arise or give tips about how the current operation works with other features.	Indicates reference to the User's Guide or Network User's Guide which is on the CD-ROM we have supplied.

### Trademarks

The Brother logo is a registered trademark of Brother Industries, Ltd.

Apple and Macintosh are registered trademarks and Safari is a trademark of Apple Inc.

Microsoft, MS-DOS and Windows are registered trademarks of Microsoft Corporation in the U.S. and other countries.

Microsoft, Windows, Windows Server and Windows Vista are registered trademarks of Microsoft Corporation in the United States and/or other countries.

Java and all Java-based trademarks and logos are trademarks or registered trademarks of Sun Microsystems, Inc. in the United States and other countries.

Firefox is a registered trademark of the Mozilla Foundation.

BROADCOM, SecureEasySetup and the SecureEasySetup logo are trademarks or registered trademarks of Broadcom Corporation.

AOSS is a trademark of Buffalo Inc.

Cisco is a registered trademark of Cisco Systems, Inc.

Wi-Fi, WPA and WPA2 are registered trademarks and Wi-Fi Protected Setup is a trademark of Wi-Fi Alliance.

All other terms and brand and product names mentioned in this Quick Setup Guide are registered trademarks of their respective companies.

### Compilation and Publication

This manual has been compiled and published, under the supervision of Brother Industries Ltd., covering the latest product descriptions and specifications.

The contents of this manual and the specifications of this product are subject to change without notice.

Brother reserves the right to make changes without notice in the specifications and materials contained herein and shall not be responsible for any damages (including consequential) caused by reliance on the materials presented, including but not limited to typographical and other errors relating to the publication.

This product is designed for use in a professional environment.

### Copyright and License

© 2007 Brother Industries, Ltd. © 1998-2007 TROY Group, Inc. © 1983-2007 PACIFIC SOFTWARES INC.

This product includes the "KASAGO TCP/IP" software developed by ELMIC WESCOM, INC. © 2007

Devicescape Software, Inc. This product includes RSA BSAFE Cryptographic software from RSA Security Inc.

Portions Copyright for ICC profiles 2003 by European Color Initiative, www.eci.org. ALL RIGHTS RESERVED.

Safety Precautions .....	4
To Use the Printer Safely .....	4
Regulations .....	5

## Getting Started

---

Carton Components .....	7
Control panel .....	7
Printer LED Indications .....	8
Supplied CD-ROM .....	9

## STEP 1—Setting Up the Machine

---

Installing the drum unit and toner cartridge assembly .....	10
Loading paper in the paper tray .....	11
Printing a test page .....	12

## STEP 2—Installing the Printer Driver

---

### Windows®

For USB interface cable users .....	14
For wired network interface cable users .....	15
For Peer-to-Peer network printer users .....	15
For shared network printer users .....	16
For wireless network users .....	18

### Macintosh®

For USB interface cable users .....	23
For wired network interface cable users .....	24
For wireless network users .....	26

## Repacking Information

---

Shipment of the printer .....	32
-------------------------------	----

## Troubleshooting

---



### User's Guide Chapter 6

## To Use the Printer Safely

### Warning



There are high voltage electrodes inside the printer. Before you clean the inside of the printer, make sure that you have turned off the power switch and unplugged the printer from the AC power outlet.

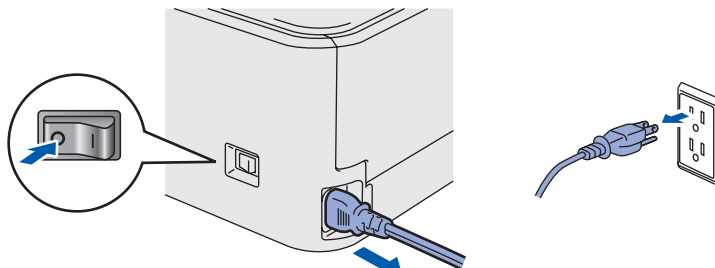

DO NOT handle the plug with wet hands. Doing this might cause an electrical shock.

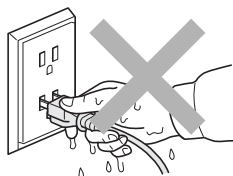

After you have just used the printer, some internal parts of the printer will be extremely hot. DO NOT touch the shaded parts shown in the illustration when you open the front or back cover of the printer.

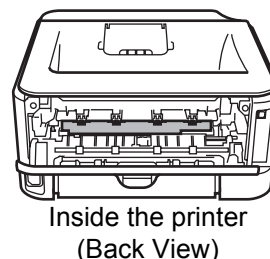
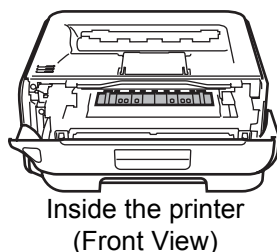

DO NOT remove or damage the caution labels located on or around the fuser.

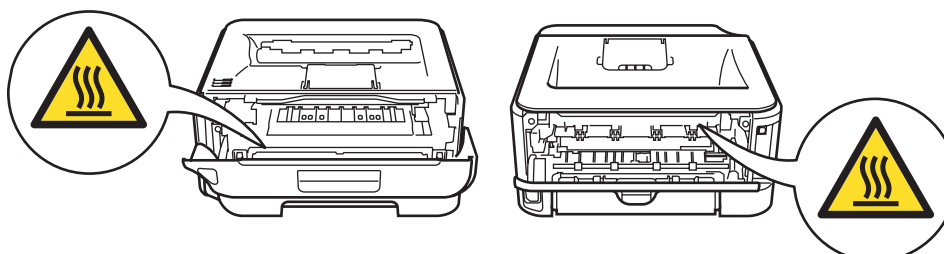

DO NOT use a vacuum cleaner to clean up scattered toner. Doing this might cause the toner dust to ignite inside the vacuum cleaner, potentially starting a fire. Please carefully clean the toner dust with a dry, lint-free cloth and dispose of it according to local regulations.



DO NOT use flammable substances or any type of spray to clean the inside or outside of the machine. Doing this may cause a fire or electrical shock. Refer to the User's Guide for how to clean the machine.



## Regulations

### Important

A shielded interface cable should be used in order to ensure compliance with the limits for a Class B digital device.

Changes or modifications not expressly approved by Brother Industries, Ltd. could void the user's authority to operate the equipment.

### Radio interference (220-240 volt model only)

This printer follows EN55022 (CISPR Publication 22)/Class B.

### EC Declaration of Conformity



#### EC Declaration of Conformity

**Manufacturer**  
Brother Industries Ltd.,  
15-1, Naeshiro-cho, Mizuho-ku, Nagoya 467-8561, Japan

**Plant**  
Brother Technology (Shenzhen) Ltd.,  
NO6 Gold Garden Ind. Nanling Buji, Longgang, Shenzhen, China

Herewith declare that:  
**Products description** : Laser Printer  
**Product Name** : HL-2170W  
**Model Number** : HL-21

is in conformity with provisions of the R & TTE Directive (1999/5/EC) and we declare compliance with the following standards :

**Harmonized standards applied :**  
**Safety** EN60950-1:2001+A11: 2004

**EMC** EN55022: 1998 +A1: 2000 +A2: 2003 Class B  
EN55024: 1998 +A1: 2001 +A2: 2003  
EN61000-3-2: 2006  
EN61000-3-3: 1995 +A1: 2001 +A2: 2005

**Radio** EN301 489-1 V1.6.1  
EN301 489-17 V1.2.1  
EN300 328 V1.6.1

**Year in which CE marking was first affixed :** 2007

**Issued by** : Brother Industries, Ltd.

**Date** : 30th September, 2007

**Place** : Nagoya, Japan

**Signature** :

Junji Shiota  
General Manager  
Quality Management Dept.  
Printing & Solutions Company

### International ENERGY STAR® Compliance Statement (110 to 120 volt Model Only)

The purpose of the International ENERGY STAR® Program is to promote the development and popularization of energy-efficient office equipment.

As an ENERGY STAR® Partner, Brother Industries, Ltd. has determined that this product meets the ENERGY STAR® guidelines for energy efficiency.



### IEC 60825-1 specification (220 to 240 volt model only)

This printer is a Class 1 laser product as defined in IEC 60825-1+A2: 2001 specifications. The label shown below is attached in countries where it is needed.



This printer has a Class 3B laser diode which produces invisible laser radiation in the laser unit. You should not open the laser unit under any circumstances.



### Caution

Use of controls or adjustments or performance of procedures other than those specified herein may result in hazardous radiation exposure.

### Internal laser radiation

Maximum radiation power:	10 mW
Wave length:	780 - 800 nm
Laser class:	Class 3B

# Safety Precautions

## **IMPORTANT - For Your Safety**

To ensure safe operation, the supplied three-pin plug must be inserted only into a standard three-pin power outlet that is properly grounded through the normal household wiring.

Extension cords used with this printer must be three-pin plug type and correctly wired to provide proper grounding. Incorrectly wired extension cords may cause personal injury and equipment damage.

The fact that the equipment operates satisfactorily does not imply that the power is grounded and that the installation is completely safe. For your safety, if in any doubt about the effective grounding of the power, call a qualified electrician.

This product should be connected to an AC power source within the range indicated on the rating label. DO NOT connect it to a DC power source. If you are not sure, contact a qualified electrician.

## **Disconnect device**

You must install this printer near a power outlet that is easily accessible. In case of an emergency, you must disconnect the power cord from the power outlet to shut off the power completely.

## **Caution for LAN connection**

Connect this product to a LAN connection that is not subjected to over voltages.

## **Warning - This printer must be earthed.**

The wires in the mains lead are coloured in line with the following code:

Green and Yellow: Earth

Blue: Neutral

Brown: Live

If in any doubt, call a qualified electrician.

## **Wi-Fi Alliance certification**

This wireless Ethernet multi-function print server is a Wi-Fi certified IEEE 802.11b/802.11g product by the Wi-Fi Alliance. For more information on the Wi-Fi Alliance and other Wi-Fi certified products, visit <http://www.wi-fi.org>.





## Carton Components

Carton components may vary from one country to another.

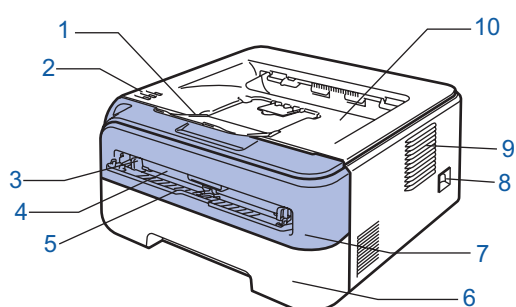
Save all packing materials and the printer carton in case for any reason you must ship your printer.

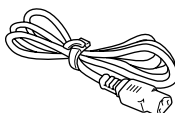

- 1 Face-down output tray support flap 1 (Support flap 1)
- 2 Control panel
- 3 Manual feed paper guide
- 4 Manual feed slot
- 5 Manual feed slot cover
- 6 Paper tray
- 7 Front cover
- 8 Power switch
- 9 Ventilation hole
- 10 Face-down output tray

 <p><b>CD-ROM</b> (including User's Guide and Network User's Guide)</p>	 <p><b>Quick Setup Guide</b></p>	 <p><b>Drum unit and toner cartridge assembly</b></p>	 <p><b>AC power cord</b></p>
--	---	---	---

The interface cable is not a standard accessory. Buy the appropriate cable for the interface you are going to use.

### ■ USB cable

- Please make sure you use a USB 2.0 interface cable that is no longer than 6 feet (2 meters).
- Your printer has a USB interface that is compatible with the USB 2.0 specification. This interface is also compatible with Hi-Speed USB 2.0; however, maximum data transfer rate will be 12 Mb/s. The printer can also be connected to a computer that has a USB 1.1 interface.
- DO NOT connect the interface cable at this time. Connecting the interface cable is done during the printer driver installation process.
- When you use a USB cable, make sure you connect it to the USB port of your computer and not to a USB port on a keyboard or non-powered USB hub.

### ■ Network cable

Use a straight-through Category5 (or greater) twisted-pair cable for 10BASE-T or 100BASE-TX Fast Ethernet Network.

## Control panel

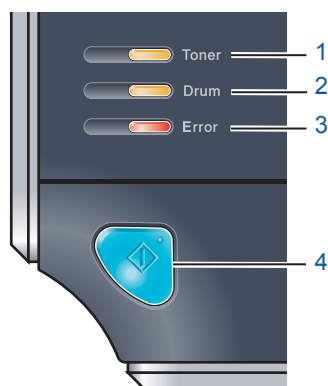

- 1 **Toner LED**  
The Toner LED indicates when the toner is low or at the end of its life.
- 2 **Drum LED**  
The Drum LED indicates when the drum is nearing the end of its life.
- 3 **Error LED**  
The Error LED indicates when the printer is in one of the following states:  
No paper / Paper jam / Cover open
- 4 **Ready LED**  
The Ready LED will flash depending on the printer status.  
**Go button**  
Wake-up / Error recovery / Form feed / Job Cancel / Reprint / Enable or Disable the wireless network



For the details of the control panel, see Chapter 4 of the User's Guide on the CD-ROM.

## Printer LED Indications



: Blinking



: ON



: OFF

Printer LED	OFF	Sleep	Warming up Cooling down <sup>1</sup>	Ready	Receiving data <sup>2</sup>	Print Data remaining <sup>2</sup>
Toner						
Drum						
Error						
Ready (Blue)						

Printer LED	Toner low <sup>3</sup>	Toner life end	Drum near end of life <sup>3</sup>	Cover open Paper jam <sup>2</sup>	No paper	Drum Error <sup>2</sup>	Service call <sup>2</sup>
Toner (Yellow)							
Drum (Yellow)							
Error (Red)							
Ready (Blue)							
 User's Guide	Chapter 5	Chapter 5	Chapter 5	Chapter 6	Chapter 6	Chapter 4	Chapter 4

<sup>1</sup> The LED will blink in a pattern of ON for 1 second and then OFF for 1 second.

<sup>2</sup> The LED will blink in a pattern of ON for 0.5 seconds and then OFF for 0.5 seconds.

<sup>3</sup> The yellow LED will blink in a pattern of ON for 2 seconds and then OFF for 3 seconds.

### LED indications when using the one-push wireless setting mode

Printer LED	Searching or accessing the access point <sup>1</sup>	Connecting and downloading settings from the access point <sup>1</sup>	Connection succeeded <sup>2</sup>	Connection failed <sup>3</sup>	Session overlap is detected <sup>4</sup>		
Toner (Yellow)							
Drum (Yellow)							
Error (Red)							
Ready (Blue)							

<sup>1</sup> The LED will blink (turn on for 0.2 seconds and off for 0.1 second).

<sup>2</sup> The LED will turn on for 5 minutes.

<sup>3</sup> The LED will blink (turn on for 0.1 second and off for 0.1 second) for 30 seconds.

<sup>4</sup> The LED will flash 10 times and then turn OFF for half a second. This pattern will repeat 20 times.



## Supplied CD-ROM

You can find a variety of information on the CD-ROM.

### Windows®

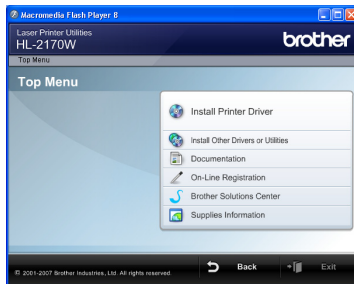

 **Install Printer Driver**  
Install the printer driver.

 **Install Other Drivers or Utilities**  
Install optional drivers, utilities and Network management tools.

 **Documentation**  
View the Printer User's Guide and Network User's Guide in HTML format.  
You can also view the manuals in PDF format by accessing the Brother Solutions Center.  
The User's Guide and Network User's Guide in HTML format will be installed automatically when you install the driver. Click the **Start** button, **All Programs**<sup>1</sup>, your printer, and then **User's Guide in HTML format**. If you do not want to install the User's Guide, choose **Custom setup** from **Install Printer Driver**, and uncheck **User's Guides in HTML format** when you install the driver.

<sup>1</sup> **Programs** for Windows® 2000 users

 **On-Line Registration**  
Register your product on-line.

 **Brother Solutions Center**  
The Brother Solutions Center (<http://solutions.brother.com>) is a one-stop resource for all your printer support needs. Download the latest drivers and utilities for your printers, read FAQs and troubleshooting tips, or learn about printer solutions.

 **Supplies Information**  
Visit our web site for original/genuine Brother supplies at <http://www.brother.com/original/>

### Note

*For visually impaired users, we have prepared an HTML file on the supplied CD-ROM: readme.html. This file can be read by Screen Reader 'text-to-speech' software.*

### Macintosh®



 **Install Printer Driver**  
Install the printer driver.

 **Documentation**  
View the Printer User's Guide in HTML format.  
You can also view the User's Guide in PDF format by accessing the Brother Solutions Center.

 **On-Line Registration**  
Register your product on-line.

 **Brother Solutions Center**  
The Brother Solutions Center (<http://solutions.brother.com>) is a one-stop resource for all your printer support needs. Download the latest drivers and utilities for your printers, read FAQs and troubleshooting tips, or learn about printer solutions.

 **Supplies Information**  
Visit our web site for original/genuine Brother supplies at <http://www.brother.com/original/>

# STEP 1 Setting Up the Machine

## 1 Installing the drum unit and toner cartridge assembly

### ⊘ Improper Setup

**DO NOT** connect the interface cable.  
Connecting the interface cable is done when installing the driver.

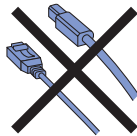

### 1 Open the front cover.

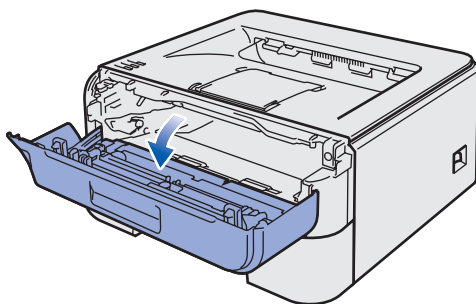

### 2 Unpack the drum unit and toner cartridge assembly.

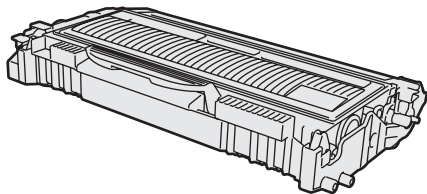

### 3 Rock it from side to side several times to distribute the toner evenly inside the assembly.

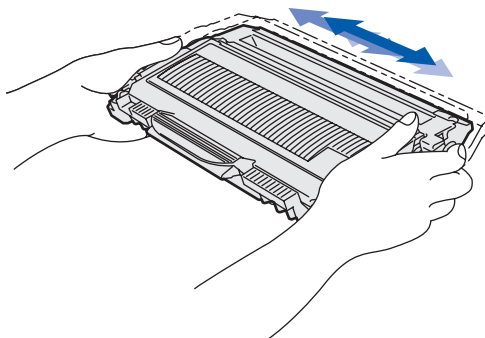

### 4 Put the drum unit and toner cartridge assembly into the printer.

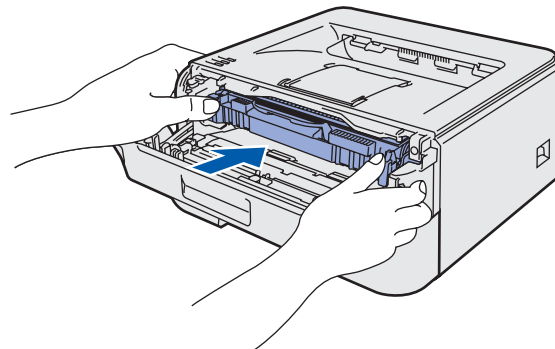
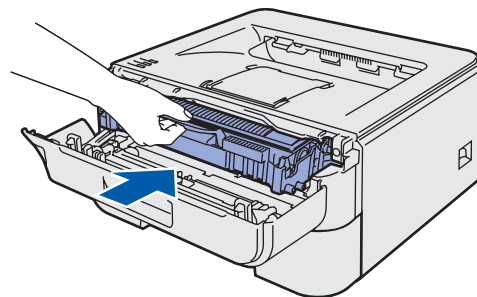

### 5 Close the front cover of the printer.

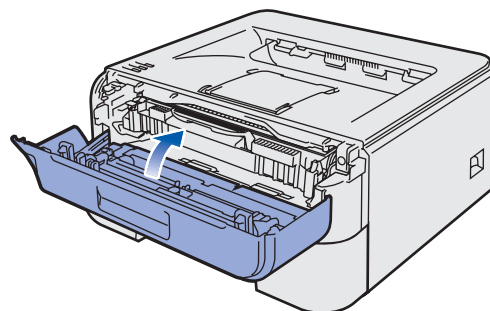

## 2 Loading paper in the paper tray

- 1** Pull the paper tray completely out of the printer.

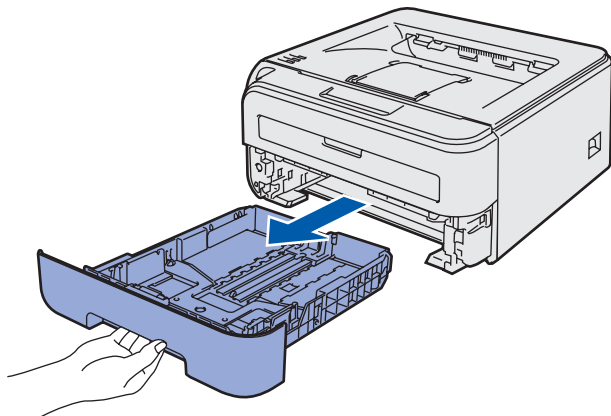

- 2** While pressing the green paper-guide release lever, slide the paper guides to fit the paper size you are using. Make sure that the guides are firmly in the slots.

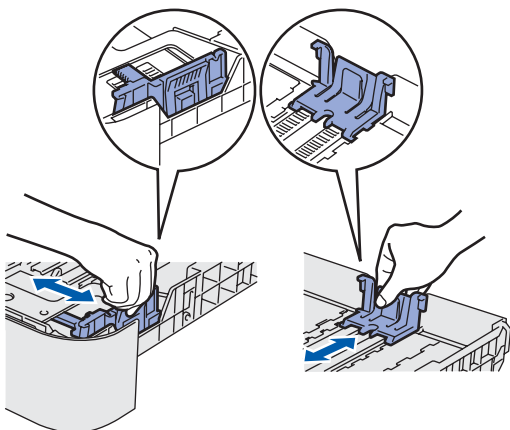

- 3** Fan the stack of paper well to avoid paper jams and misfeeds.

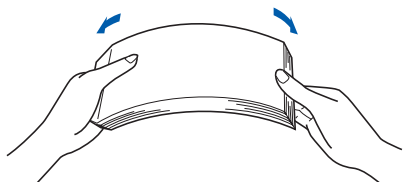

- 4** Put paper in the paper tray. Make sure that the paper is flat in the tray and below the maximum paper mark (1).

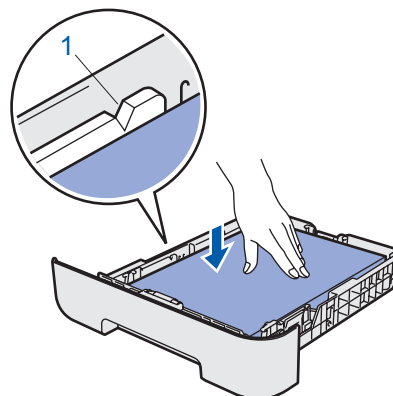

- 5** Put the paper tray firmly back into the printer. Make sure that it is completely inserted into the printer.

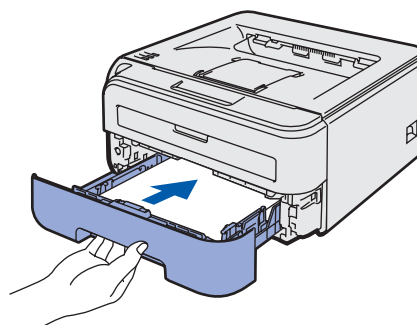

## 3 Printing a test page

### ⊘ Improper Setup

DO NOT connect the interface cable yet.

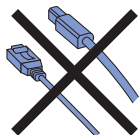

- 1 Make sure that the printer power switch is off. Connect the AC power cord to the printer.

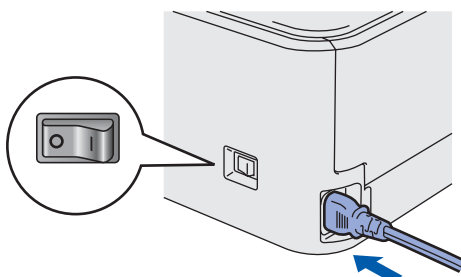

- 2 Plug the AC power cord into an AC power outlet. Turn on the printer power switch.

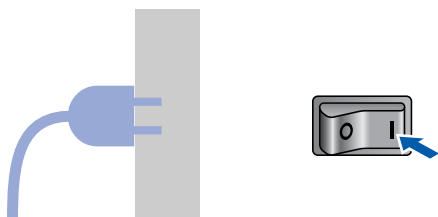

- 3 Unfold support flap 1.

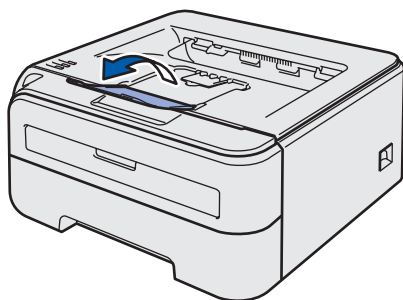

- 4 After the printer has finished warming up, the **Ready LED / Go button** (1) stops blinking and stays blue.

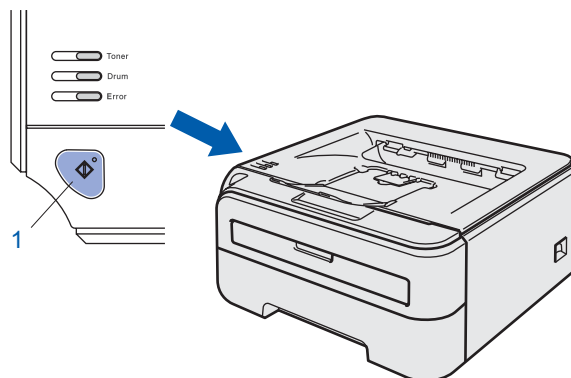

- 5 Press the **Go** button. The printer prints a test page. Check that the test page has printed correctly.

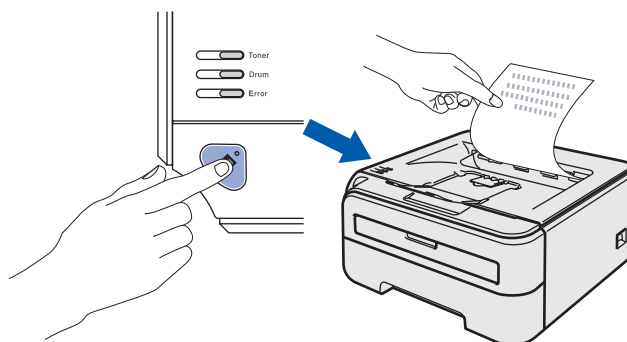

### Note

*This function will not be available after the first print job you send from your computer.*

## STEP 2 Installing the Printer Driver

Follow the instructions on this page for your operating system and interface.  
For the latest drivers, documentation, and to find the best solution for your problem, access the Brother Solutions Center directly from the CD-ROM / Driver or visit <http://solutions.brother.com>.

### Windows®



For USB interface cable users ..... 14



For wired network interface cable users ..... 15

- For Peer-to-Peer network printer users ..... 15
- For shared network printer users ..... 16



For wireless network users ..... 18

### Macintosh®



For USB interface cable users ..... 23



For wired network interface cable users ..... 24



For wireless network users ..... 26

## For USB interface cable users

Windows®  
USB**Improper Setup**

DO NOT connect the interface cable yet.

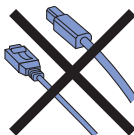
**Note**

If the **Found New Hardware Wizard** appears on your computer, click **Cancel**.



## Installing the driver and connecting the printer to your computer

- 1 Turn off the printer power switch.



- 2 Make sure the USB interface cable is **NOT** connected to the printer, and then begin installing the driver. If you have already connected the cable, remove it.

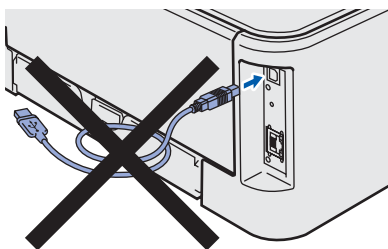

- 3 Turn on your computer. (You must be logged on with Administrator rights.)
- 4 Put the supplied CD-ROM into your CD-ROM drive. The opening screen will appear automatically. Choose your printer model and the language.

**Note**

If the opening screen does not appear, use Windows® Explorer to run the **start.exe** program from the root folder of the Brother CD-ROM.

- 5 Click **Install Printer Driver** on the menu screen.



- 6 Click **USB cable users**.

**Note**

For Windows Vista®, when the **User Account Control** screen appears, click **Continue**.

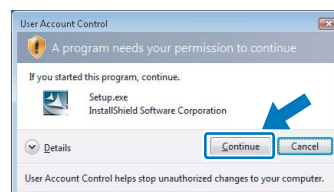

- 7 When the **License Agreement** window appears, click **Yes** if you agree to the License Agreement.
- 8 When this screen appears, make sure the printer power switch is on. Connect the USB interface cable to your computer, and then connect it to the printer. Click **Next**.

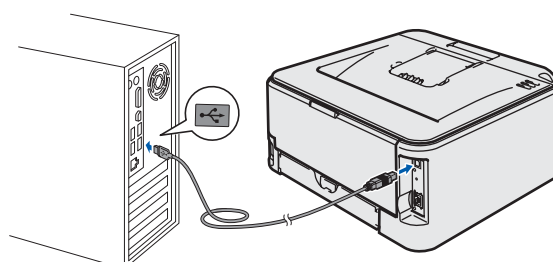
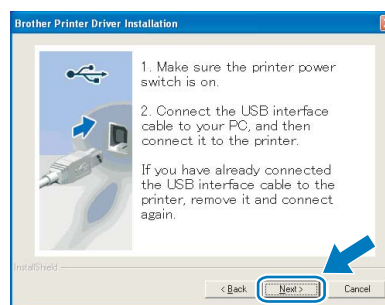



**9** Click **Finish**.

## Note

- If you want to register your product on-line, check **On-Line Registration**.
- If you do not want to set your printer as Default printer, uncheck **Set as Default Printer**.

## Note

### XML Paper Specification Printer Driver

The XML Paper Specification Printer Driver is the most suitable driver when printing from the applications that use the XML Paper Specification documents. Please download the latest driver by accessing the Brother Solutions Center at <http://solutions.brother.com>.

## For wired network interface cable users

## For Peer-to-Peer network printer users

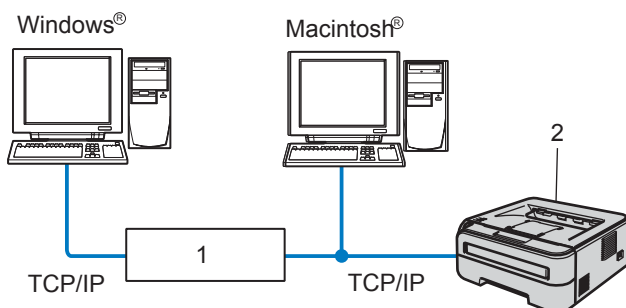

- 1 Router  
2 Network printer

## Note

- If you are going to connect the printer to your network, we recommend that you contact your system administrator prior to installation or see the Network User's Guide on the CD-ROM.
- If you are using Personal Firewall software (e.g. Windows Firewall), disable it. Once you are sure that you can print, restart your Personal Firewall software.

## Connecting the printer to your network and installing the driver

- 1** Connect the network interface cable to the printer, and then connect it to a free port on your hub.

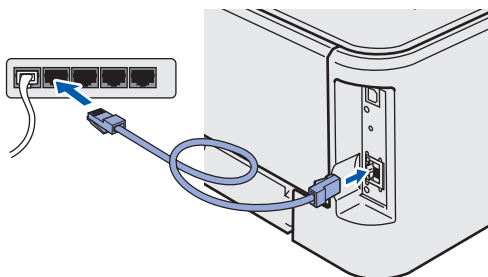

- 2** Make sure the printer power switch is on.



- 3** Turn on your computer. (You must be logged on with Administrator rights.)

- 4** Put the supplied CD-ROM into your CD-ROM drive. The opening screen will appear automatically. Choose your printer model and the language.

## Note

If the opening screen does not appear, use Windows® Explorer to run the **start.exe** program from the root folder of the Brother CD-ROM.

- 5** Click **Install Printer Driver** on the menu screen.

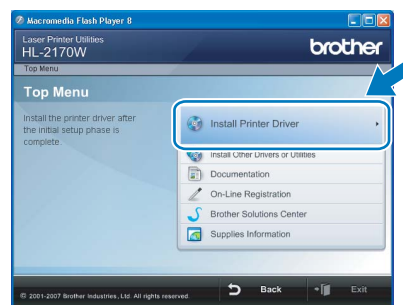

- 6** Click **Network cable users**.

## Note

For Windows Vista®, when the **User Account Control** screen appears, click **Continue**.

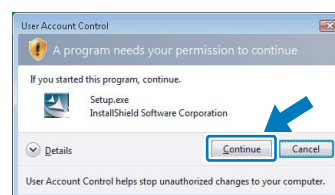

- 7** When the **License Agreement** window appears, click **Yes** if you agree to the License Agreement.

- 8** Choose **Brother Peer-to-Peer Network Printer**, and then click **Next**.

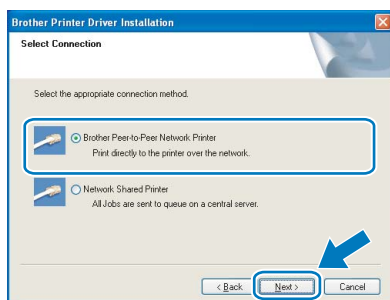

- 9** Choose **Search the network for devices and choose from a list of discovered devices (Recommended)**. Or enter your printer's IP address or its node name. Click **Next**.

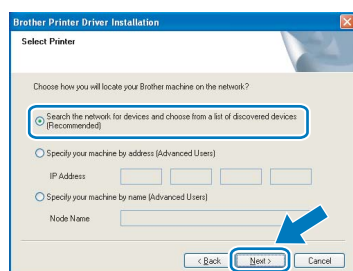
**Note**

You can find your printer's IP address and the node name by printing out the *Printer Settings Page*.

- 10** Choose your printer, and then click **Next**.

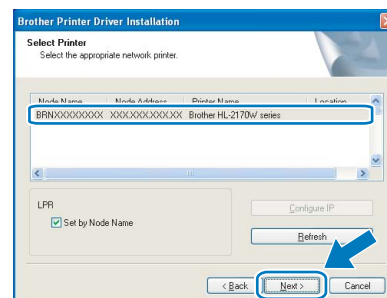

- 11** Click **Finish**.

**Note**

- If you want to register your product on-line, check **On-Line Registration**.
- If you do not want to set your printer as Default printer, uncheck **Set as Default Printer**.



**Setup is now complete.**

**Note****XML Paper Specification Printer Driver**

The XML Paper Specification Printer Driver is the most suitable driver when printing from the applications that use the XML Paper Specification documents. Please download the latest driver by accessing the Brother Solutions Center at <http://solutions.brother.com>.

## For shared network printer users

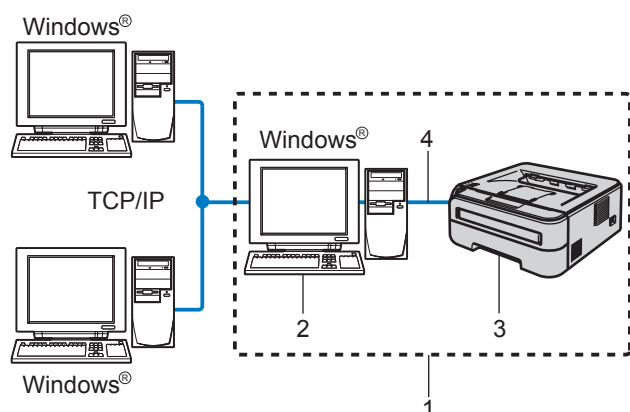

- 1 Network Shared
- 2 Also known as "Server" or "Printer server"
- 3 Printer
- 4 TCP/IP or USB

**Note**

If you are going to connect to a shared printer on your network, we recommend that you ask your system administrator about the queue or share name for the printer prior to installation.

### Installing the driver and choosing the correct printer queue or share name

- 1** Turn on your computer. (You must be logged on with Administrator rights.)
- 2** Put the supplied CD-ROM into your CD-ROM drive. The opening screen will appear automatically. Choose your printer model and the language.

**Note**

If the opening screen does not appear, use Windows® Explorer to run the **start.exe** program from the root folder of the Brother CD-ROM.



- 3** Click **Install Printer Driver** on the menu screen.

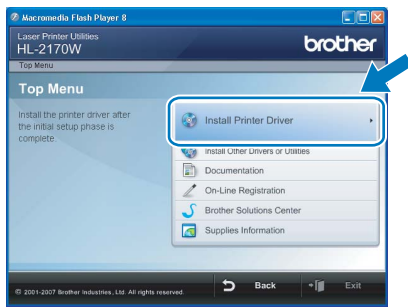

- 4** Click **Network cable users**.



For Windows Vista®, when the **User Account Control** screen appears, click **Continue**.

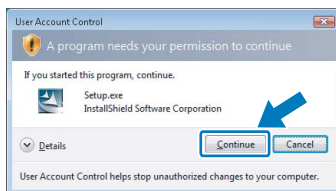

- 5** When the **License Agreement** window appears, click **Yes** if you agree to the License Agreement.

- 6** Choose **Network Shared Printer**, and then click **Next**.

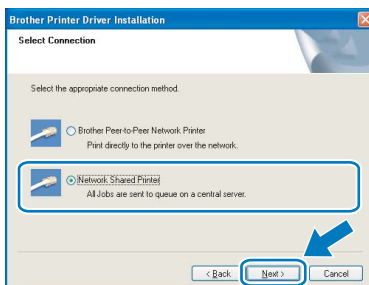

- 7** Choose your printer's queue, and then click **OK**.

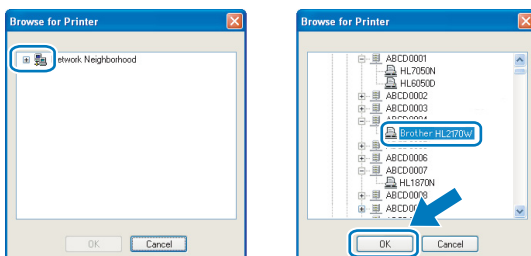

Contact your administrator if you do not know the location or the name of the printer in the network.

- 8** Click **Finish**.



- If you want to register your product on-line, check **On-Line Registration**.
- If you do not want to set your printer as Default printer, uncheck **Set as Default Printer**.



Setup is now complete.



**XML Paper Specification Printer Driver**  
The XML Paper Specification Printer Driver is the most suitable driver when printing from the applications that use the XML Paper Specification documents. Please download the latest driver by accessing the Brother Solutions Center at <http://solutions.brother.com>.

## For wireless network users

### Connecting your wireless printer and wireless network together and installing the printer driver in infrastructure mode

First you must configure the wireless network settings of your printer to communicate with your network access point (router). After the printer is configured to communicate with your access point (router) computers on your network will have access to the printer. To use the printer from these computers, you will need to install the printer driver. The following steps will guide you through the configuration and installation process.

To achieve optimum results with normal everyday document printing, place the Brother printer as close to the network access point (router) as possible with minimal obstructions. Large objects and walls between the two devices as well as interference from other electronic devices can affect the data transfer speed of your documents.

Due to these factors, wireless may not be the best method of connection for all types of documents and applications. If you are printing large files, such as multi-page documents with mixed text and large graphics, you may want to consider choosing wired Ethernet for a faster data transfer or USB for the fastest throughput speed.

Although Brother HL-2170W can be used in a both wired and wireless network, only one of the connection methods can be used at a time.

#### Important

**The following instruction will offer the method for installing your Brother machine in a wireless network environment. This method is for infrastructure mode, using a wireless router or access point that uses DHCP to assign IP addresses. Choose your setup method from the next page and follow the instructions. To set up your machine in any other wireless environment you can find instructions in the Network User's Guide on the CD-ROM.**

You can view the Network User's Guide by following the instructions below.

- 1 Turn on your computer. Insert the Brother CD-ROM into your CD-ROM drive.
- 2 Choose your printer model and the language. The CD-ROM main menu will appear.
- 3 Click the **Documentation**, and then click **HTML documents**.

#### Note

- If you are going to connect the printer to your network, we recommend that you contact your system administrator prior to installation. You must know your wireless network settings before you proceed with this installation.
- If you are using Personal Firewall software (e.g. Windows Firewall), disable it. Once you are sure that you can print, restart your Personal Firewall software.

#### Infrastructure Mode

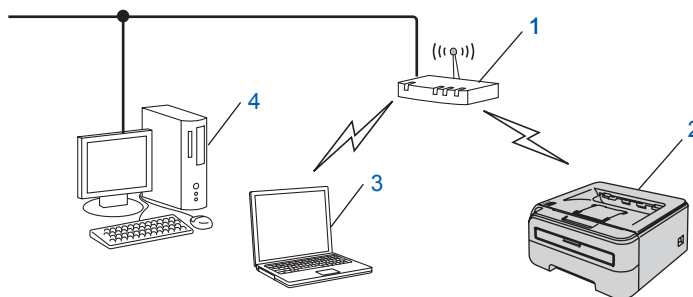

- 1 Access Point
- 2 Wireless Network printer (your machine)
- 3 Wireless capable computer connected to the access point
- 4 Wired computer connected to the access point

## Confirm your wireless network setup method

The setup process will be different depending on your network environment.

### ■ Configuration using the Brother installer application on the CD-ROM to configure your wireless network printer (Recommended)

- Configuration temporarily using a network cable

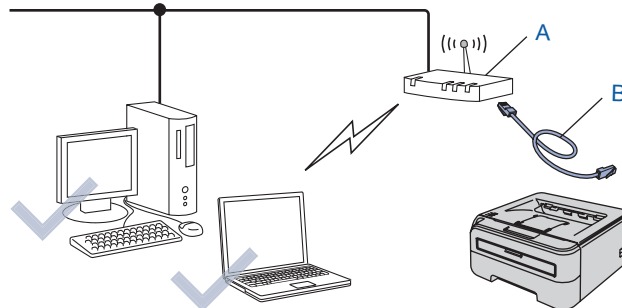

If there is an Ethernet Hub or Router in the same network as the wireless access point (A) of your printer, you can temporarily connect the Hub or Router to the printer using an Ethernet cable (B), this is an easy way to configure the printer. You can then remotely configure the printer from a computer on the network.

For instructions, go to *Configuration in Infrastructure mode, using a network cable temporarily* on page 20.

### ■ Configuration using the one-push wireless setting mode

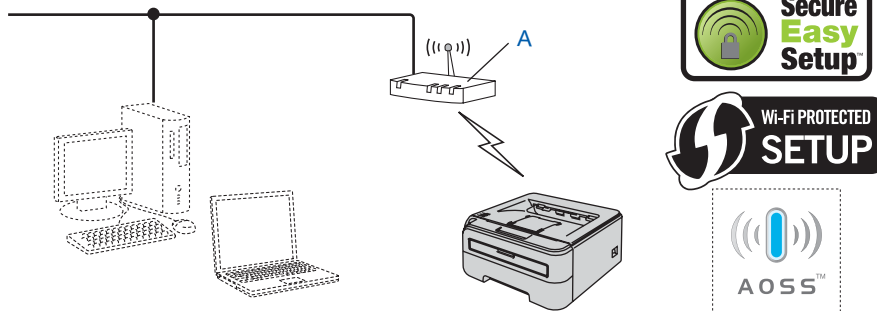

If your wireless access point (A) supports either SecureEasySetup™, Wi-Fi Protected Setup™ (PBC <sup>1</sup>) or AOSS™, you do not need to use a computer to configure the wireless settings. The access point (router) and your printer can automatically negotiate using the SecureEasySetup™, Wi-Fi Protected Setup™ or AOSS™ procedure.

<sup>1</sup> Push Button Configuration

For instructions, see Chapter 6 in the Network User's Guide on the CD-ROM.

### ■ Configuration using the PIN Method of Wi-Fi Protected Setup™

If your wireless access point (A) supports Wi-Fi Protected Setup™, you can also configure using the PIN Method of Wi-Fi Protected Setup™.

For instructions, see Chapter 7 in the Network User's Guide on the CD-ROM.

## Configuration in Infrastructure mode, using a network cable temporarily

Before configuring the wireless settings

### Important

- If you have previously configured the wireless settings of the printer, you must reset the print server back to the default factory settings. (See Chapter 11 in the Network User's Guide on the CD-ROM)
- You must know your wireless network settings before you proceed with this installation.
- You need to temporarily use an Ethernet cable during configuration.

Configure the wireless settings

- 1 Make sure the printer power switch is on.  

- 2 Turn on your computer. (You must be logged on with Administrator rights.)
- 3 Put the supplied CD-ROM into your CD-ROM drive. The opening screen will appear automatically. Choose your printer model and the language.

### Note

If the opening screen does not appear, use Windows® Explorer to run the **start.exe** program from the root folder of the Brother CD-ROM.

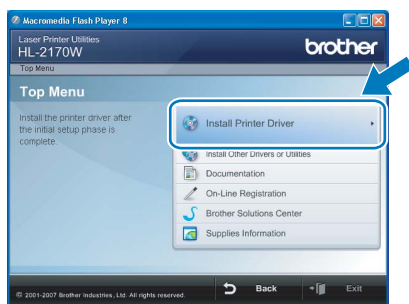
- 4 Click **Install Printer Driver** on the menu screen.



- 5 Click **Wireless Network users**.



### Note

For Windows Vista®, when the **User Account Control** screen appears, click **Allow**.

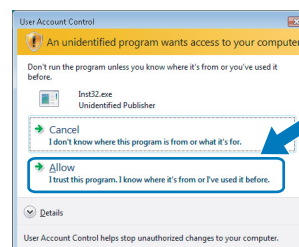

- 6 Choose **Wireless Setup and Driver Install (Recommended)**, and then click **Next**.

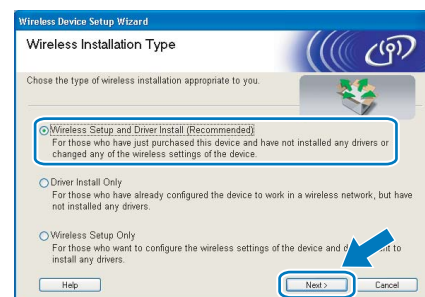

- 7 Choose **Step by Step install (Recommended)** and then click **Next**.

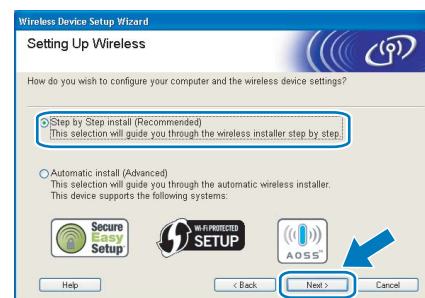

- 8 Choose **With cable (Recommended)** and then click **Next**.

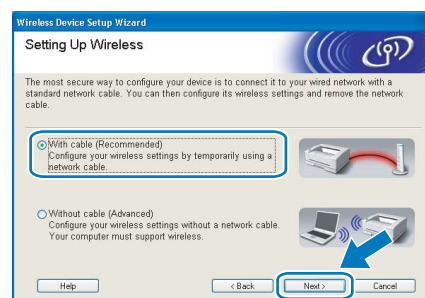

- 9** For configuration, you must temporarily connect your Brother wireless device (your printer) directly to a free port on your access point, hub or router using a network cable. When the following screen appears, insert the network cable to the access point and then to the printer. Click **Next**.



- 10** Choose the printer you wish to configure, and click **Next**. If the list is blank, check if the access point and the printer are powered on, and then click **Refresh**.



## Note

The default Node name is "BRNxxxxxxxxxxxx".

- 11** The wizard will search for wireless networks available from your printer. Choose the access point you wish to associate the printer with, and then click **Next**.

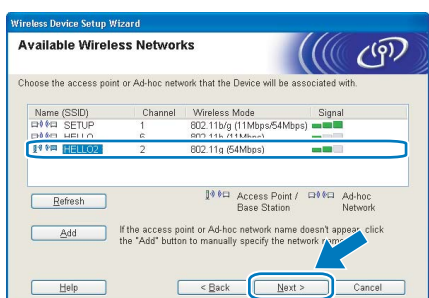

## Note

- "SETUP" is the default SSID of the printer. Do not choose this SSID.
- If the list is blank, check that the access point has power and is broadcasting the SSID, and then see if the printer and the access point are within range for wireless communication. Then, click **Refresh**.

- If your access point is set to not broadcast the SSID you can manually add it by clicking the **Add** button. Follow the on-screen instructions for entering the **Name (SSID)**, and then click **Next**.

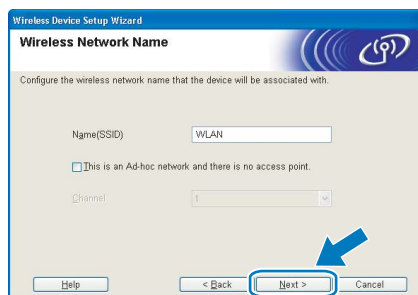

- 12** If your network is not configured for Authentication and Encryption, the following screen will appear. To continue configuration, click **OK**.



- 13** If your network is configured for Authentication and Encryption, the following screen will appear. When configuring your Brother wireless printer, you must ensure that it is configured to match the Authentication and Encryption settings of your existing wireless network. Choose the **Authentication Method** and **Encryption Mode** from the pull-downs in each setting box. Then enter the **Network key** and **Confirm Network Key**, and then click **Next**.

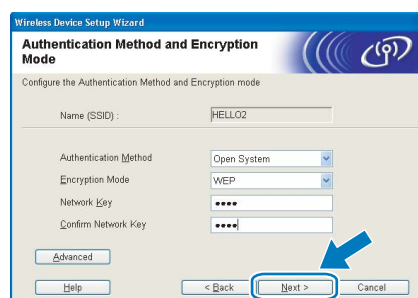

## Note

- If you want to setup more than WEP key1, click **Advanced**.
- If you do not know the Authentication or Encryption settings for your network, contact your network administrator.
- If the **Authentication Method** is set to **Open System** and the **Encryption Mode** is set to **WEP**, an error indication will NOT appear if the **Network key** is incorrect.



- 14** Click **Next**. The settings will be sent to your printer. The settings will remain unchanged if you click **Cancel**.

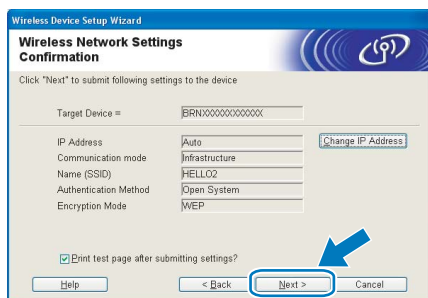

### Note

If you want to manually enter the IP address settings of your printer, click **Change IP Address** and enter the necessary IP address settings for your network.

- 15** Disconnect the network cable between your access point (hub or router) and the printer, and click **Next**.



### Installing the printer driver

### Improper Setup

- DO NOT try to cancel any of the screens during this installation.
- If your wireless settings fail, an error message will appear during the installation of the printer driver and the installation will be terminated. If you encounter this failure, please go back to step 4 and setup the wireless connection again.

- 1** When the **License Agreement** window appears, click **Yes** if you agree to the License Agreement.
- 2** Choose **Standard Installation**, and then click **Next**.

- 3** Choose **Search the network for devices and choose from a list of discovered devices (Recommended)**. Or enter your printer's IP address or its node name. Click **Next**.

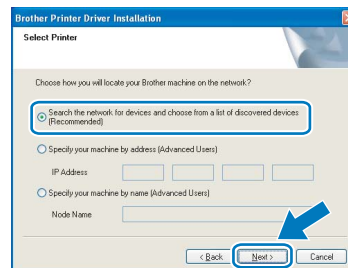

### Note

You can find your printer's IP address and the node name by printing out the **Printer Settings Page**.

- 4** Choose your printer, and then click **Next**.

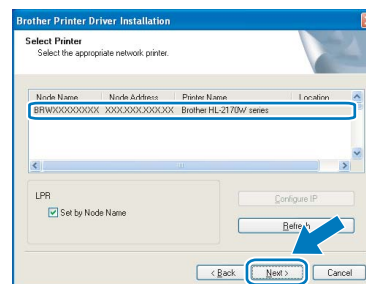

### Note

If your printer takes a long time to appear on the list, 1 minute or more, then click **Refresh**. If your printer still fails to appear, reset the print server back to the default factory settings and go back to step 4 and try the wireless setup again.

- 5** Click **Finish**.

### Note

- If you want to register your product on-line, check **On-Line Registration**.
- If you do not want to set your printer as Default printer, uncheck **Set as Default Printer**.
- Turn your Personal Firewall back on.



**Setup is now complete.**

### Note

**XML Paper Specification Printer Driver**  
The XML Paper Specification Printer Driver is the most suitable driver when printing from the applications that use the XML Paper Specification documents. Please download the latest driver by accessing the Brother Solutions Center at <http://solutions.brother.com>.

## For USB interface cable users

### Connecting the printer to your Macintosh® and installing the driver

- 1 Connect the USB interface cable to your Macintosh®, and then connect it to the printer.

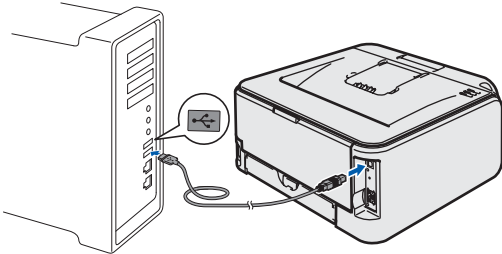

### ⚠ Improper Setup

**DO NOT** connect the printer to a USB port on a keyboard or a non-powered USB hub.

- 2 Make sure the printer power switch is on.



- 3 Turn on your Macintosh®. Put the supplied CD-ROM into your CD-ROM drive.
- 4 Double-click the **HL2100** icon on your desktop. Double-click the **Start Here** icon. Follow the on-screen instructions.

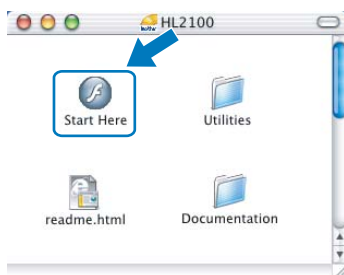

- 5 Click **Install Printer Driver** on the menu screen.



- 6 Click **USB cable users** and follow the on-screen instructions. Then, restart your Macintosh®.

**For Mac OS® X 10.2.4 to 10.2.8 users:**

Go to step 9.

**For Mac OS® X 10.3 or greater users:**  
Go to step 7.

- 7 The Brother software will search for the Brother printer. During this time the following screen will appear.

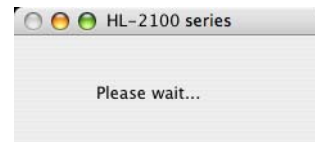

- 8 When this screen appears, click **OK**.

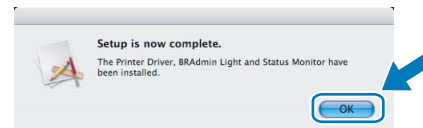

- 9 **OK!** **For Mac OS® X 10.3 or greater users:**  
**Setup is now complete.**

- 9 When this screen appears, click **Add**.

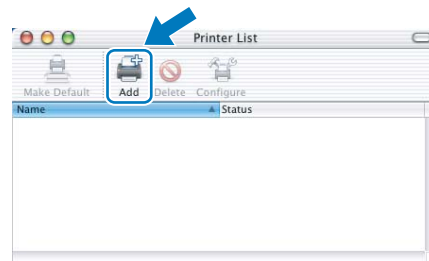

- 10 Choose **USB**.

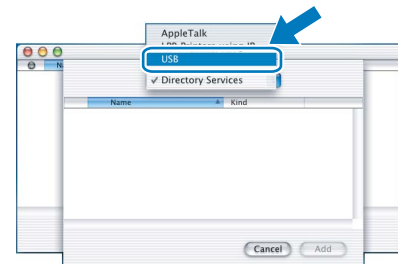

- 11 Choose your printer, and then click **Add**.

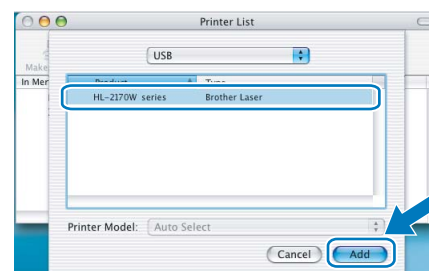

- 12** Click **Print Center**, then **Quit Print Center**.

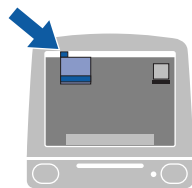

For Mac OS® X 10.2.4 to 10.2.8 users:  
Setup is now complete.

## For wired network interface cable users

Connecting the printer to your Macintosh® and installing the driver

- 1** Connect the network interface cable to the printer, and then connect it to a free port on your hub.

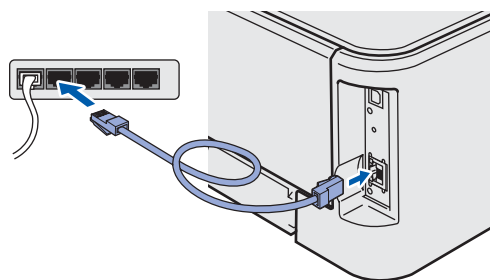

- 2** Make sure the printer power switch is on.



- 3** Turn on your Macintosh®. Put the supplied CD-ROM into your CD-ROM drive.

- 4** Double-click the **HL2100** icon on your desktop. Double-click the **Start Here** icon. Follow the on-screen instructions.

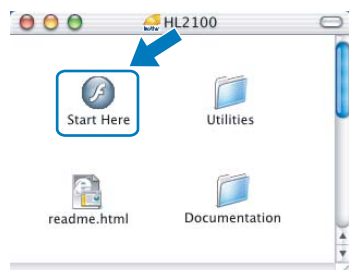

- 5** Click **Install Printer Driver** on the menu screen.

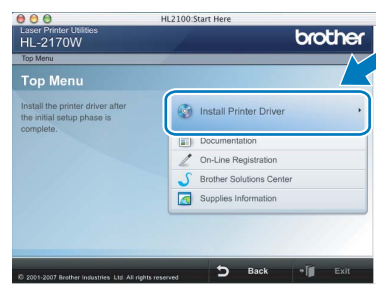

- 6** Click **Network cable users** and follow the on-screen instructions. Then, restart your Macintosh®.

For Mac OS® X 10.2.4 to 10.2.8 users:  
Go to step **9**.

For Mac OS® X 10.3 or greater users:  
Go to step **7**.

- 7** The Brother software will search for the Brother printer. During this time the following screen will appear.







## Note

If more than one printer is available, the following list appears. Choose the printer you wish to connect, and then click **OK**.

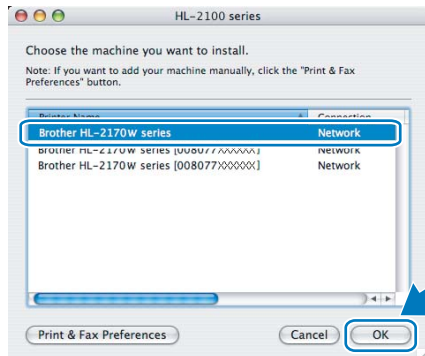

- If there is more than one of the same printer model connected on your network, the Ethernet address (MAC address) will be displayed after the model name.
- You can find your printer's Ethernet address (MAC address) by printing out the Printer Settings Page.

**8** When this screen appears, click **OK**.

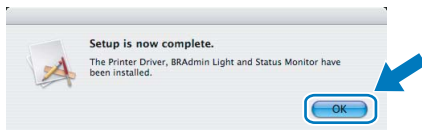

**For Mac OS® X 10.3 or greater users:**  
Setup is now complete.

**9** When this screen appears, click **Add**.

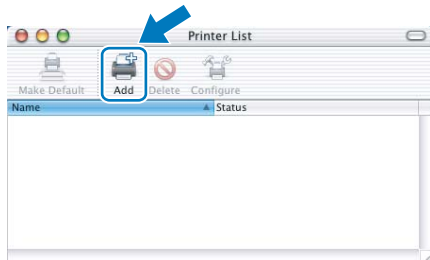

**10** Make the following selection.

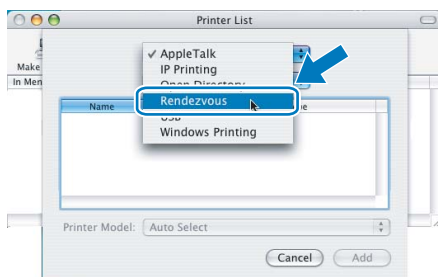

**11** Choose your printer, and then click **Add**.

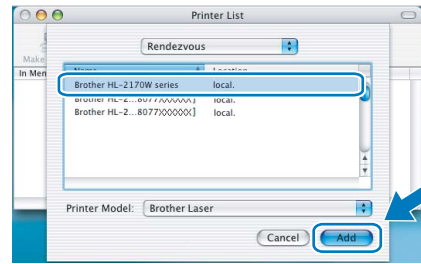

## Note

- If there is more than one of the same printer model connected on your network, the Ethernet address (MAC address) will be displayed after the model name.
- You can find your printer's Ethernet address (MAC address) by printing out the Printer Settings Page.

**12** Click **Print Center**, then **Quit Print Center**.

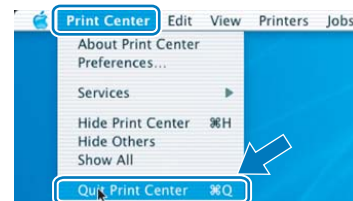
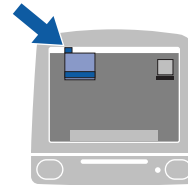

**For Mac OS® X 10.2.4 to 10.2.8 users:**  
Setup is now complete.

## For wireless network users

### Connecting your wireless printer and wireless network together and installing the printer driver in infrastructure mode

First you must configure the wireless network settings of your printer to communicate with your network access point (router). After the printer is configured to communicate with your access point (router) computers on your network will have access to the printer. To use the printer from these computers, you will need to install the printer driver. The following steps will guide you through the configuration and installation process.

To achieve optimum results with normal everyday document printing, place the Brother printer as close to the network access point (router) as possible with minimal obstructions. Large objects and walls between the two devices as well as interference from other electronic devices can affect the data transfer speed of your documents.

Due to these factors, wireless may not be the best method of connection for all types of documents and applications. If you are printing large files, such as multi-page documents with mixed text and large graphics, you may want to consider choosing wired Ethernet for a faster data transfer or USB for the fastest throughput speed.

Although Brother HL-2170W can be used in a both wired and wireless network, only one of the connection methods can be used at a time.

#### Important

**The following instruction will offer the method for installing your Brother machine in a wireless network environment. This method is for infrastructure mode, using a wireless router or access point that uses DHCP to assign IP addresses. Choose your setup method from the next page and follow the instructions. To set up your machine in any other wireless environment you can find instructions in the Network User's Guide on the CD-ROM.**

You can view the Network User's Guide by following the instructions below.

- 1 Turn on your computer. Insert the Brother CD-ROM into your CD-ROM drive.
- 2 Double-click the **HL2100** icon on your desktop. Double-click the **Start Here** icon.
- 3 Choose your printer model and the language. The CD-ROM main menu will appear.
- 4 Click the **Documentation**, and then click **HTML documents**.



#### Note

- If you are going to connect the printer to your network, we recommend that you contact your system administrator prior to installation. You must know your wireless network settings before you proceed with this installation.
- If you are using Personal Firewall software, disable it. Once you are sure that you can print, restart your Personal Firewall software.

#### Infrastructure Mode

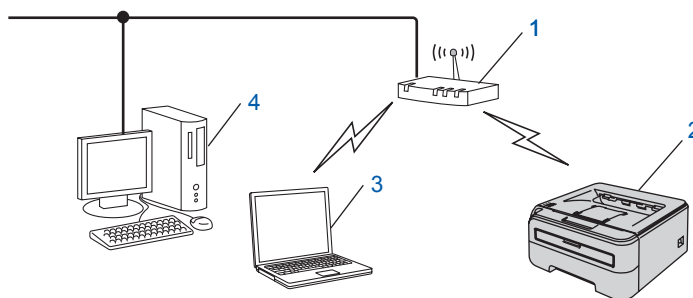

- 1 Access Point
- 2 Wireless Network printer (your machine)
- 3 Wireless capable computer connected to the access point
- 4 Wired computer connected to the access point

## Confirm your wireless network setup method

The setup process will be different depending on your network environment.

### ■ Configuration using the Brother installer application on the CD-ROM to configure your wireless network printer (Recommended)

- Configuration temporarily using a network cable

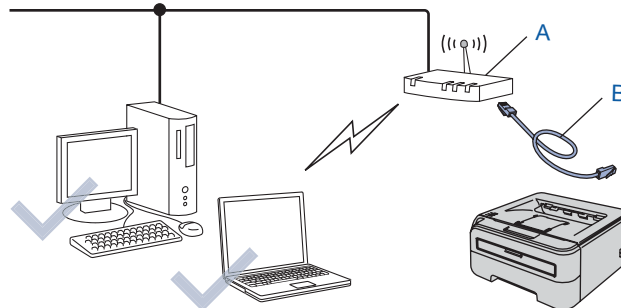

If there is an Ethernet Hub or Router in the same network as the wireless access point (A) of your printer, you can temporarily connect the Hub or Router to the printer using an Ethernet cable (B), this is an easy way to configure the printer. You can then remotely configure the printer from a computer on the network.

For instructions, go to *Configuration in Infrastructure mode, using a network cable temporarily* on page 28.

### ■ Configuration using the one-push wireless setting mode

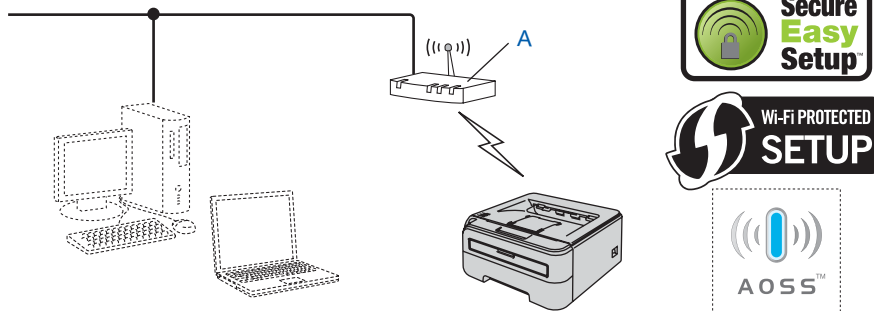

If your wireless access point (A) supports either SecureEasySetup™, Wi-Fi Protected Setup™ (PBC <sup>1</sup>) or AOSS™, you do not need to use a computer to configure the wireless settings. The access point (router) and your printer can automatically negotiate using the SecureEasySetup™, Wi-Fi Protected Setup™ or AOSS™ procedure.

<sup>1</sup> Push Button Configuration

For instructions, see Chapter 6 in the Network User's Guide on the CD-ROM.

### ■ Configuration using the PIN Method of Wi-Fi Protected Setup™

If your wireless access point (A) supports Wi-Fi Protected Setup™, you can also configure using the PIN Method of Wi-Fi Protected Setup™.

For instructions, see Chapter 7 in the Network User's Guide on the CD-ROM.

## Configuration in Infrastructure mode, using a network cable temporarily

Before configuring the wireless settings

### Important

- If you have previously configured the wireless settings of the printer, you must reset the print server back to the default factory settings (See Chapter 11 in the Network User's Guide on the CD-ROM)
- You must know your wireless network settings before you proceed with this installation.
- You need to temporarily use an Ethernet cable during configuration.

Configure the wireless settings

- 1 Make sure the printer power switch is on.



- 2 Turn on your Macintosh®. Put the supplied CD-ROM into your CD-ROM drive.

- 3 Double-click the **HL2100** icon on your desktop. Double-click the **Start Here** icon. Follow the on-screen instructions.

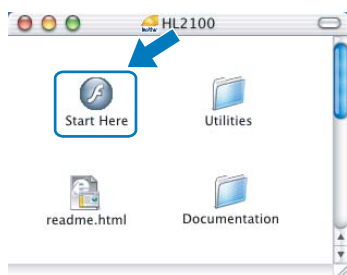

- 4 Click **Install Printer Driver** on the menu screen.

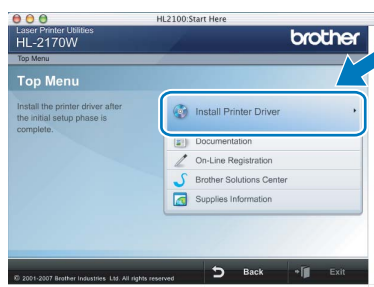

- 5 Click **Wireless Network users**.

- 6 Choose **Wireless Setup and Driver Install (Recommended)**, and then click **Next**.

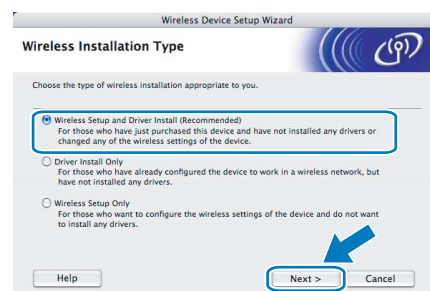

- 7 Choose **Step by Step install (Recommended)** and then click **Next**.



- 8 Choose **With cable (Recommended)** and then click **Next**.



- 9 For configuration, you must temporarily connect your Brother wireless device (your printer) directly to a free port on your access point, hub or router using a network cable. When the following screen appears, insert the network cable to the access point and then to the printer. Click **Next**.



- 10** Choose the printer you wish to configure, and click **Next**. If the list is blank, check if the access point and the printer are powered on, and then click **Refresh**.



**Note** The default Node name is "BRNxxxxxxxxxxx".

- 11** The wizard will search for wireless networks available from your printer. Choose the access point you wish to associate the printer with, and then click **Next**.

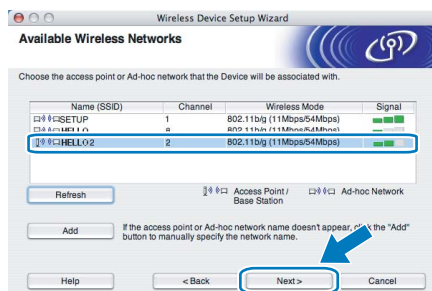

- "SETUP" is the default SSID of the printer. Do not choose this SSID.
- If the list is blank, check that the access point has power and is broadcasting the SSID, and then see if the printer and the access point are within range for wireless communication. Then, click **Refresh**.
- If your access point is set to not broadcast the SSID you can manually add it by clicking the **Add** button. Follow the on-screen instructions for entering the **Name (SSID)**, and then click **Next**.

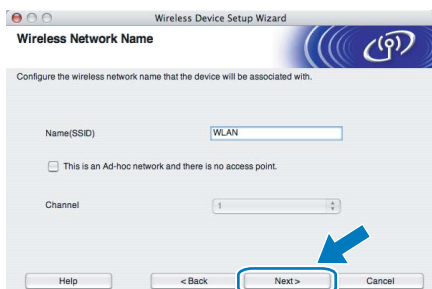

- 12** If your network is not configured for Authentication and Encryption, the following screen will appear. To continue configuration, click **OK**.



- 13** If your network is configured for Authentication and Encryption, the following screen will appear. When configuring your Brother wireless printer, you must ensure that it is configured to match the Authentication and Encryption settings of your existing wireless network. Choose the **Authentication Method** and **Encryption Mode** from the pull-downs in each setting box. Then enter the **Network key** and **Confirm Network Key**, and then click **Next**.

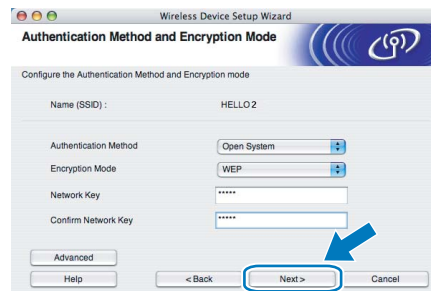

- If you want to setup more than WEP key1, click **Advanced**.
- If you do not know the Authentication or Encryption settings for your network, contact your network administrator.
- If the **Authentication Method** is set to **Open System** and the **Encryption Mode** is set to **WEP**, an error indication will NOT appear if the **Network key** is incorrect.

- 14** Click **Next**. The settings will be sent to your printer. The settings will remain unchanged if you click **Cancel**.

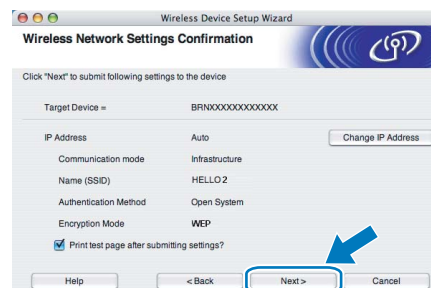



**Note**

If you want to manually enter the IP address settings of your printer, click **Change IP Address** and enter the necessary IP address settings for your network.

- 15** Disconnect the network cable between your access point (hub or router) and the printer, and click **Next**.



## Installing the printer driver

**Improper Setup**

- **DO NOT** try to cancel any of the screens during this installation.
- If your wireless settings fail, an error message will appear during the installation of the printer driver and the installation will be terminated. If you encounter this failure, please go back to step 4 and setup the wireless connection again.

- 1** The driver installation starts. Follow the on-screen instructions. Then, restart your Macintosh®.

**For Mac OS® X 10.2.4 to 10.2.8 users:**  
Go to step 4.

**For Mac OS® X 10.3 or greater users:**  
Go to step 2.

- 2** The Brother software will search for the Brother printer. During this time the following screen will appear.

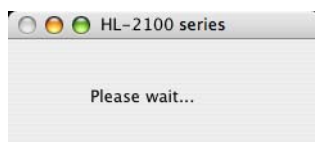
**Note**

If more than one printer is available, the following list appears. Choose the printer you wish to connect, and then click **OK**.

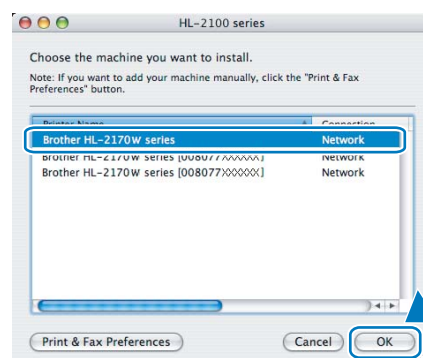

- If there is more than one of the same printer model connected on your network, the Ethernet address (MAC address) will be displayed after the model name.
- You can find your printer's Ethernet address (MAC address) by printing out the **Printer Settings Page**.
- If your printer fails to appear on the list, reset the print server back to the default factory settings and go back to step 4 and try the wireless setup again.

- 3** When this screen appears, click **OK**.



- OK!** For Mac OS® X 10.3 or greater users:  
Setup is now complete.

- 4** When this screen appears, click **Add**.

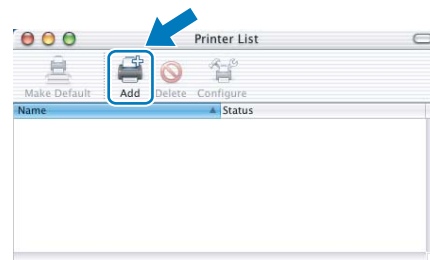

- 5** Make the following selection.

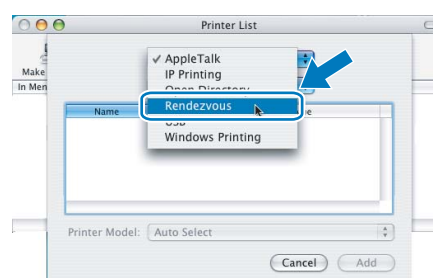

- 6** Choose your printer, and then click **Add**.

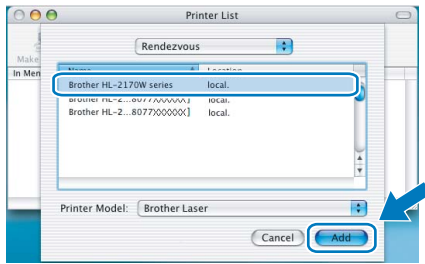

## Note

- If there is more than one of the same printer model connected on your network, the Ethernet address (MAC address) will be displayed after the model name.
- You can find your printer's Ethernet address (MAC address) by printing out the Printer Settings Page.
- If your printer fails to appear on the list, reset the print server back to the default factory settings and go back to step 4 and try the wireless setup again.

- 7** Click **Print Center**, then **Quit Print Center**.



**For Mac OS® X 10.2.4 to 10.2.8 users:**  
Setup is now complete.

## Shipment of the printer

If for any reason you must ship your printer, carefully package the printer to avoid any damage during transit. We recommend that you save and use the original packaging. The printer should also be adequately insured with the carrier.

### ! Caution

When shipping the printer, the DRUM UNIT and TONER CARTRIDGE assembly must be removed from the printer and put in a plastic bag. Failure to remove the unit and put it in a plastic bag before shipping may cause severe damage to the printer and may VOID THE WARRANTY.

- 1 Turn off the printer power switch, and then unplug the AC power cord.

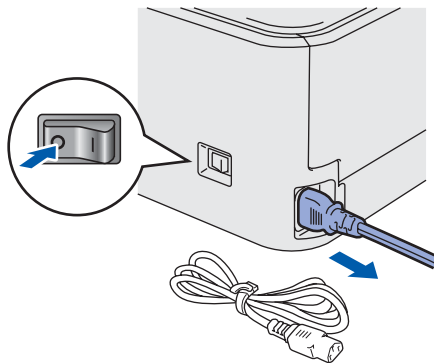

- 2 Remove the drum unit and toner cartridge assembly. Put it in a plastic bag and seal the bag completely.



- 3 Repack the printer.

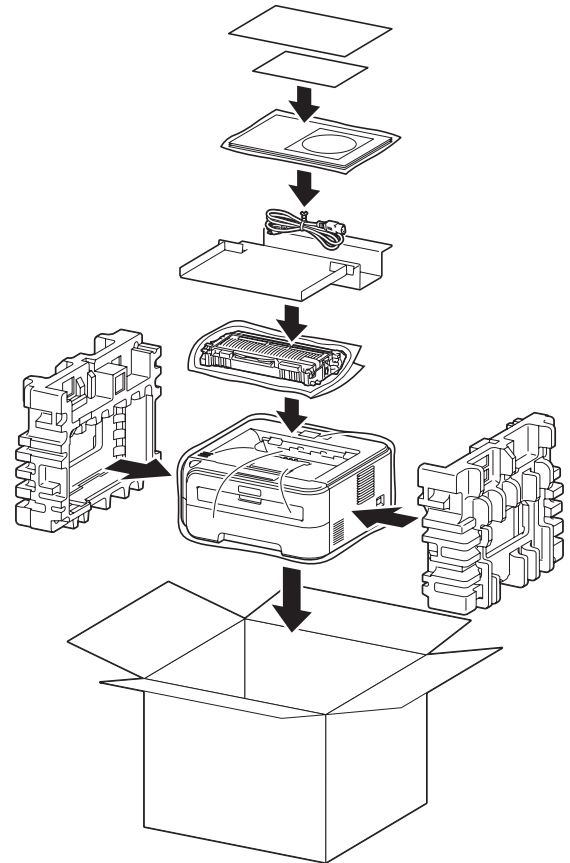



**brother®**