

brother

# Card Reader Operation Guide



Version A  
ENG

## Definitions of notes

We use the following icon throughout this user's guide:

 <b>Note</b>	Notes tell you how you should respond to a situation that may arise or give tips about how the operation works with other features.
---	---

## Trademarks

Each company whose software title is mentioned in this manual has a Software License Agreement specific to its proprietary programs.

Indala and iCLASS are registered trademarks of HID Global in the U.S. and/or other countries.

**Any trade names and product names of companies appearing on Brother products, related documents and any other materials are all trademarks or registered trademarks of those respective companies.**

©2012-2015 Brother Industries, Ltd. All rights reserved.

# Table of Contents

<b>1</b>	<b>Introduction</b>	<b>1</b>
	Overview.....	1
	Available card readers.....	1
	Configuring the card authentication settings using Web Based Management .....	2
<b>2</b>	<b>Printing Using Card Authentication</b>	<b>4</b>
	Printing storage data using a card.....	4
	Deleting storage data using a card.....	5

## Overview

Your machine has a USB port to connect the card reader. If the optional card reader is connected to the machine, you can use a card for user authentication when using the Storage Print feature. Because the user's identity is confirmed simply by touching the card to the card reader instead of entering the user name and password, the card reader is very convenient.



### Note

When you use the Storage Print feature, security is strengthened because others cannot access the storage data that you sent to the machine. For more information about Storage Print, see the User's Guide that is supplied with your machine.

## Available card readers

The following card readers can be connected to your machine.

Manufacturer	Model number	Compatible card type
RFIDeas	RDR-6081AKU	HID Prox
	RDR-6281AKU	Casi-Rusco
	RDR-6381AKU	Indala®
	RDR-6E81AKU	EM 410x
	RDR-6H81AKU	HiTag
	RDR-7081AKU	iCLASS®
	RDR-7581AKU	MIFARE, ISO 14443A/ISO 15693
	RDR-7F81AKU	FeliCa

# Configuring the card authentication settings using Web Based Management

You need to enable card authentication and register your card number using a web browser.

- 1 Start your web browser.
- 2 Type "http://machine's IP address/" into your browser (where "machine's IP address" is the machine's IP address).
  - For example:  
http://192.168.1.2/



### Note

No password is required by default. Enter a password if you have set one and press .

- 3 Click the **Administrator** tab.
- 4 Click **Secure Function Lock**.  
Make sure that **Function Lock** is set to **On**.
- 5 Click **PC Print Restriction by Login Name**.  
Make sure that **PC Print Restriction** is set to **On**.

The screenshot shows the web management interface for the HL-S7000DN series. The 'Administrator' tab is selected, and the 'PC Print Restriction by Login Name' page is displayed. The page includes a sidebar with navigation options, a main content area with configuration options, and a table for registering users.

**HL-S7000DN series** Please configure the password >> **brother**  
Brother Solutions Center

General Print **Administrator** Network

Login Password  
Secure Function Lock  
PC Print Restriction by Login Name  
Last Counter Record  
Counter Auto Reset  
Setting Lock  
Store Print Log to Network  
Storage Print  
Stored Job Type  
Stored Job List  
Reset Menu

### PC Print Restriction by Login Name

By configuring this setting, the device can authenticate user by PC login name at PC print.  
Select the ID Number/Name and then enter the user's logon name.

**PC Print Restriction**  Off  On  
**Card Authentication Restriction**  Off  On

	Login Name	IC Card Number	ID Number
1	BROTHER	XXXXXXXXXXXX	01 BROTHER
2			--
3			--
4			--
5			--
6			--
7			--
8			--
9			--
10			--
11			--
12			--
13			--
14			--
15			--
16			--

- 6 Choose **On** from **Card Authentication Restriction**.
- 7 Enter the PC user login name in the **Login Name** box and enter the card number in the **IC Card Number** box. Then choose the ID Number from the **ID Number** pull-down list.  
To register additional login names and card numbers, repeat step 7.



**Note**

---

The **ID Number** must be registered as the **ID Number/Name** of the **Secure Function Lock** in advance. If the **ID Number** is not registered, an unregistered error will occur.

For details about the **Secure Function Lock**, see the Network User's Guide.

---

- 8 Click **Submit**.



**Note**

---

- If you have a problem configuring the card number, make sure that the registered number is the same as the number displayed on the actual card reader that you will use.
  - Because an incorrect number may be registered, we recommend that you carry out a test print using card authentication.
  - You can also register your card number using a card reader. Connect the card reader to your computer, position the pointer on the **IC Card Number** box in the Web Based Management page, and touch the card to the card reader.
  - If you register your card number using a card reader, the number is registered once it is read by the card reader. If you do not want the card number to be registered when it is read by the card reader, use the card reader Configuration Utility that can be downloaded from the RFIDEas Web site. Start the Configuration Utility and then click the **Set Keystroke Data** tab and choose **NONE** from **This keystroke appended to data**.
-

## Printing storage data using a card

- 1 Unplug the power cord from the AC power outlet.
- 2 Connect the card reader to your machine, and then plug the machine's power cord into the AC power outlet.

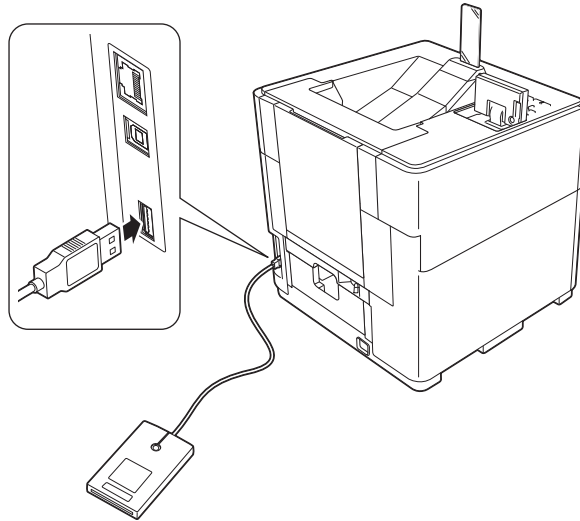

- 3 From your computer, select **Store as Personal(Secure)** or **Store as Personal** and send the job to the machine. For details, see the User's Guide.
- 4 Touch the card to the card reader.
- 5 Press ▲ or ▼ to choose the job. Press **OK**.
- 6 (If the document is protected using a password)  
Enter the password. Press **OK**.
- 7 Press ▲ or ▼ to choose **Print** or **Print&Delete**. Press **OK**.  
If you choose **Print&Delete**, the data will be deleted after it is printed.
- 8 (If you chose **Print&Delete** in step 7)  
Press ▲ or ▼ to choose **Yes**. Press **OK**.
- 9 Enter the number of copies. Press **OK**.

## Deleting storage data using a card

- 1 Connect the card reader to your machine.
- 2 Touch the card to the card reader.
- 3 Press ▲ or ▼ to choose the job. Press **OK**.
- 4 (If the document is protected using a password)  
Enter the password. Press **OK**.
- 5 Press ▲ or ▼ to choose `Delete`. Press **OK**.
- 6 Press ▲ or ▼ to choose `Yes`. Press **OK**.  
The LCD will show `Deleted`, and then the machine will return to Ready mode.



# brother

Visit us on the World Wide Web  
<http://www.brother.com/>



[www.brotherearth.com](http://www.brotherearth.com)