

brother

Quick Reference Guide

快速操作指南

快速導覽手冊

빠른 설정가이드

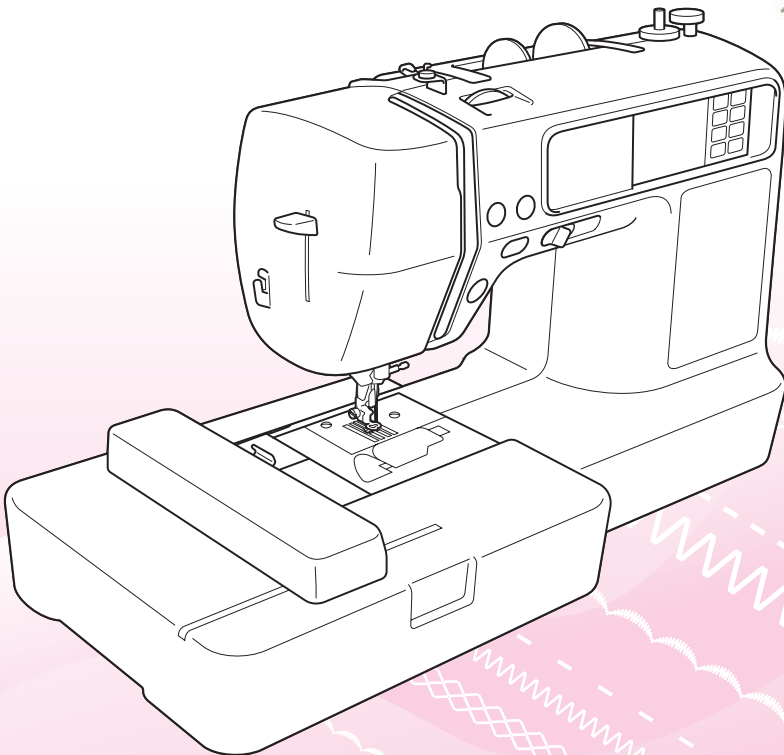
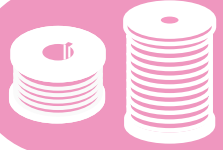

Refer to the operation manual for detailed instruction.

Also, there are differences in the keys and screens depending on the display language.
In this guide, English screens are used for basic explanations.

有关详细说明，请参见使用说明书。

另外，按键和画面会因显示语言略有不同。
在本操作指南中，使用英文画面进行基本说明。

有關詳細說明，請參閱說明書。

此外，視顯示語言而定，按鍵和畫面各有不同。
在本手冊中，英文畫面用於基本解釋。

세부 지침에 대해서는 사용설명서를 참조하십시오.

또한 표시 언어에 따라 키와 화면에 차이가 있습니다.
이 설명서에서는 기본 설명에 영어 화면을 사용합니다.

Contents 目录 内容 내용

	Machine Features 縫紉機的特點	縫紉機功能 재봉기의 특징	2
	Bobbin Winding and Setting 捲底線與設定	梭芯繞線和設置 밀실 감기 및 설정	4
	Upper Threading 穿上線	面線穿線 윗실 끼우기	6
	Selecting Stitch Patterns 選擇針趾花樣	選擇針迹花樣 재봉 패턴 선택	8
	Summary of Stitch Patterns 針趾花樣摘要	針迹花樣概述 재봉 패턴 요약	10
	Preparing to Embroider 準備進行刺繡	準備绣花 자수 준비	13
	Selecting Embroidery Patterns 選擇刺繡花樣	選擇绣花花樣 자수 패턴 선택	15
	Alphanumeric Character Patterns 字母數字文字花樣	字母、數字花樣 문자 패턴	21
	Frame Patterns 外框花樣	框架花樣 테두리 모양	23
	Embroidery Pattern Color Change Table 刺繡花樣顏色變換表	绣花花樣顏色變換表 패턴 실 색상표	24
	Color Thread Conversion Chart 彩線對照表	彩線對照表 컬러 실 변환 차트	28



Machine Features

縫紉機的特點

縫紉機功能

재봉기의 특징

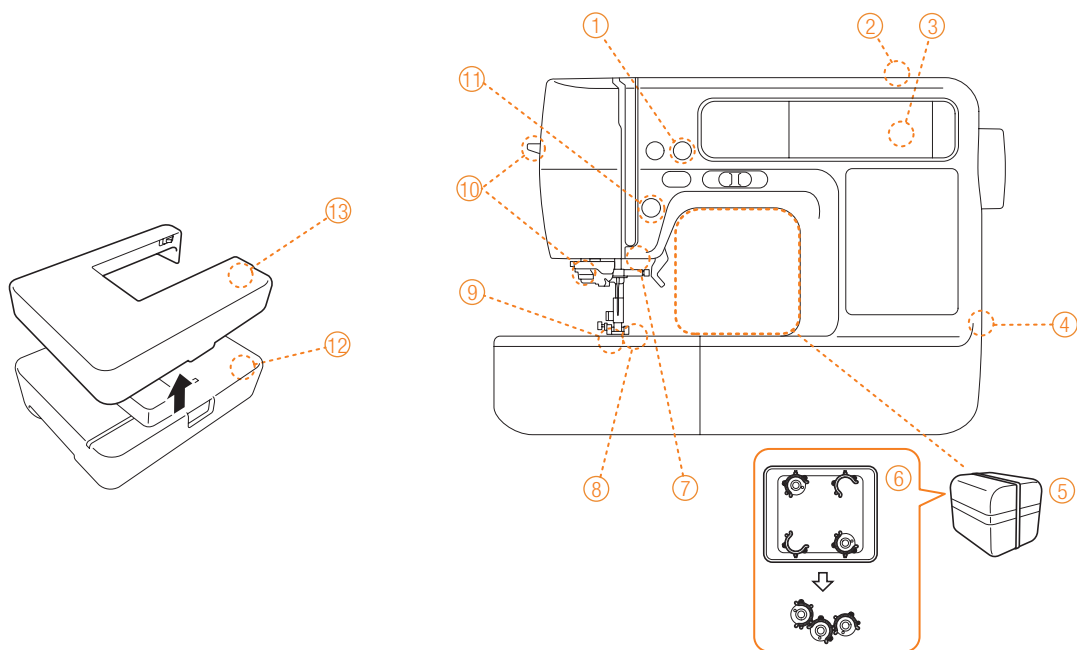

- ① **Automatic thread cutting:** The thread can be cut automatically after sewing.
- ② **Fast bobbin winding system:** With the fast and simple bobbin winder, you can wind bobbins with one press of a button.
- ③ **Built-in stitches:** You can select from the built-in stitches available, including utility stitches and decorative stitches.
- ④ **USB port:** Embroidery patterns saved in a USB flash drive (USB flash memory) can be imported to the machine by plugging the USB flash drive directly into the USB port.
- ⑤ **Accessory case:** You can store the accessory case inside the arm of the machine as shown in the figure. Presser foot, bobbins, a seamripper, etc. can be stored in this case.
- ⑥ **Bobbin clip:** You can use the bobbin clip to prevent the end of the thread wound onto the bobbin from loosening. Bobbin clips can be stored inside of the accessory case cover.
- ⑦ **Bright light:** The convenient LED lamp makes it easy to work on dark fabrics.
- ⑧ **Seven-point feed dogs:** Ensure smooth, even feeding of multiple fabric layers and a variety of fabric weights.
- ⑨ **Quick-set bobbin:** You can start sewing without pulling up the bobbin thread.
- ⑩ **Easy-to-use needle threader:** You can thread the needle easily by one press of a lever.
- ⑪ **Lighting Start/Stop button:** When the green light is on, the machine is ready to sew. A red or orange light indicates an error or that the machine is warming up.
- ⑫ **Embroidery:** You can embroider built-in embroidery patterns, alphanumeric characters, framed decorations, and designs from optional embroidery cards.
- ⑬ **Extension table (Cover of the embroidery unit):** material.

- ① **自动切线:** 缝制后可以自动剪线。
- ② **快速梭芯绕线系统:** 装有快速和简单的梭芯绕线器, 能够通过按下一个按钮进行梭芯绕线。
- ③ **内藏针迹:** 可以选择内藏针迹, 包括实用针迹和装饰针迹。
- ④ **USB 端口:** 绣花花样存储在U盘中 (USB闪存), 将U盘直接插入到USB端口上, 以输入到缝纫机中。
- ⑤ **附件盒:** 可将附件盒存放在如图所示的缝纫机臂中。压脚、梭芯、拆缝小刀等可存放在此盒内。
- ⑥ **梭芯夹:** 使用梭芯夹, 以防止线头卷到梭芯上, 造成松线。梭芯夹可存放在附件盒里面。
- ⑦ **照明灯:** 近处的LED灯可方便缝制深色布料。
- ⑧ **七点式送布牙:** 确保平滑送入多层和不同重量的布料。
- ⑨ **快装梭芯:** 不用拉起梭芯线, 便可直接开始缝制。
- ⑩ **易于使用的针穿线器:** 按下拨杆, 轻松穿线。
- ⑪ **开始/停止按钮指示灯:** 绿灯亮时, 缝纫机缝制准备就绪。红灯或橙色灯亮表示出错或者缝纫机正在暖机。
- ⑫ **绣花:** 可以绣出内藏绣花花样、字母、数字、装饰边框, 以及可选绣花卡上的图案。
- ⑬ **扩展台(绣花单元盖子):** 当缝制大面料时, 可将绣花单元的盖子作为扩展台使用。

- ① **自動切線裝置:** 縫紉完成後, 可自動將線切斷。
- ② **快速捲底線系統:** 透過快速且簡單的捲底線裝置, 您可藉由按下按鈕來捲底線。
- ③ **內建針趾花樣:** 您可從現有的內建針趾花樣中, 選擇實用的針趾和裝飾性針趾。
- ④ **USB 插槽:** 儲存在 USB 媒體 (隨身碟) 的刺繡花樣, 可透過將 USB 媒體直接插入 USB 插槽來匯入。
- ⑤ **零配件盒:** 您可將零配件盒儲存在縫紉機的巧臂中, 如圖所示。壓布腳、梭子和拆線刀等物品可存放在此盒中。
- ⑥ **線架夾:** 您可使用線架夾來防止線尾捲進梭子而鬆脫。線架夾可儲存在零配件盒蓋的內部。
- ⑦ **亮光:** 此方便的 LED 燈可讓您更輕鬆地處理深色布料。
- ⑧ **七點式送布齒:** 確保多層布料和各種厚度布料的流暢、平均送布。
- ⑨ **快速安裝底線:** 您可直接開始縫紉, 無需再引起底線。
- ⑩ **“自動穿線”裝置:** 您可透過按下拉柄來輕鬆穿線。
- ⑪ **照明啟動/停止按鈕:** 綠燈亮起時, 表示機器已準備好進行縫紉。紅燈或橘燈亮起時, 表示發生錯誤或是縫紉機正在暖機。
- ⑫ **刺繡:** 您可刺繡內建的刺繡花樣、字母數字文字、外框花樣和選購刺繡卡中的設計。
- ⑬ **延長桌(繡花專用座的外蓋):** 您可使用繡花專用座的外蓋作為縫紉大型布料時的延長桌。

- ① **자동 실 자르기:** 재봉이 끝난 후 자동으로 실을 자를 수 있습니다.
- ② **빠른 밀실 감기 장치:** 실토리에 밀실을 손쉽게 빠르게 감을 수 있습니다.
- ③ **내장된 재봉 모양:** 유용한 재봉 및 유틸리티 재봉, 장식 재봉 등이 내장되어 있으므로 원하는 재봉을 선택할 수 있습니다.
- ④ **USB 포트:** USB 플래시 드라이브 (USB 플래시 메모리)에 저장된 자수 패턴은 USB 플래시 드라이브를 재봉기의 USB 포트에 직접 꽂아서 불러올 수 있습니다.
- ⑤ **액세서리 케이스:** 그림에 나타난 바와 같이 재봉기의 액세서리통 내부에 있는 액세서리 케이스에 보관할 수 있습니다. 노루발, 실토리, 리퍼등 다양한 액세서리를 보관할 수 있습니다.
- ⑥ **실토리 클립:** 실토리 위에 감겨진 실 끝이 풀리는 것을 막기 위해 실토리 클립을 사용할 수 있습니다. 액세서리 보관함 케이스에 있는 실토리 클립에 실토리를 꼽아 보관할 수 있습니다.
- ⑦ **조명 장치:** 내장된 LED 조명 램프로 어두운 곳에서도 쉽게 작업할 수 있습니다.
- ⑧ **7포인트 톱니:** 두껍거나 얇은 천도 미끌림 없이 부드럽게 넘겨줍니다.
- ⑨ **원터치 밀실 처리:** 재봉 시작 전에 밀실을 끌어올리지 않고 바로 사용할 수 있습니다.
- ⑩ **간편한 밀실 끼우기:** 레버를 내림으로써 손쉽게 바늘에 실을 끼울 수 있습니다.
- ⑪ **시작/멈춤 버튼:** 녹색 등이 켜져 있을 때 재봉이 가능하며 예러가 났거나 준비 단계일 때 적색 또는 오렌지색 등이 들어옵니다.
- ⑫ **자수:** 내장된 자수 패턴, 문자, 프레임 장식 및 별매품 자수 카드의 디자인을 사용할 수 있습니다.
- ⑬ **확장 테이블(자수 유닛의 커버):** 자수 유닛에 올려놓아 확장 테이블로 사용할 수 있습니다.

Bobbin Winding and Setting

梭芯绕线和设置

捲底線與設定

밑실 감기 및 설정



Follow the numbered steps below in order. Refer to the operation manual for detailed instruction.

按顺序执行以下编号的步骤。详细指导请参阅使用说明书。

依順序進行以下的編號步驟。有關詳細說明，請參閱說明書。

아래에 번호가 매겨진 단계를 순서대로 따르십시오. 세부 지침에 대해서는 사용설명서를 참조하십시오.

Use only the enclosed bobbin or bobbins of the same type.

请务必限使用随机附带的梭芯或同类型梭芯。

僅能使用附屬的梭子，或是相同類型的梭子。

동봉된 실토리 또는 동일한 종류의 실토리만 사용하십시오.

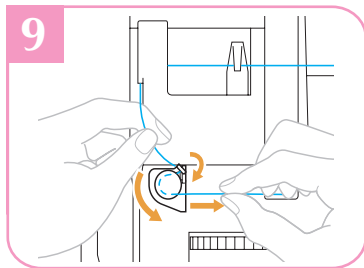
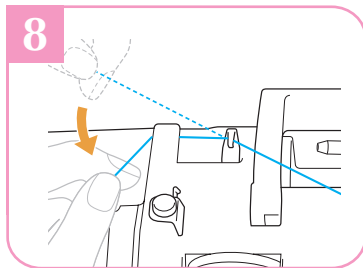
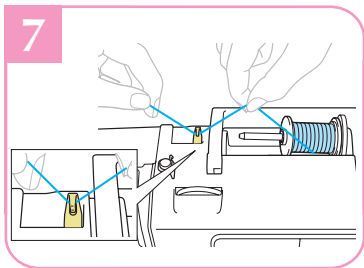
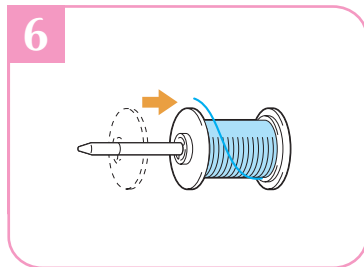
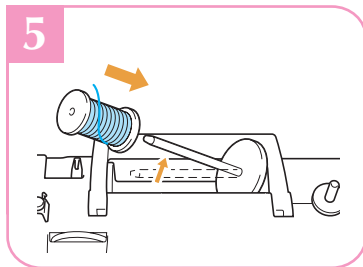
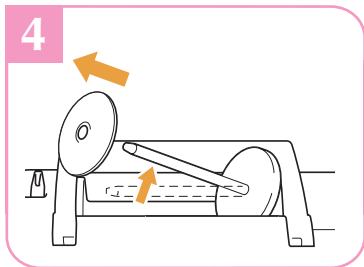
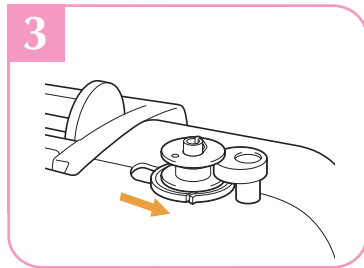
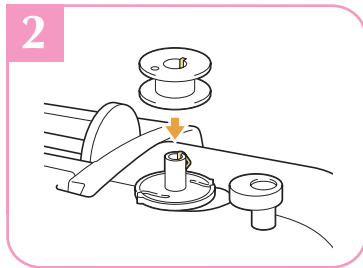
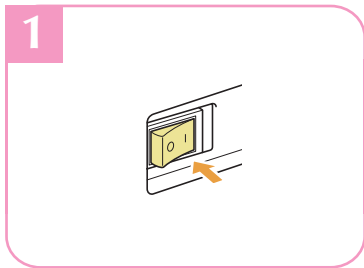
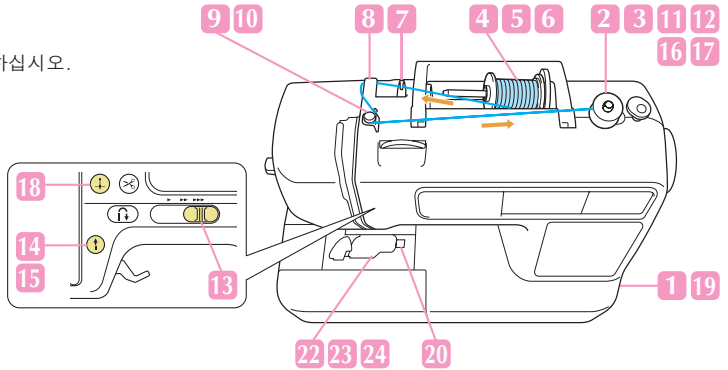
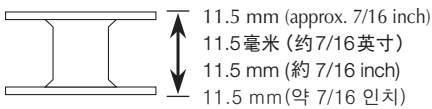

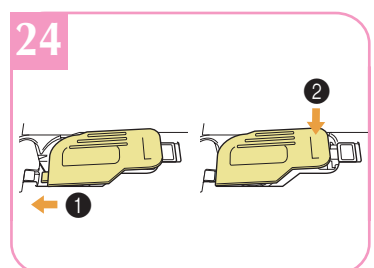
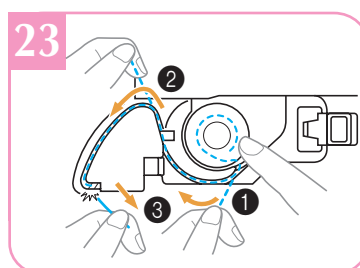
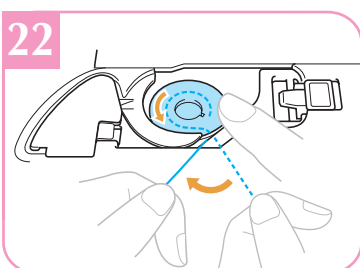
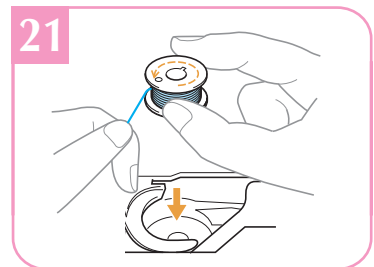
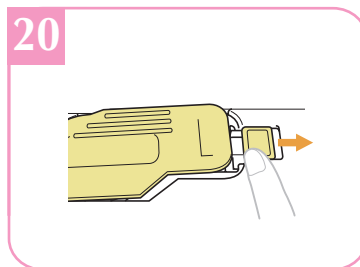
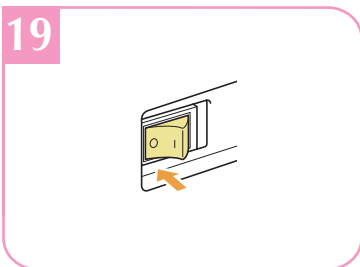
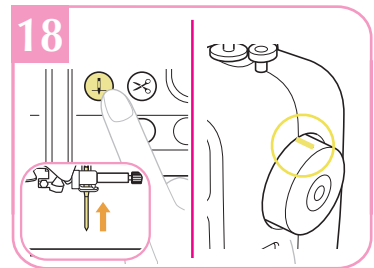
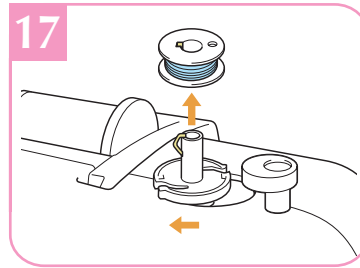
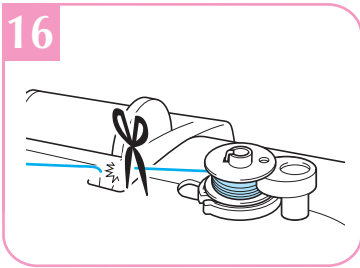
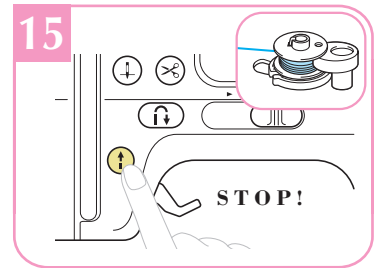
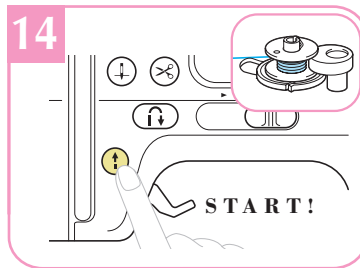
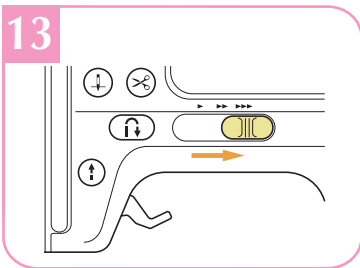
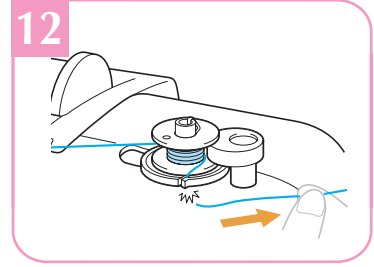
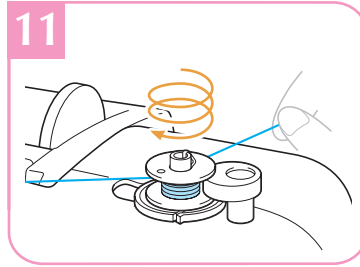
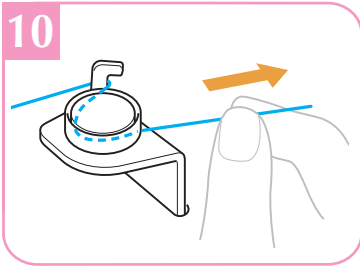

ABC
VVV



Upper Threading

面线穿线

穿上線

윗실 끼우기

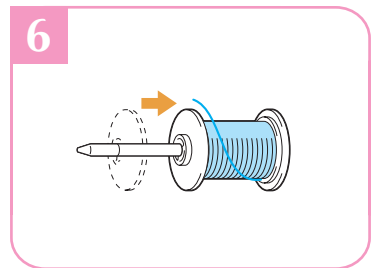
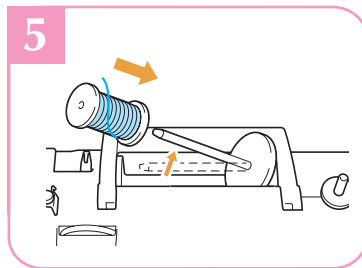
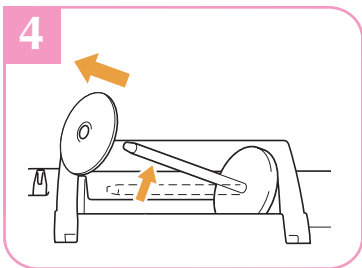
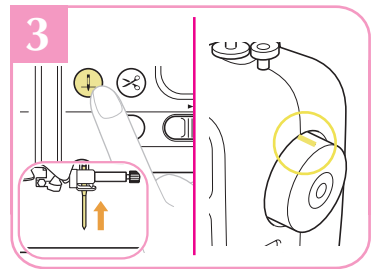
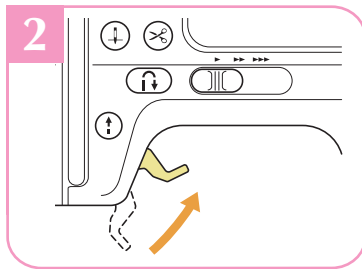
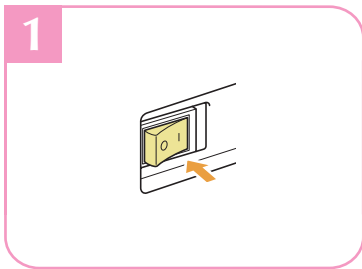
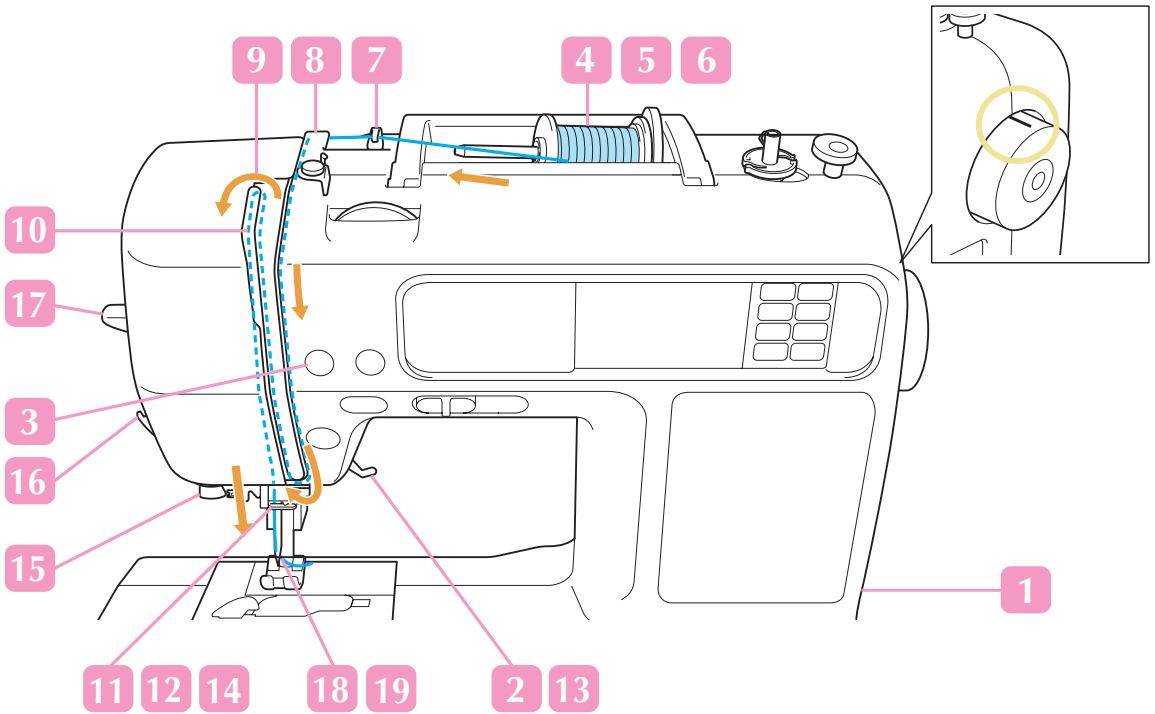
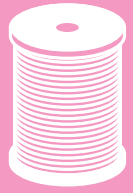

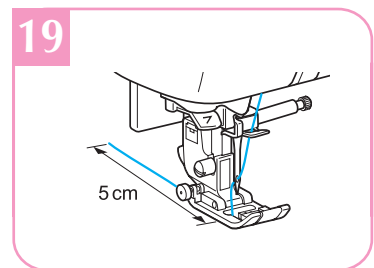
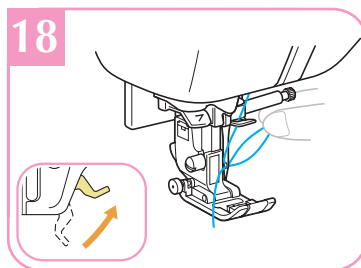
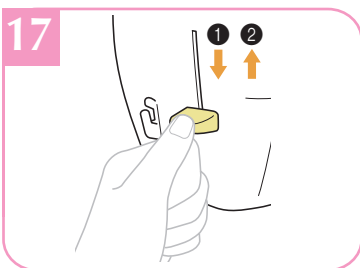
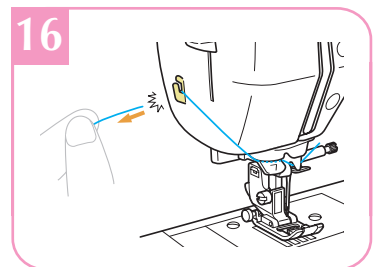
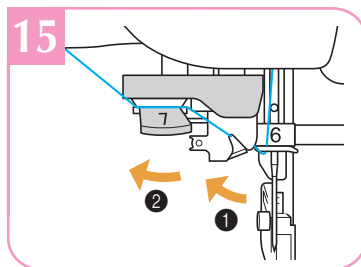
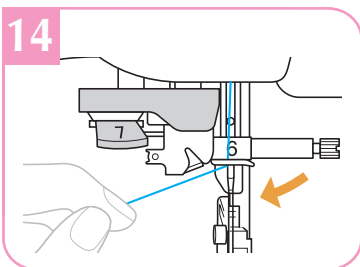
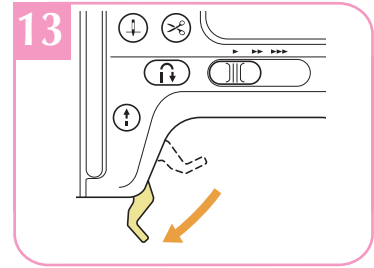
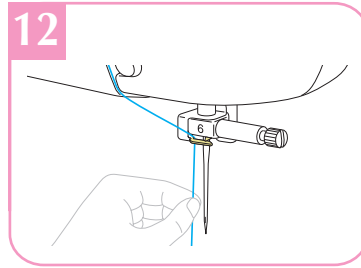
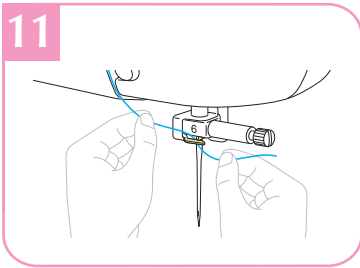
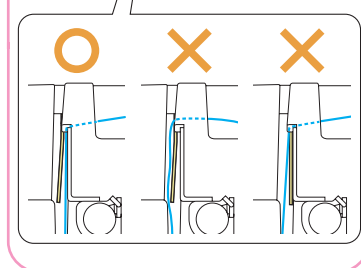
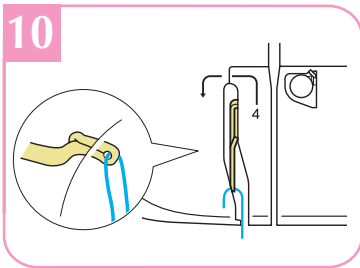
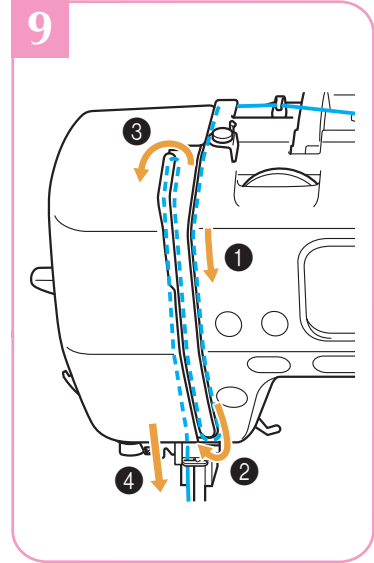
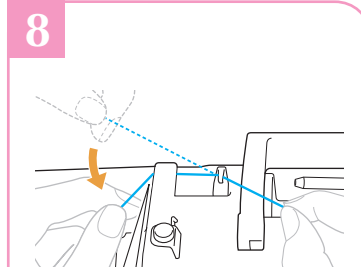
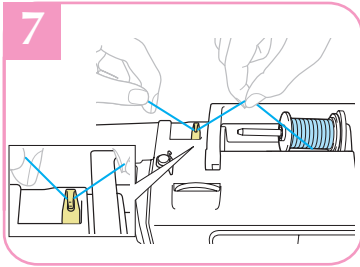

Selecting Stitch Patterns

选择针迹花样

選擇針跡花樣

재봉 패턴 선택



◆ Utility Stitches

◆ 實用的針跡

◆ 实用针迹

◆ 유용한 재봉

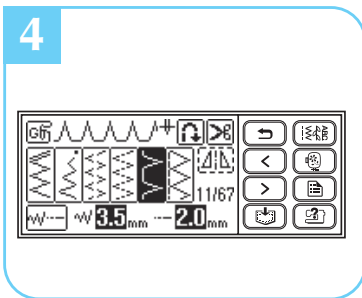
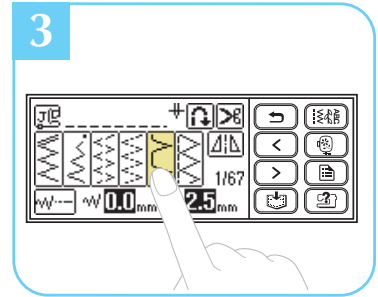
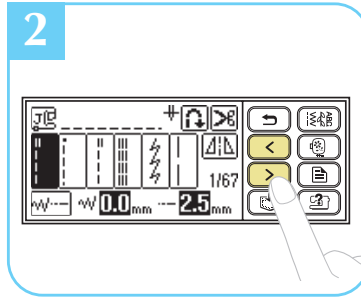
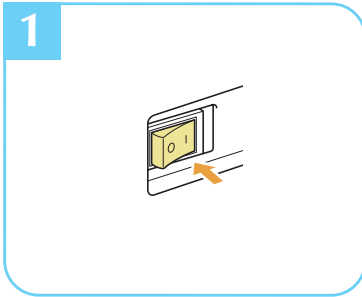

◆ Other Stitches

◆ 其他的針跡

◆ 其它针迹

◆ 기타 재봉

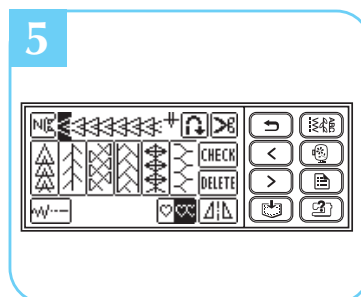
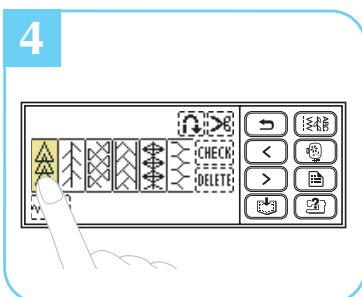
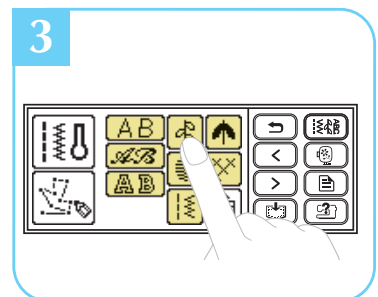
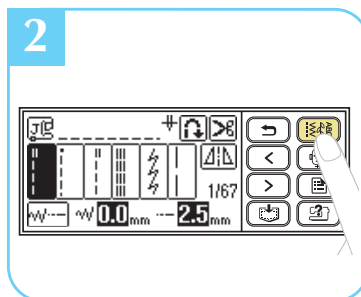
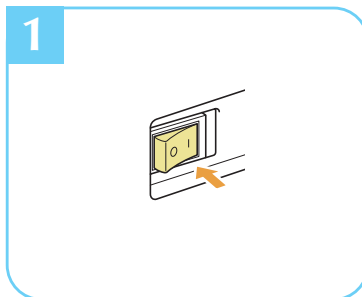

LCD Flow Chart
LCD 流程圖

LCD 流程图
LCD 선택순서

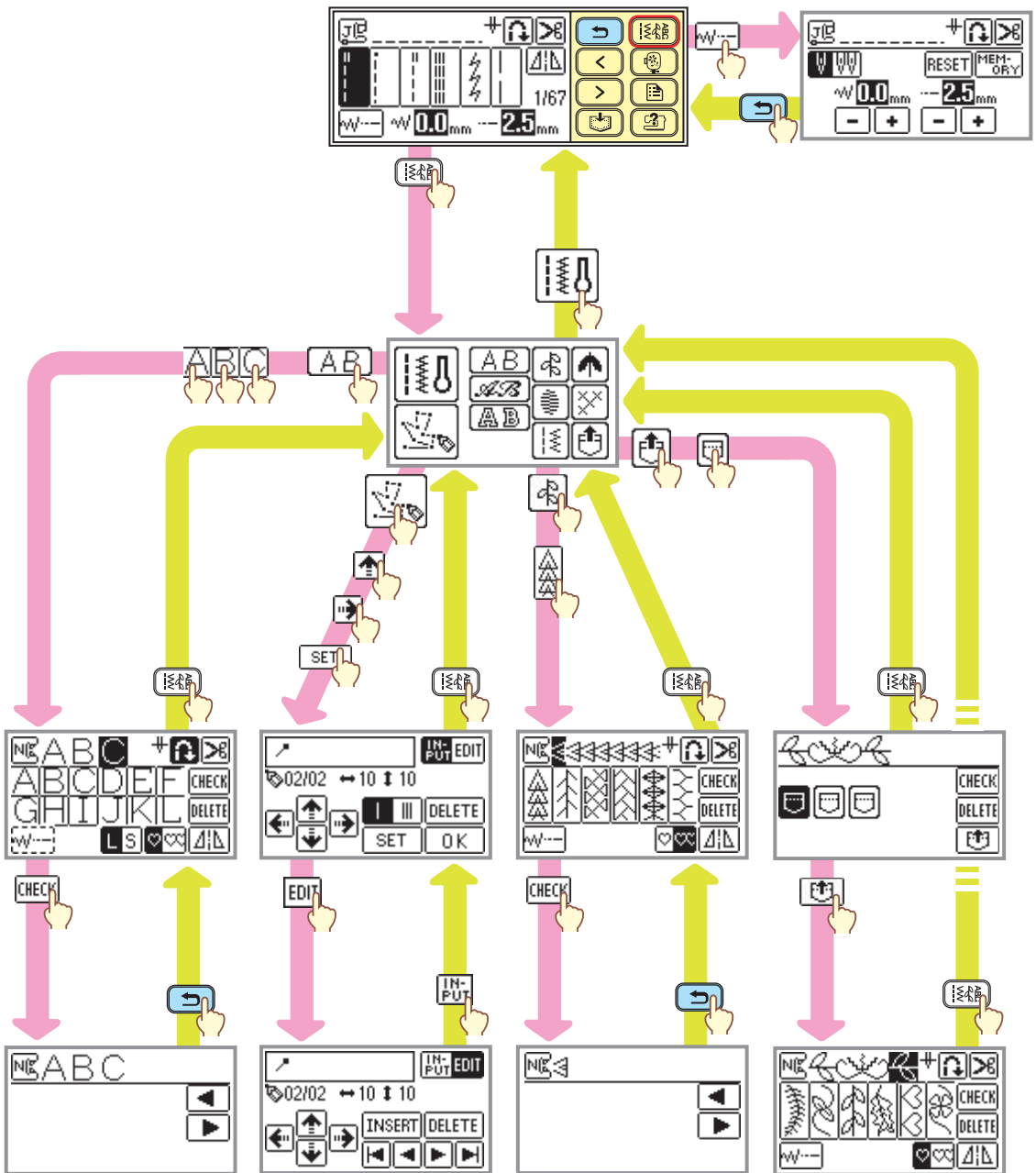

Summary of Stitch Patterns

针迹花样概述

針跡花樣摘要

재봉 패턴 요약



◆ Utility Stitches

◆ 實用的針跡

◆ 实用针迹

◆ 유용한 재봉

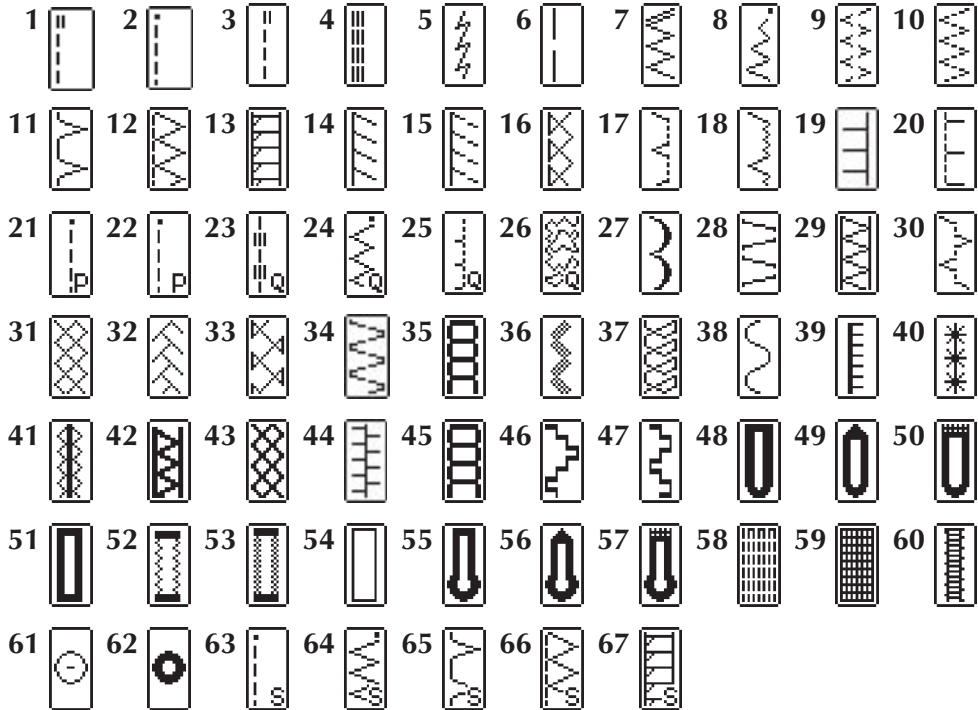

◆ Other Stitches

◆ 其他的針跡

◆ 其它针迹

◆ 기타 재봉



■ Decorative stitches

■ 裝飾性針跡

■ 装饰针迹

■ 장식 재봉

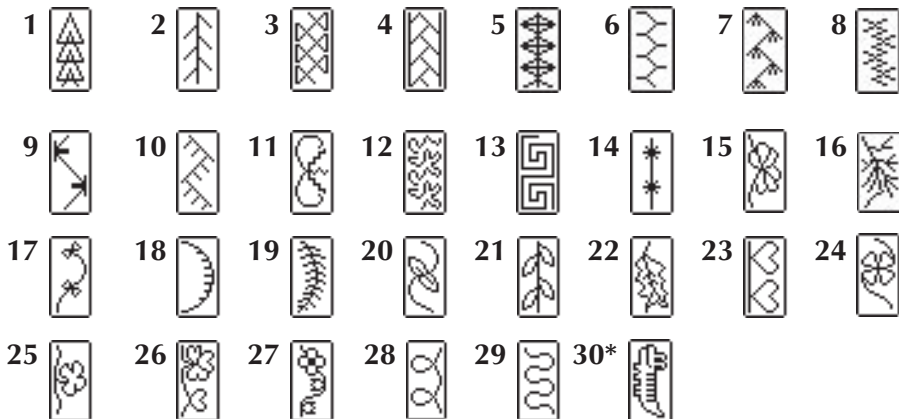

* Pattern for making adjustment * 用于调整的花样 * 用於進行調整的花樣 * 조정 가능한 패턴



■ Satin stitches

■ 緞繡針跡

■ 緞紋針跡

■ 새틴 재봉

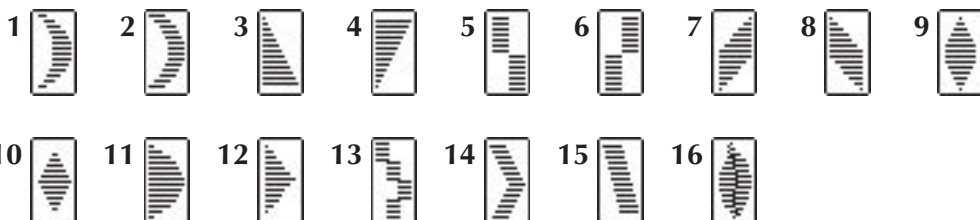

■ Cross-stitches

■ 十字繡花樣

■ 十字繡針跡

■ 십자수 재봉

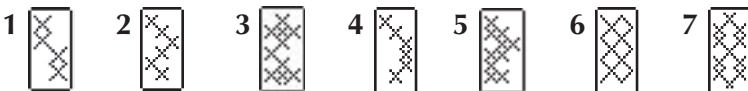

■ Decorative Satin stitches

■ 裝飾性緞繡針跡

■ 裝飾緞紋針跡

■ 장식 새틴 재봉



■ Combined Utility Stitches

■ 組合的實用針跡

■ 組合式實用針跡

■ 유용한 연결 재봉

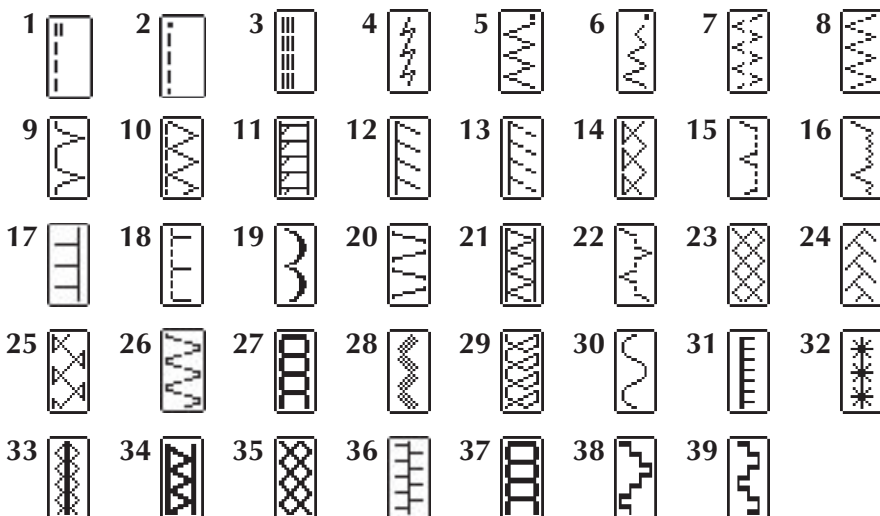

Summary of Stitch Patterns

针迹花样概述

針跡花樣摘要

재봉 패턴 요약

◆ Character Stitches ◆ 文字针迹

◆ 文字針跡

◆ 문자 재봉



■ Gothic font

■ 哥特式字体

■ 歌德式字體

■ 고딕체

ABCDEF GHIJKLMNOPQRS
TUVWXYZ
0123456789
&?! - _ () ' . ,
Ä Å Æ Ñ Ö Ø Ç Ü ß



■ Script font

■ 手写字体

■ 手寫式字體

■ 장식체

ABCDEF GHIJKL MNOPQRS
TUVWXYZ
0123456789
&?! - _ () ' . ,
Ä Å Æ Ñ Ö Ø Ç Ü ß



■ Outline style

■ 空心字体

■ 中空式字體

■ 아웃라인 영문체

ABCDEF GHIJKLMNOPQRS
TUVWXYZ
0123456789
&?! - _ () ' . ,
Ä Å Æ Ñ Ö Ø Ç Ü ß

Preparing to Embroider

准备绣花

準備進行刺繡

자수 준비

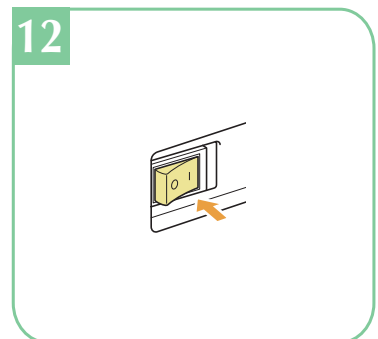
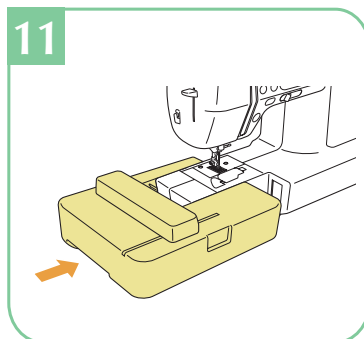
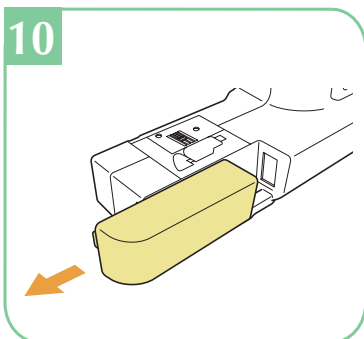
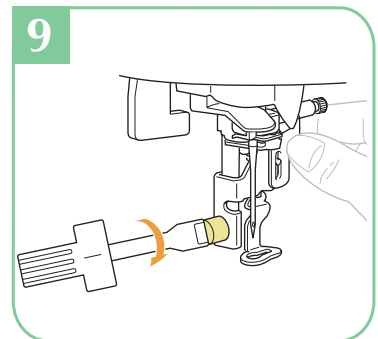
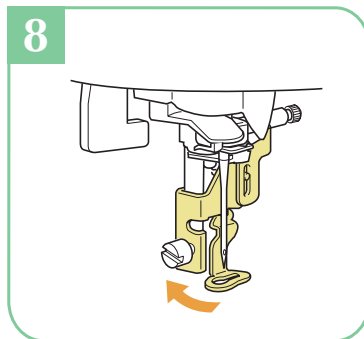
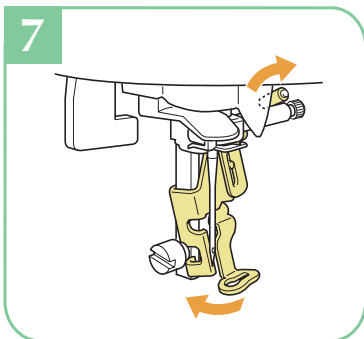
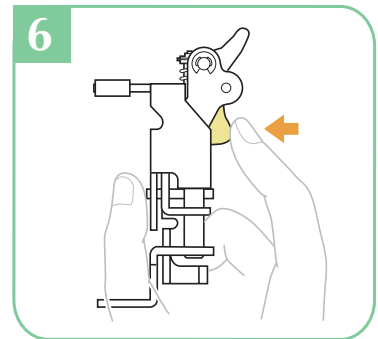
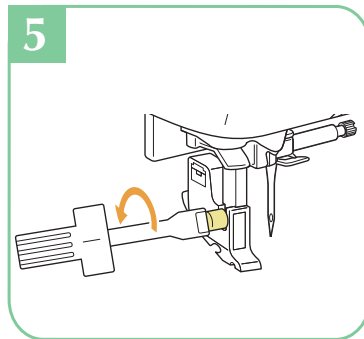
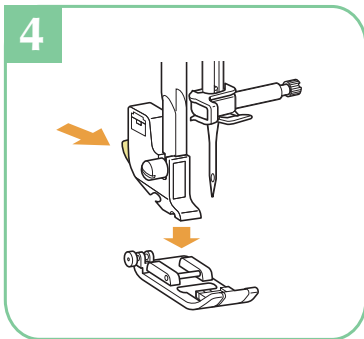
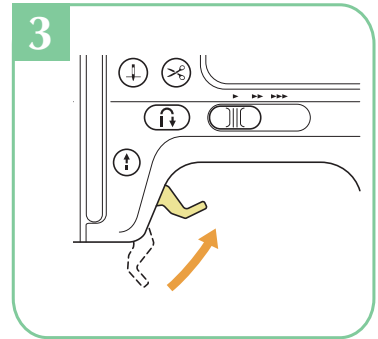
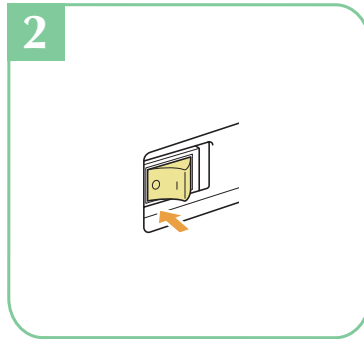
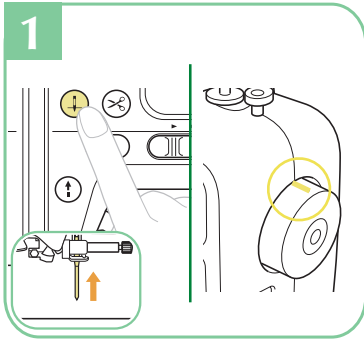

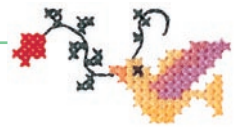

Preparing to Embroider

准备绣花

準備進行刺繡

자수 준비

13

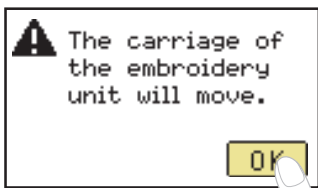

14

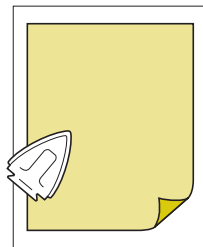

15

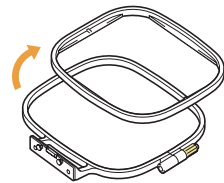

16

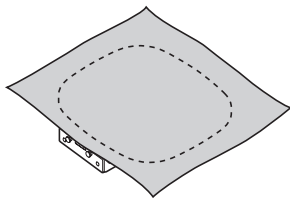

17

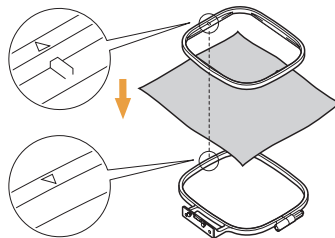

18

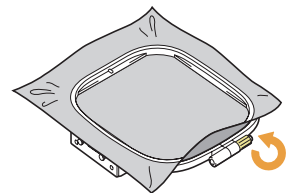

19

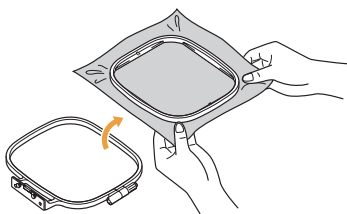

20

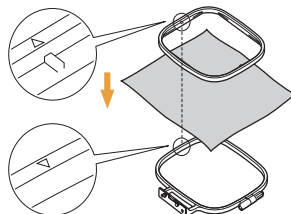

21

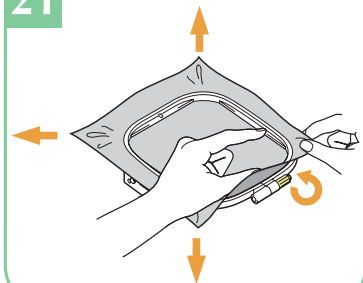

22

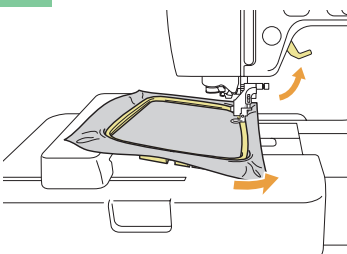

23

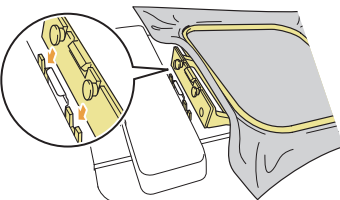

Selecting Embroidery Patterns

选择绣花花样

選擇刺繡花樣

자수 패턴 선택



- ◆ Selecting the built-in patterns
- ◆ 选择内置花样
- ◆ 選擇內建花樣
- ◆ 내장된 패턴 선택

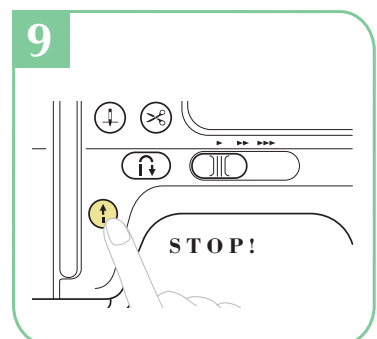
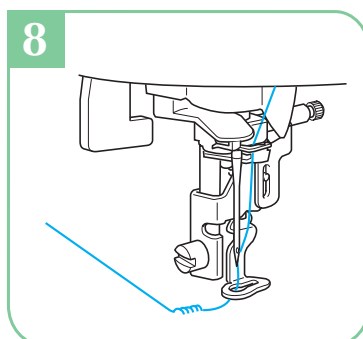
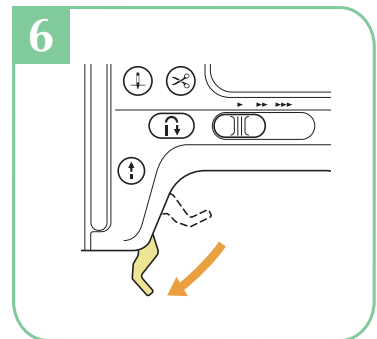
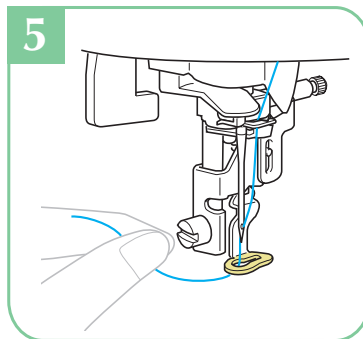
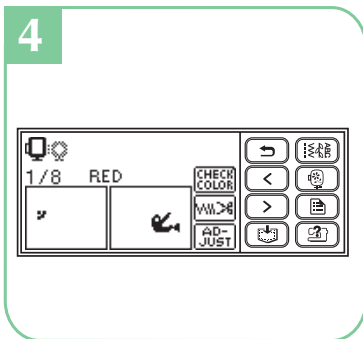
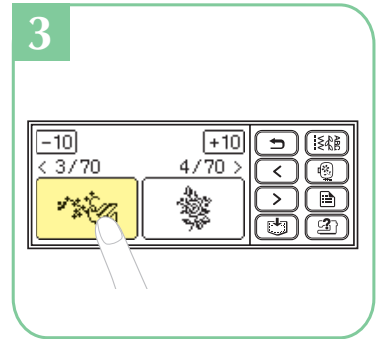
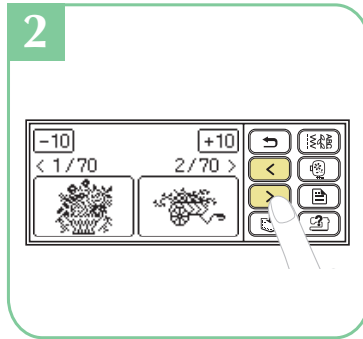
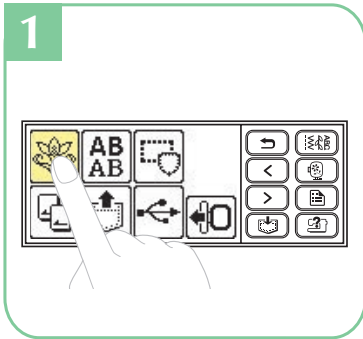

Selecting Embroidery Patterns

选择绣花花样

選擇刺繡花樣

자수 패턴 선택

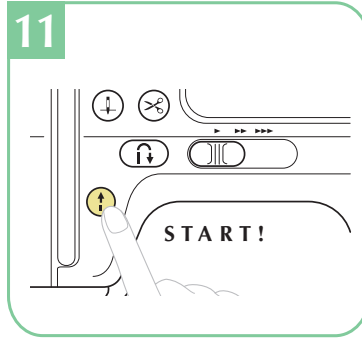
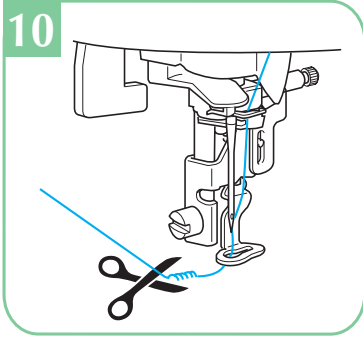

◆ Retrieving patterns from a USB flash drive (USB flash memory)

◆ 从U盘 (USB 闪存) 调用花样

◆ 自 USB 媒体 (随身碟) 取得花样

◆ USB 플래시 드라이브(USB 플래시 메모리)에서 패턴 불러오기

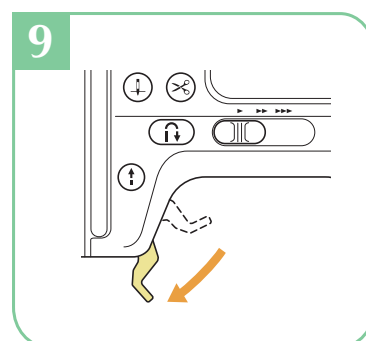
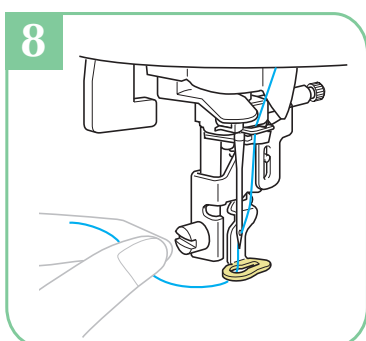
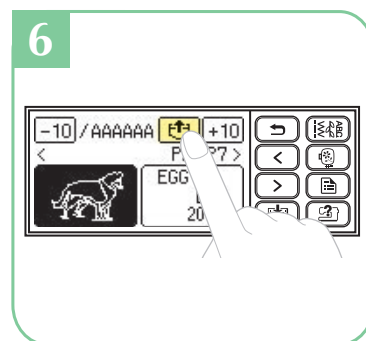
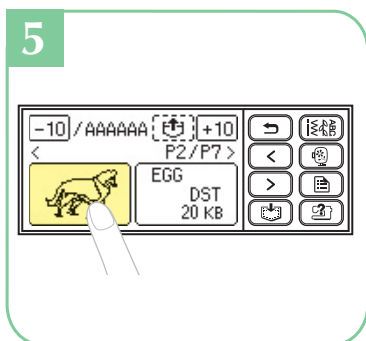
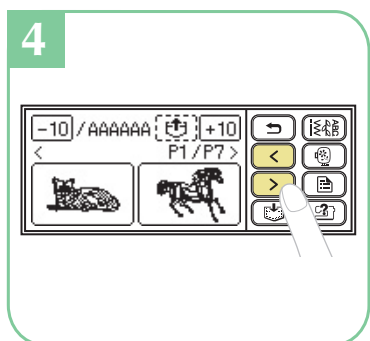
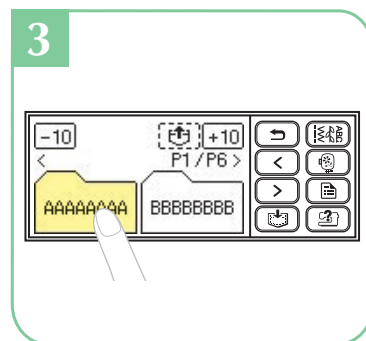
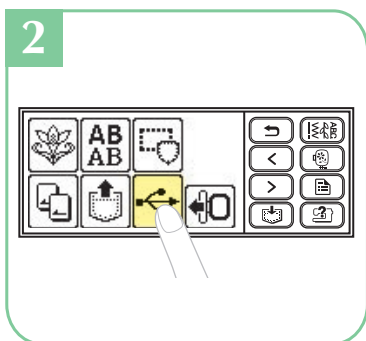
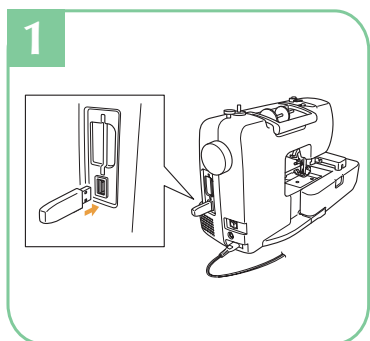

Selecting Embroidery Patterns

选择绣花花样

選擇刺繡花樣

자수 패턴 선택

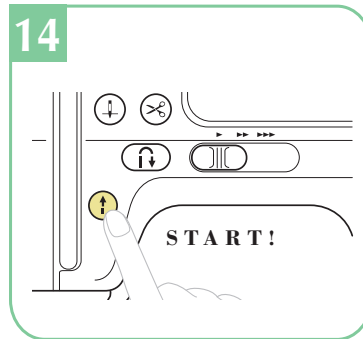
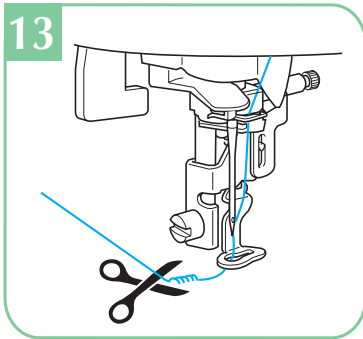
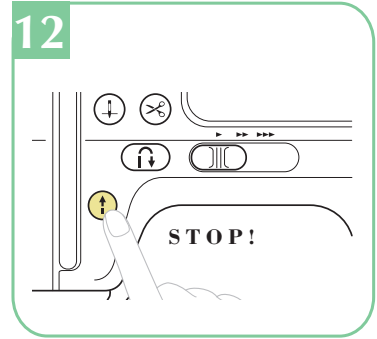
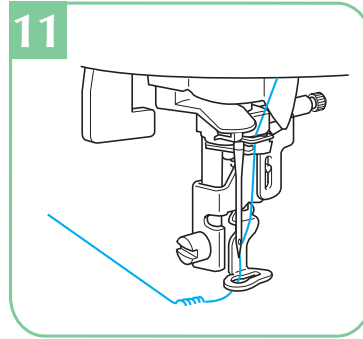
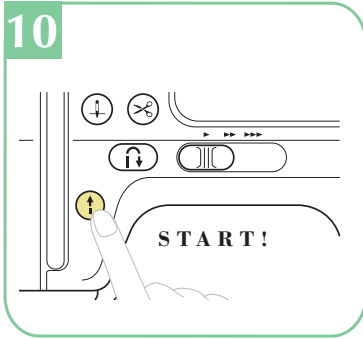

LCD Flow Chart

LCD 流程圖

- ◆ Embroidery Patterns
- ◆ 刺繡花樣

LCD流程图

LCD 선택순서

- ◆ 绣花花样
- ◆ 자수 패턴

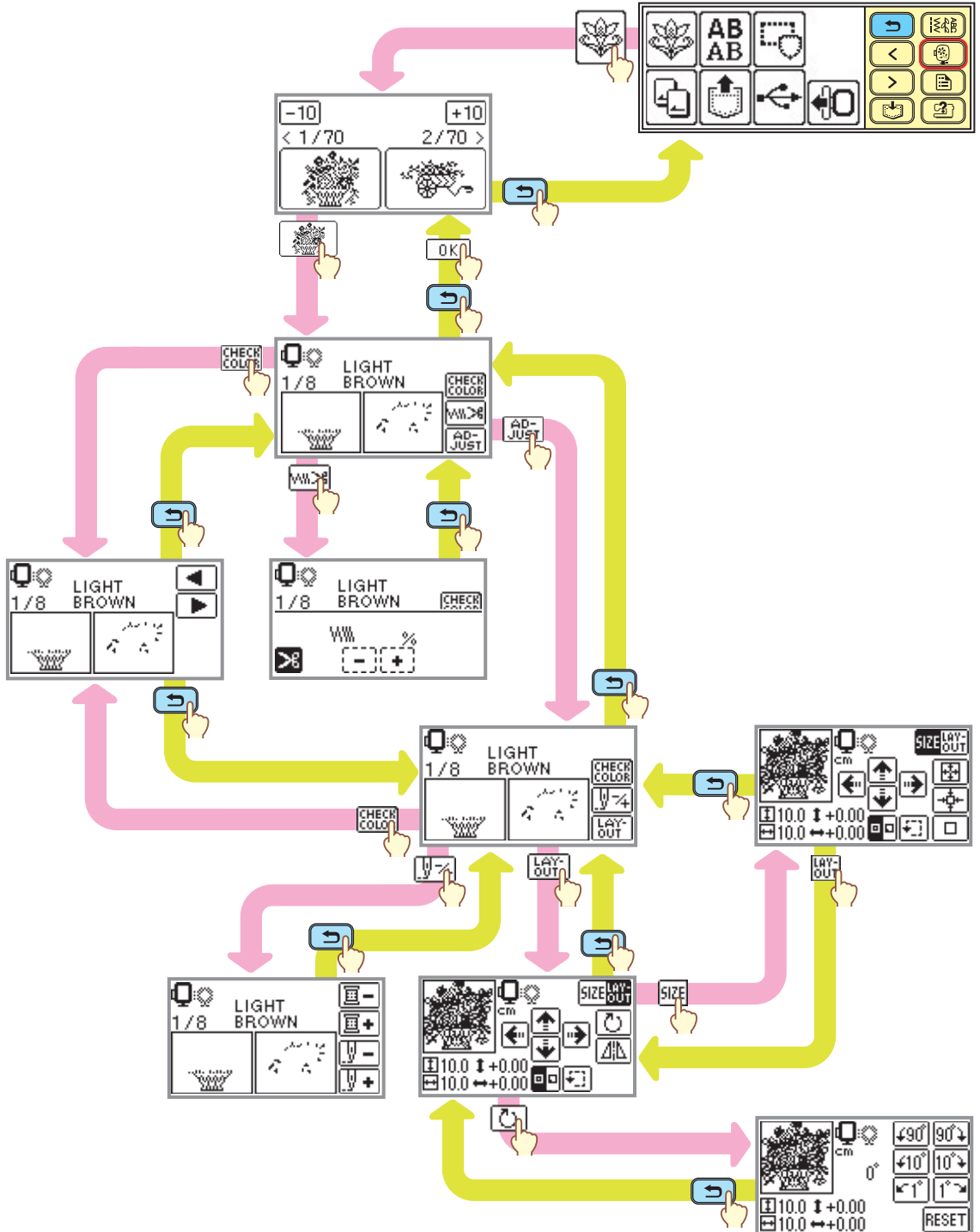

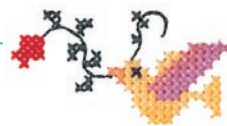

Selecting Embroidery Patterns
選擇刺繡花樣

选择绣花花样
자수 패턴 선택

- ◆ Other Patterns
- ◆ 其他花樣

- ◆ 其他花樣
- ◆ 기타 패턴

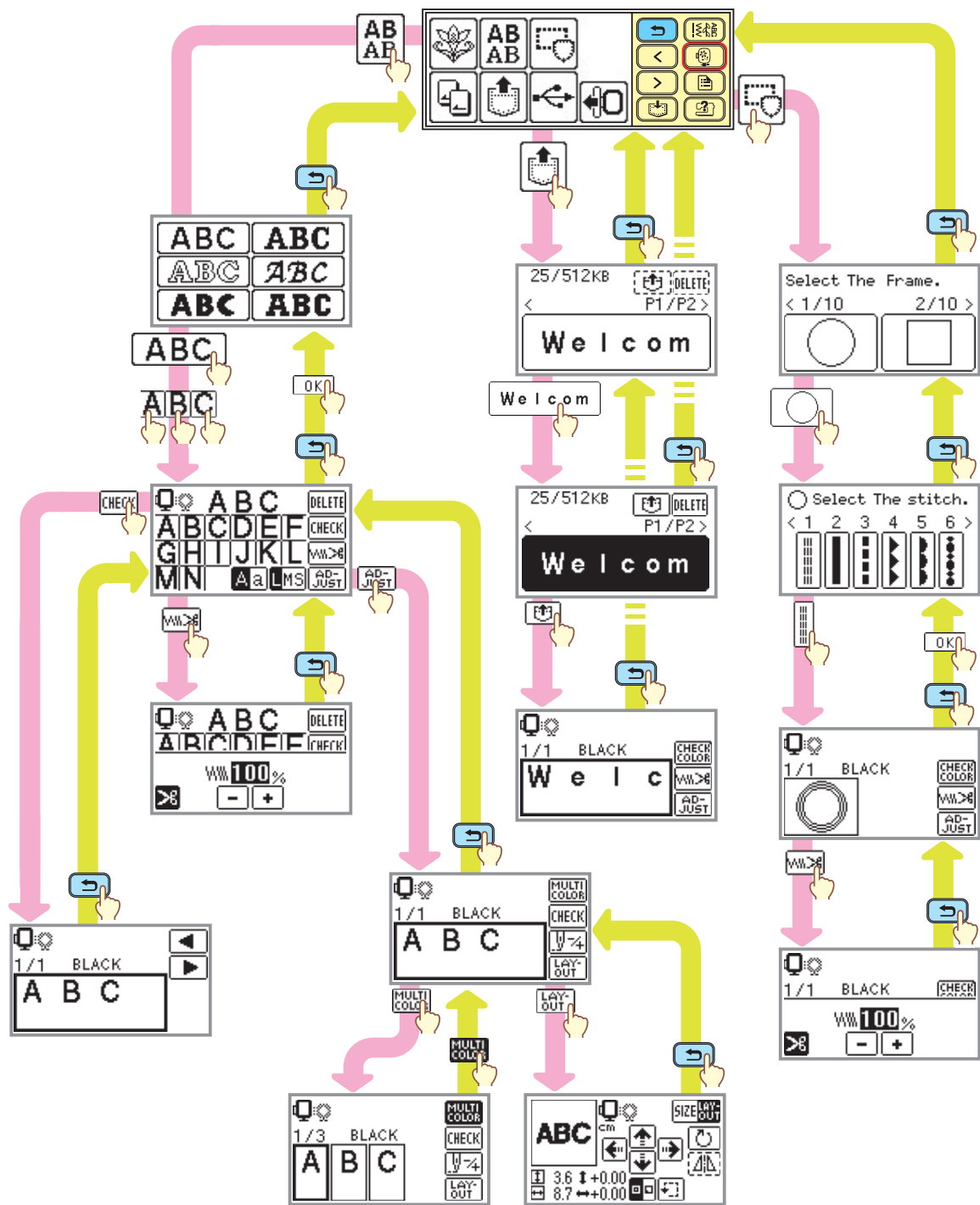

Alphanumeric Character Patterns

字母、数字花样

字母数字文字花樣

문자 패턴



AB
AB

ABC

A B C D E F G H I J K L M N O P Q R S
T U V W X Y Z
a b c d e f g h i j k l m n o p q r s
t u v w x y z
0 1 2 3 4 5 6 7 8 9
& ? ! - _ () ' . , /
Ä Å Ä Æ Ñ Ö Ø Ç Ü
ä à â â æ ë è é ê ñ ö ò ø ì ç ü ù ß

ABC

A B C D E F G H I J K L M N O P Q R S
T U V W X Y Z
a b c d e f g h i j k l m n o p q r s
t u v w x y z
0 1 2 3 4 5 6 7 8 9
& ? ! - _ () ' . , /
Ä Å Ä Æ Ñ Ö Ø Ç Ü
ä à â â æ ë è é ê ñ ö ò ø ì ç ü ù ß

ABC

A B C D E F G H I J K L M N O P Q R S
T U V W X Y Z
a b c d e f g h i j k l m n o p q r s
t u v w x y z
0 1 2 3 4 5 6 7 8 9
& ? ! - _ () ' . , /
Ä Å Ä Æ Ñ Ö Ø Ç Ü
ä à â â æ ë è é ê ñ ö ò ø ì ç ü ù ß



ABC
M



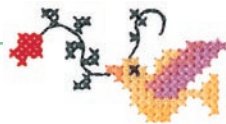

Alphanumeric Character Patterns

字母、数字花样
字母数字文字花樣
문자 패턴

ABC

A B C D E F G H I J K L M N O P Q R S
T U V W X Y Z
a b c d e f g h i j k l m n o p q r s
t u v w x y z
0 1 2 3 4 5 6 7 8 9
& ? ! - _ () ' . , /
Ä Å Ä Æ Ñ Ö Ø Ç Ü
ä å ä â æ ë è é ê ñ ö ò ø ì ç ü ù ß

ABC

A B C D E F G H I J K L M N O P Q R S
T U V W X Y Z
a b c d e f g h i j k l m n o p q r s
t u v w x y z
0 1 2 3 4 5 6 7 8 9
& ? ! - _ () ' . , /
Ä Å Ä Æ Ñ Ö Ø Ç Ü
ä å ä â æ ë è é ê ñ ö ò ø ì ç ü ù ß

ABC

A B C D E F G H I J K L M N O P Q R S
T U V W X Y Z
a b c d e f g h i j k l m n o p q r s
t u v w x y z
0 1 2 3 4 5 6 7 8 9
& ? ! - _ () ' . , /
Ä Å Ä Æ Ñ Ö Ø Ç Ü
ä å ä â æ ë è é ê ñ ö ò ø ì ç ü ù ß

Frame Patterns

框架花样

外框花樣

테두리 모양



■ Frame shapes
■ 外框形狀

■ 框架形状
■ 테두리 모양

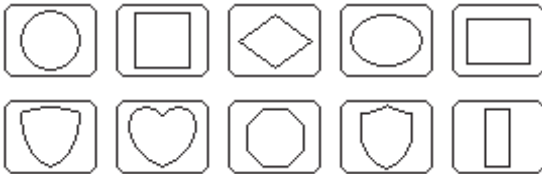

■ Stitches
■ 針趾

■ 针迹
■ 재봉 모양

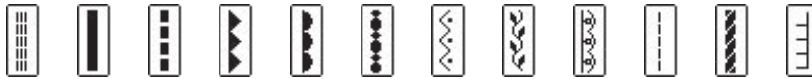

■ Sample at actual size
■ 實際大小的樣品

■ 真实尺寸样品
■ 실제 크기의 샘플

Sample combining  and  / 組合  和  的样品/

結合  和  的樣品/  및  을 조합한 샘플

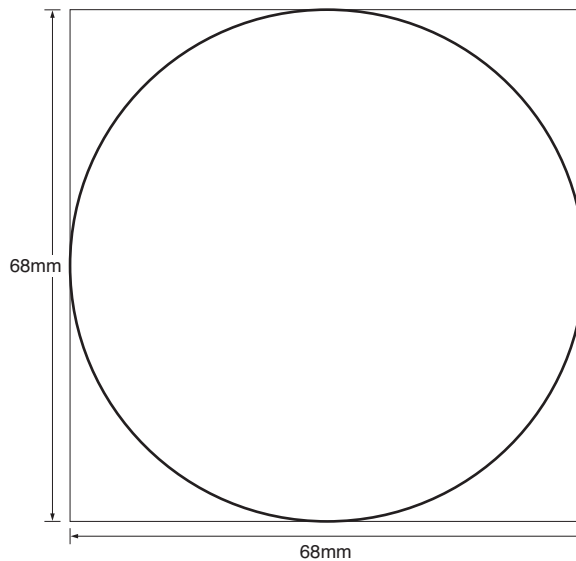

Embroidery Pattern Color Change Table

绣花花样颜色变换表

刺繡花樣顏色變換表

패턴 실 색상표



No.1 25 min

Time required for embroidering
绣花所需时间
刺繡所需時間
자수 시 소요 시간

Order to embroider
绣花顺序
刺繡順序
자수 순서

Embroidery thread color number
绣花颜色线编号
刺繡線顏色編號
자수 실 색상 번호

Embroidery size
绣花尺寸
繡花大小
자수 사이즈

Embroidery thread color
绣花线颜色
刺繡線顏色
자수 실 색상

1	(255)
2	(463)
3	(444)
4	(155)
5	(024)
6	(224)
7	(334)
8	(485)

↓10.0cm ↔10.0cm

COUNTRY



No.7 5 min

1	(476)
2	(126)
3	(024)
4	(122)

↓8.1cm ↔1.6cm

COUNTRY

No.2 10 min

1	(334)
2	(322)
3	(335)
4	(336)
5	(473)
6	(354)
7	(485)
8	(148)
9	(255)

↓4.8cm ↔9.4cm

COUNTRY

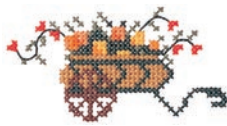

No.5 21 min

1	(126)
2	(155)
3	(152)
4	(122)
5	(625)
6	(624)
7	(623)
8	(476)
9	(485)
10	(463)
11	(461)
12	(446)
13	(444)
14	(354)
15	(404)
16	(370)
17	(126)
18	(636)
19	(224)
20	(476)

↓9.4cm ↔7.6cm

COUNTRY



No.8 23 min

1	(017)
2	(019)
3	(070)
4	(810)
5	(001)
6	(019)
7	(070)

↓9.4cm ↔9.4cm

No.3 3 min

1	(149)
2	(370)
3	(334)
4	(133)
5	(624)
6	(322)
7	(717)
8	(485)

↓2.8cm ↔5.4cm

COUNTRY



No.6 6 min

1	(588)
2	(000)
3	(126)
4	(024)
5	(255)
6	(354)
7	(586)

↓3.4cm ↔8.1cm

COUNTRY



No.10 6 min

1	(001)
2	(810)
3	(017)
4	(019)
5	(070)

↓4.1cm ↔6.3cm

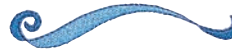

No.4 5 min

1	(024)
2	(152)
3	(444)
4	(473)
5	(623)

↓5.3cm ↔4.0cm

COUNTRY



No.11 21 min

1	(513)
2	(534)
3	(612)
4	(620)
5	(070)
6	(010)

↓9.6cm ↔8.6cm



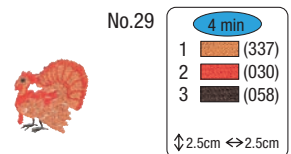
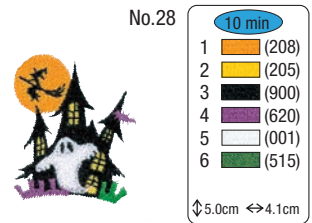
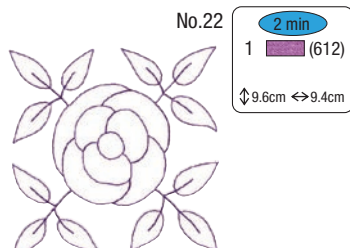
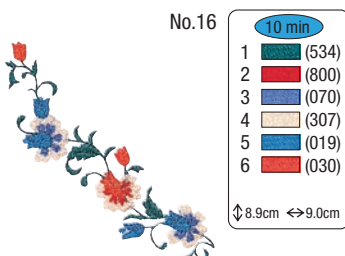
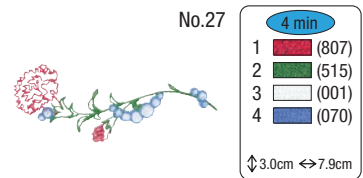
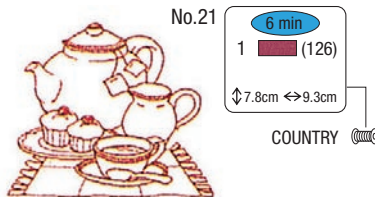
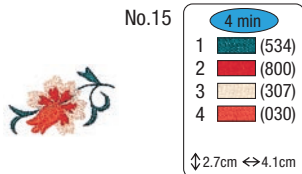
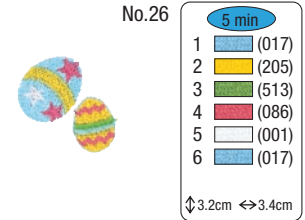
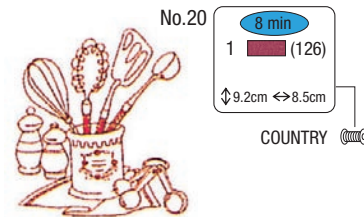
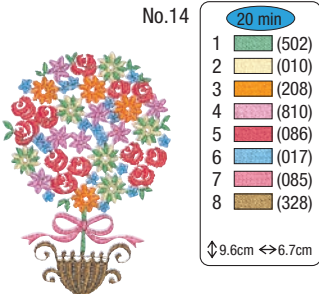
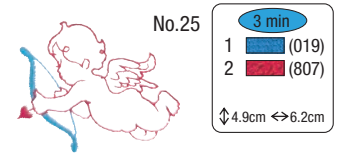
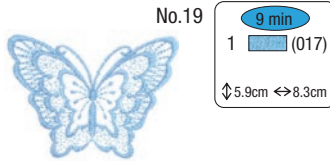
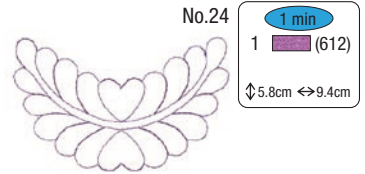
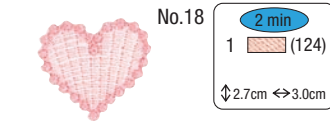
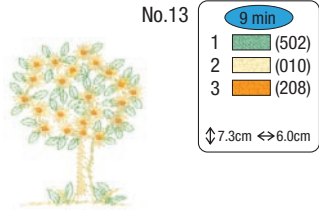
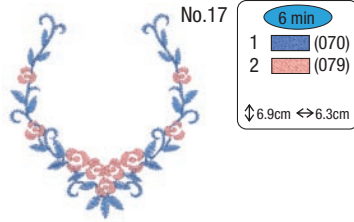
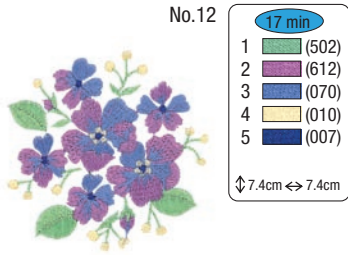

Embroidery Pattern Color Change Table

绣花花样颜色变换表
刺繡花樣顏色變換表
패턴 실 색상표

No.30



11 min

1	(800)
2	(007)
3	(307)
4	(399)
5	(900)
6	(017)
7	(001)
8	(800)

↓5.6cm ↔9.0cm

No.31



5 min

1	(800)
2	(515)
3	(017)
4	(124)
5	(206)

↓3.7cm ↔3.6cm

No.32



9 min

1	(586)
2	(025)
3	(473)
4	(242)
5	(224)
6	(255)
7	(747)

↓5.0cm ↔5.0cm

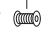
COUNTRY 

No.33



20 min

1	(513)
2	(001)
3	(323)
4	(800)
5	(017)
6	(810)
7	(900)
8	(513)
9	(001)
10	(323)
11	(019)
12	(070)
13	(900)
14	(058)
15	(502)
16	(704)
17	(900)

↓9.6cm ↔6.5cm

No.34



3 min

1	(001)
2	(307)
3	(707)

↓2.6cm ↔2.4cm

No.35



5 min

1	(001)
2	(323)
3	(010)
4	(900)

↓3.4cm ↔3.8cm

No.36



5 min

1	(001)
2	(843)
3	(707)
4	(900)

↓4.0cm ↔2.7cm

No.37



3 min

1	(001)
2	(405)
3	(017)
4	(800)

↓3.2cm ↔3.3cm

No.38



1 min

1	(800)
2	(017)
3	(339)

↓1.6cm ↔2.5cm

No.39



3 min

1	(704)
---	-------

↓2.3cm ↔3.0cm

★ No.40



3 min

1	---x (107)
2	--- (107)
3	~v~v~ (107)
4	(328)

↓4.9cm ↔4.8cm

No.41



5 min

1	(800)
2	(205)
3	(001)
4	(507)
5	(900)

↓2.4cm ↔5.7cm

No.42



2 min

1	(205)
2	(405)
3	(507)
4	(800)
5	(900)

↓2.4cm ↔5.8cm

★ No.43



7 min

1	---x (019)
2	--- (019)
3	~v~v~ (019)
4	(205)
5	(507)
6	(007)
7	(900)

↓5.6cm ↔5.7cm

★ No.44





17 min

1	---x (800)
2	--- (800)
3	~v~v~ (800)
4	(019)
5	(800)
6	(513)
7	(124)
8	(085)
9	(086)



↓6.2cm ↔6.2cm

★ Refer to the operation manual for the sewing machine for details on how to embroider appliqués.
★ 请参阅缝纫机使用说明书了解如何贴布绣花的详情。
★ 有關如何刺繡貼布的詳細資訊，請參閱縫紉機的說明書。
★ 아플리케 자수를 놓는 방법에 대해서는 재봉기의 사용설명서를 참조하십시오.





No.45  
 1  (070)
 ↓3.1cm ↔3.9cm

No.54  
 1  (070)
 ↓4.5cm ↔3.1cm



No.63  
 1  (070)
 ↓3.1cm ↔2.9cm



No.46  
 1  (070)
 ↓3.1cm ↔3.6cm

No.55  
 1  (070)
 ↓3.1cm ↔4.0cm



No.64  
 1  (070)
 ↓3.4cm ↔3.4cm

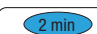

No.47  
 1  (070)
 ↓3.1cm ↔2.9cm

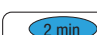

No.56  
 1  (070)
 ↓3.1cm ↔3.1cm



No.65  
 1  (070)
 ↓3.1cm ↔3.7cm



No.48  
 1  (070)
 ↓3.1cm ↔3.1cm



No.57  
 1  (070)
 ↓3.1cm ↔4.6cm



No.66  
 1  (070)
 ↓3.1cm ↔3.5cm



No.49  
 1  (070)
 ↓3.1cm ↔2.8cm

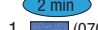

No.58  
 1  (070)
 ↓3.1cm ↔4.3cm



No.67  
 1  (070)
 ↓3.1cm ↔5.3cm

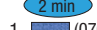

No.50  
 1  (070)
 ↓3.5cm ↔3.2cm

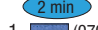
No.59  
 1  (070)
 ↓3.1cm ↔2.6cm



No.68  
 1  (070)
 ↓3.1cm ↔3.8cm

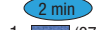

No.51  
 1  (070)
 ↓3.1cm ↔2.4cm



No.60  
 1  (070)
 ↓3.1cm ↔3.2cm

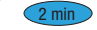

No.69  
 1  (070)
 ↓3.1cm ↔2.9cm

No.52  
 1  (070)
 ↓3.2cm ↔4.2cm

No.61  
 1  (070)
 ↓3.1cm ↔2.6cm

No.70  
 1  (070)
 ↓4.5cm ↔3.3cm

No.53  
 1  (070)
 ↓3.1cm ↔2.7cm

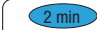
No.62  
 1  (070)
 ↓3.1cm ↔3.7cm



Color Thread Conversion Chart

彩线对照表

彩線對照表

컬러 실 변환 차트



	Color Name	Embroidery	Country	Madeira Polyneon	Madeira Rayon	Sulky Rayon	R.A. Polyester
1	Black / 黑色 / 黒 / 검정색	900	100	1800	1000	1005	5596
2	White / 白色 / 白 / 흰색	001	000	1801	1002	1001	5597
3	Red / 红色 / 紅 / 빨강색	800	149	1637	1037	1037	5678
4	Pink / 粉红色 / 粉 / 핑크색	085	155	1921	1108	1224	5523
5	Deep Rose / 深玫红 / 深玫瑰 / 담홍색	086	024	1721	1117	1154	9168
6	Flesh Pink / 肉粉色 / 淡粉 / 연핑크	124	152	1915	1015	1064	5677
7	Dark Fuchsia / 深紫红 / 深桃红 / 어두운 핑크	107	126	1984	1383	1533	5804
8	Vermillion / 朱红色 / 朱紅 / 주홍색	030	148	1779	1179	1184	9023
9	Carmine / 洋红色 / 胭脂红 / 진홍색	807	158	1986	1081	1511	5561
10	Royal Purple / 蓝紫色 / 皇家紫 / 청자주	869	636	1788	1188	1192	5681
11	Magenta / 品红 / 紅紫 / 자홍색	620	625	1710	1319	1191	5592
12	Salmon Pink / 橙红色 / 橙紅 / 밝은 주황	079	122	1816	1317	1225	5773
13	Amber Red / 琥珀红 / 琥珀紅 / 짙은 적갈색	333	212	1942	1341	1119	5591
14	Lemon Yellow / 柠檬黄 / 檸檬黃 / 레몬색	202	342	1623	1023	1067	5625
15	Yellow / 黄色 / 黃 / 노란색	205	043	1980	1068	1187	5860
16	Harvest Gold / 金黄色 / 金 / 황금색	206	334	1971	1024	1124	5770
17	Orange / 橙色 / 橘 / 주황색	208	335	1951	1137	1024	5694
18	Pumpkin / 南瓜色 / 南瓜色 / 호박색	126	322	1952	1155	1065	5630
19	Tangerine / 橘子色 / 蜜桔橘 / 다홍색	209	336	1965	1078	1078	5518
20	Cream Brown / 乳褐色 / 奶油棕 / 담황색	010	331	1866	1022	1061	5761
21	Cream Yellow / 乳黄色 / 奶油黃 / 연노랑	812	370	1861	1349	1135	5564
22	Khaki / 卡其色 / 卡其色 / 카키색	348	242	1939	1255	1055	5636
23	Deep Gold / 深黄色 / 深金 / 황토색	214	354	1772	1172	1025	5770
24	Brass / 黄铜色 / 黃銅色 / 황동색	328	404	1791	1192	1159	9109
25	Linen / 亚麻色 / 亞麻色 / 샨색	307	025	1682	1149	1082	5635
26	Dark Brown / 深褐色 / 深棕 / 암갈색	058	717	1859	1130	1129	5637
27	Reddish Brown / 红褐色 / 紅棕 / 적갈색	337	264	1753	1253	1021	5781
28	Clay Brown / 土棕褐色 / 土棕褐 / 흙갈색	339	224	1621	1021	1158	5590
29	Beige / 米黄色 / 米色 / 베이지색	843	012	1738	1138	1127	5598
30	Warm Gray / 暖灰色 / 暖灰 / 연회색	399	706	1860	1085	1218	9126
31	Russet Brown / 赤褐色 / 黃褐棕 / 황갈색	330	414	1726	1194	1126	5702
32	Light Brown / 浅棕色 / 淺棕 / 연갈색	323	255	1729	1056	1128	5789
33	Seacrest / 蓝绿色 / 靑瓷色 / 청자색	542	505	1647	1219	1077	5578
34	Mint Green / 薄荷绿 / 薄荷綠 / 민트 그린	502	461	1702	1302	1047	5511
35	Leaf Green / 叶绿色 / 黃 / 연녹색	509	463	1749	1050	1510	5514
36	Olive Green / 橄榄绿 / 橄欖綠 / 올리브 그린	519	476	1904	1396	1174	5502
37	Dark Olive / 深橄榄色 / 暗橄欖綠 / 암녹색	517	473	1769	1156	1156	9122
38	Teal Green / 青绿色 / 深靑綠 / 청녹색	534	483	1879	1298	1503	5751
39	Emerald Green / 翡翠绿 / 鮮綠 / 선녹색	507	485	1750	1250	1079	5508
40	Deep Green / 深绿色 / 深綠 / 진녹색	808	467	1703	1370	1208	5615



	Color Name	Embroidery	Country	Madeira Polyneon	Madeira Rayon	Sulky Rayon	R.A. Polyester
41	Fresh Green / 嫩绿色 / 青綠 / 연두색	027	442	1706	1102	1209	9153
42	Lime Green / 亮绿色 / 萊姆綠 / 황녹색	513	444	1848	1049	1177	5622
43	Moss Green / 苔绿色 / 苔蘚綠 / 초록색	515	446	1770	1369	1176	9091
44	Blue / 蓝色 / 藍 / 파랑색	405	586	1829	1177	1076	5684
45	Ultra Marine / 深蓝色 / 群青色 / 군청색	406	575	1842	1076	1042	5736
46	Light Blue / 浅蓝色 / 淡藍 / 밝은 파랑	017	150	1932	1132	1074	5683
47	Sky Blue / 天蓝色 / 天藍 / 하늘색	019	512	1828	1029	1196	5506
48	Electric Blue / 铁蓝色 / 鋼青色 / 감청색	420	564	1797	1297	1250	5829
49	Peacock Blue / 孔雀藍 / 孔雀藍 / 남색	415	057	1652	1252	1206	5810
50	Prussian Blue / 普魯士藍 / 普魯士藍 / 감청색	007	588	1767	1166	1535	5737
51	Cornflower Blue / 矢車菊藍 / 矢車菊藍 / 청보라색	070	015	1830	1335	1028	5601
52	Light Lilac / 浅紫色 / 淺紫 / 연보라색	810	133	1911	1031	1121	9016
53	Lilac / 淡紫色 / 雪青 / 엷은 자색	612	623	1831	1080	1080	9009
54	Violet / 紫罗兰 / 紫羅蘭色 / 보라색	613	624	1631	1033	1194	5588
55	Purple / 紫色 / 紫 / 자주색	614	635	1880	1122	1122	5554
56	Lavender / 薰衣草淡紫 / 薰衣草紫 / 연자주색	804	604	1630	1261	1193	5586
57	Wisteria Violet / 紫藤紫 / 紫藤紫 / 청보라	607	003	1943	1311	1032	5587
58	Pewter / 青灰色 / 沙電色 / 회색	704	745	1840	1041	1041	9114
59	Dark Gray / 深灰色 / 深灰 / 암회색	707	747	1841	1241	1220	5565
60	Silver / 银色 / 銀 / 은색	005	020	1812	1087	1011	5640
61	Gray / 灰色 / 灰 / 회색	817	734	1640	1118	1219	5782
62	----->X						
63	-----						
64	~~~~~						
65	NOT DEFINED / 未定义 / 未定義 / 정의되지 않음						

Note: The conversion chart is based on Embroidery thread. The color shades may vary with the different brands listed on the chart. If unsure of a particular color(s), please sew test. Robison Anton (R.A.), Isacord, Madeira, Sulky and Gütermann are respectively registered trademarks. Actual colors may vary slightly from the chart.

备注: 本转换表以绣花线为基准。根据表中所列的品牌不同，可能会有色差。如果对于某个特定颜色不确定时，请先进行试绣。Robison Anton (R.A.), Isacord, Madeira, Sulky与Gütermann分别为注册商标。实际的颜色可能会与表中所示的颜色略有不同。

注意: 本对照表是根据刺繡線而定。顏色可能會與表中所列的不同品牌而有不同。若不確定特定顏色，請進行縫紉測試。Robison Anton (R.A.)、Isacord、Madeira、Sulky 和 Gütermann 各自為註冊商標。實際顏色與對照表可能稍有不同。

참고: 변환 차트는 자수 실을 기준으로 합니다. 색조는 차트에 나열된 브랜드에 따라 다를 수 있습니다. 특정 색상을 알 수 없는 경우에는 시험 재봉을 해 보십시오. Robison Anton (R.A.), Isacord, Madeira, Sulky 및 Gütermann은 각각 등록 상표입니다. 실제 색상은 차트와 약간 다를 수 있습니다.



English
Chinese-simp
Chinese-trad
Korean
885-V95/V96/V97/V98
Printed in China



XF0268-101①