

brother®

MPRINT

Quick Reference Guide

MW-145BT
Mobile Printer

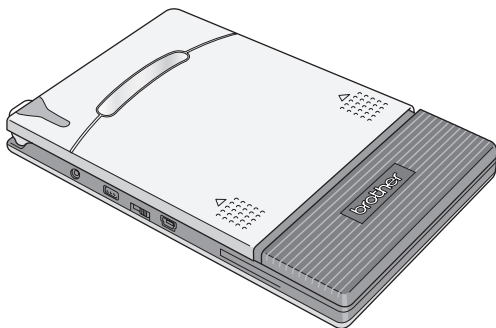

CE

Before using this printer, be sure to read this Quick Reference Guide.

www.brother.com

CAUTION

RISK OF EXPLOSION IF BATTERY IS REPLACED BY AN
INCORRECT TYPE.

DISPOSE OF USED BATTERIES ACCORDING TO THE
INSTRUCTIONS.

Trademarks

The Brother logo is a registered trademark of Brother Industries, Ltd.

Brother is a registered trademark of Brother Industries, Ltd.

© 2009 Brother Industries, Ltd.

Microsoft, Windows, Windows Mobile and Windows Vista are registered trademarks of Microsoft Corporation in the United States and other countries.

The Bluetooth word mark and logos are owned by the Bluetooth SIG, Inc. and any use of such marks by Brother Industries, Ltd. under license.

All other software and product names mentioned are trademarks or registered trademarks of their respective companies.

For the latest information and updates on the Brother mobile printer feature, visit <http://solutions.brother.com>.

Manual structure

A User's Guide and a Software User's Guide are provided on the CD-ROM included with this printer.

Read the User's Guide before operating the printer.

It is recommended you save the User's Guide onto your Windows® PC for future reference.

User's Guide

The User's Guide provides precautions for using this printer, details on the printer's setup, the procedures for installing and uninstalling the software onto a Windows® PC or onto a Windows Mobile® device.

Software User's Guide

The Software User's Guide describes how to use the software for Windows® PC or Windows Mobile® device and their printing procedures.

Enclosed accessories

MW-145BT mobile printer

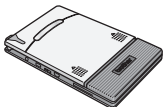

USB cable



Paper cassette

filled with C-11 thermal paper (50 sheets).



AC adapter (AD-210AUS/AD-210UK)

Brother Industries, Ltd.



(Powerplug may vary by country.)

CD-ROM

(contains the software, the User's Guide and the Software User's Guide)

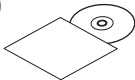

Lithium ion Rechargeable battery pack

(BT-100)
Brother Industries, Ltd.



Quick Reference Guide

(This guide)



Getting Started

Installing the battery

Danger



Do not use this printer with any rechargeable battery other than that specified (BT-100), otherwise a fire or damage may result.



- DO NOT take off the black plastic that covers the battery.
- The battery connector should not be unnecessarily unplugged and reconnected, otherwise it may become damaged or the battery cord may break.
The battery should only be removed when replacing it at the end of its service life, or when the printer will not be used for a long period of time.

1 Press the area indicated ① on the battery cover ② and slide it off the MW-145BT.

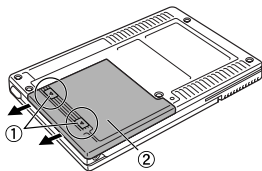

2 Insert the connector ① of the battery ② in the direction shown right.

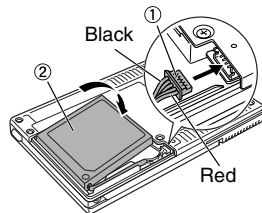

- Insert the connector fully, without using excessive force.
- Be sure you insert the connector in the correct orientation, otherwise it may be damaged.

- 3** Fit the battery cord into the groove as shown in the illustration.

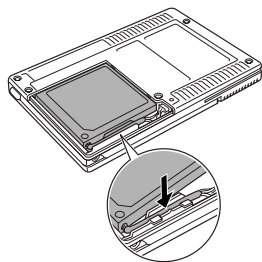

- 4** Install the battery cover by sliding it onto the back of the MW-145BT.

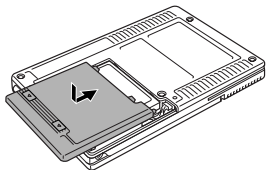

Be careful that you do not catch the battery connector cord.

Charging

Use the AC adapter designed specifically for this printer to charge the battery.

After unpacking this printer, be sure to charge the battery fully before using it.

1 Plug the AC adapter cable into the printer.

2 Plug the AC adapter plug into a household electrical outlet (AC 220 V - 240 V).

Charging of the lithium ion battery automatically begins.

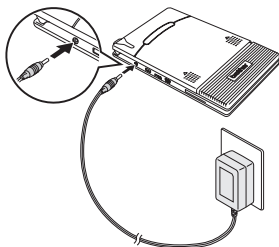

The plug may differ by country.

- The orange charging LED is lit.
- When charging is completed, the charging LED goes off.



- It takes approximately three hours for the battery to be recharged from completely empty to fully charged (with the printer turned off).
- Recharge the battery in an environment where the temperature is between 5 °C and 40 °C. (The battery will not recharge if the ambient temperature is outside of this range.)

3 After charging is finished, disconnect the AC adapter.



The MW-145BT cannot be operated solely with the AC adapter. The rechargeable battery must be installed.

■ Charging LED (Orange)

With the charging LED, the status of the power supply can be checked.

The charging LED has two functions.



- (1) Checking the charging status (when the AC adapter is connected)

LED status	Printer status
Constantly lit	Charging
Off	Finished charging
Flashing	Malfunctioning battery

- (2) Checking the battery level (while running off the lithium ion battery)

LED status	Battery level
Off	More than 60% charged
Flashes once	Less than 60% charged
Flashes twice	Less than 30% charged
Continues to flash 3 times	Almost empty



- Please try to discharge the battery completely before recharging it, to increase battery life.
- If the charging LED flashes while the printer is printing, immediately connect the AC adapter and charge the battery. The printer may stop printing.
- Due to the characteristics of batteries, even though the battery is fully charged, using the MW-145BT in low temperatures greatly reduces the number of prints possible.
- In order to maintain the efficiency and life of the rechargeable battery, remove the AC adapter from the printer when charging is complete.
- In order to maintain the efficiency and life of the rechargeable battery, do not place or use the printer in direct sunlight, near heaters or other hot appliances, or any other location where temperatures are extremely high (e.g. on the dashboard or in the back of your car).

Turning the printer on/off

Press and hold the power button for a short while, until the green or blue status LED illuminates.

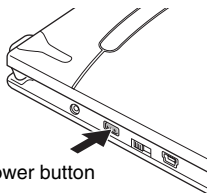

- When the printer is turned on, the status LED is:
Green (if Bluetooth is switched off)
Blue (if Bluetooth is switched on)



In order to prevent this printer from accidentally being turned on, it will not come on if the power button is lightly pressed.

Preparing the paper cassette

Use only the paper cassette designed exclusively for this printer. Use of any other paper will result in damage.

Prepare the paper cassette before installing it into the printer.

- 1** **Firmly** fold the lid back along the fold (①).

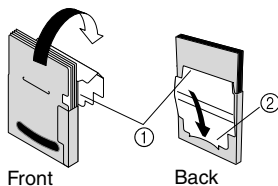

Make sure that the lid is firmly folded, otherwise a paper misfeed may result.

- 2** Insert the tab on the lid into the slit (②) at the back of the cassette.

Installing the paper cassette

- 1** Slide the paper cassette cover (on the top of the printer) in the direction shown in ①.

→ The paper cassette cover will open in the direction indicated by ②.

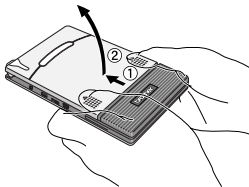

- 2** Insert the paper cassette.

The paper type indication on the paper cassette should face up. The end of the paper should point toward you.

Paper type indication

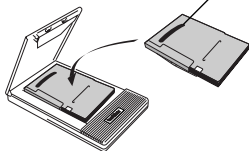

- 3** Close the paper cassette cover in the direction shown in ③.

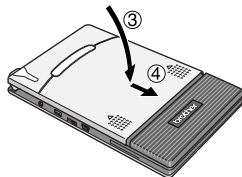

- 4** Slide the paper cassette cover in the direction shown in ④.

If the paper cassette is correctly loaded, the paper type indication on the cassette can be seen through the paper check window, and the paper cassette cover will be locked.

Paper check window

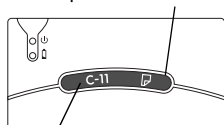

Paper type indication

■ If the paper is not fed correctly

Clean the pick-up roller.

1 Open the paper cassette cover.

2 Rotate the pick-up roller in the feed direction until it stops.

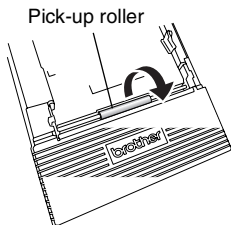

3 Attach a piece of cellophane tape to the rubber pick-up roller.

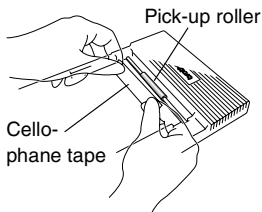

4 Remove the cellophane tape, and turn the pick-up roller 3 to 4 mm in the opposite direction of the feed direction.

→ Any dirt on the pick-up roller is removed with the tape.

5 Repeat steps 3 and 4 until the pick-up roller is clean.

Europe Only

brother

Declaration of Conformity

We, BROTHER INDUSTRIES, LTD.
15-1, Naeshiro-cho, Mizuho-ku,
Nagoya, 467-8561, Japan

declare that this product is in compliance with the essential requirements and other relevant provisions of Directives 1999/5/EC and 2005/32/EC.

The Adapter AD-210 is in compliance with the essential requirements and other relevant provisions of Directive 2006/95/EC.

The Declaration of Conformity (DoC) is on our Web site. Please go to <http://solutions.brother.com> -> choose region (eg. Europe) -> choose country -> choose your model -> choose "Manuals"-> choose Declaration of Conformity (*Select Language when required).

brother®

Printed in Japan
LBA244001

