



PT-D200/E200

User's Guide

English

Thai

With your PT-D200/E200, you can create labels for multiple applications. Select from the many frames, character sizes and styles to design beautiful custom labels. In addition, the variety of tape cartridges available allows you to print labels with different widths and exciting colors.

Read this manual carefully before starting and keep the manual in a handy place for future reference.

Printed in China
LAG435001

Safety Precautions

WARNING Indicates a potentially hazardous situation which, if not avoided, could result in death or serious injuries.

Follow these guidelines to avoid the risk of fire, burns, injury, electric shocks, rupture, overheating, abnormal odours or smoke.

- Always use the specified voltage and the suggested AC adapter (AD-24ES: Optional on the PT-D200) for the P-touch labeler to prevent any damage or failure.
- Do not touch the P-touch labeler during a lightning storm.
- Do not use the P-touch labeler/AC adapter in places of high humidity such as bathrooms.
- Do not overload the power cord.
- Do not place heavy objects on, or damage the power cord or plug. Do not forcibly bend or pull the power cord. Always hold the AC adapter when disconnecting from the power outlet.
- Make sure that the plug is fully inserted to the power outlet. Do not use an outlet that is loose.
- Do not allow the P-touch labeler/AC adapter/power plug/batteries to get wet, for example, by handling them with wet hands or spilling beverages on to them.
- Do not use sharp objects, such as tweezers or a metallic pen, to change the batteries.
- Do not throw the batteries into fire or expose to heat.
- Disconnect the AC adapter and remove batteries immediately and stop using the P-touch labeler if you notice abnormal odor, heat, discoloration, deformation or anything unusual while using or storing it.
- Do not use a damaged or leaking battery as the fluid may get on your hands.
- Do not use a deformed or leaking battery or one whose label is damaged. There is a possibility of generating heat.
- Do not disassemble or modify the P-touch labeler/AC adapter/batteries.
- Do not allow a metal object to contact both the plus and minus ends of a battery.
- Do not use sharp objects, such as tweezers or a metallic pen, to change the batteries.
- Do not throw the batteries into fire or expose to heat.
- Disconnect the AC adapter and remove batteries immediately and stop using the P-touch labeler if you notice abnormal odor, heat, discoloration, deformation or anything unusual while using or storing it.
- Do not use a damaged or leaking battery as the fluid may get on your hands.
- Do not use a deformed or leaking battery or one whose label is damaged. There is a possibility of generating heat.

CAUTION

Indicates a potentially hazardous situation which, if not avoided, may result in minor or moderate injuries.

Follow these guidelines to avoid personal injury, liquid leakage, burns or heat.

- When the P-touch labeler is not being used, store it out of the reach of children. In addition, do not allow children to put the P-touch labeler parts or labels in their mouths. If any object has been swallowed, seek medical attention.
- Do not touch metal parts around the print head immediately after printing.
- Do not touch the cutter blade.
- Leaked fluid from batteries gets on your skin or clothes, immediately rinse them with clean water.
- Remove the batteries and disconnect the AC adapter if you do not intend to use the P-touch labeler.
- Do not use a battery other than that specified. Do not use combinations of old and new batteries or combinations of different types, different charging levels, different manufacturers or different models. Do not insert a battery with its plus and minus ends reversed.
- Do not drop or hit the P-touch labeler/AC adapter.
- Do not press on the LCD display.
- Do not put your finger inside the P-touch labeler when you close the cassette cover.
- Before using Ni-MH rechargeable batteries, carefully read the instructions for the batteries and battery charger, and be sure to use them correctly.
- When using Ni-MH rechargeable batteries, charge the batteries with a specialized battery charger before using the batteries.

General Precautions

- Depending on the location, material, and environmental conditions, the label may unpeel or become immovable, the color of the label may change or be transferred to other objects. Before applying the label, check the environmental conditions and the material.
- Do not use the P-touch labeler in any way or for any purpose not described in this guide. Doing so may result in accidents or damage the P-touch labeler.
- Use only Brother TZe tapes with the P-touch labeler. Do not use tapes that do not have the mark.
- Only use a soft, dry cloth to clean the labeler; never use alcohol or other organic solvents.
- Use a soft wipe to clean the print head, never touch the print head.
- Do not put any foreign objects into the tape exit slot or AC adapter connector or battery compartment, etc.

- Do not place the P-touch labeler/batteries/AC adapter in direct sunlight or near heaters or other hot appliances, in any location exposed to extremely high or low temperatures (e.g., on the dashboard or in the back of your car) or high humidity, or in dusty locations.
- Do not apply excessive pressure to the cutter lever.
- Do not try to print if the cassette is empty; it will damage the print head.
- Do not pull the tape while printing or feeding; it will damage the tape and the P-touch labeler.
- Any data stored in memory will be lost due to failure or repair of the P-touch labeler, or if the battery expires.
- The P-touch labeler is not equipped with a charging feature for rechargeable batteries.
- The printed text may differ from the text that appears in the LCD.
- The length of the printed label may differ from the displayed label length.
- A protective clear plastic sticker if placed over the display during manufacturing and shipping. This sticker should be removed prior to use.
- When power is disconnected for more than three minutes, all text, format settings and any text files stored in the memory will be cleared.

Contact information

Contact may differ by country.
See the Web site. (<http://www.P-touch.com/>)

BASIC USAGE

Entering Text

Switching the character for entry[English/Thai]

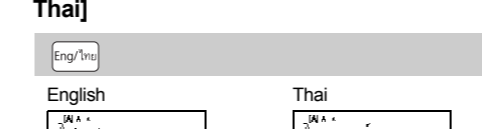

Switching Upper Case/Lower Case

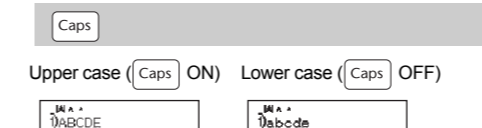

Making Two Lines Text

Move the cursor to where the second line starts and press . Use either 9mm or 12mm wide tape to two line text.

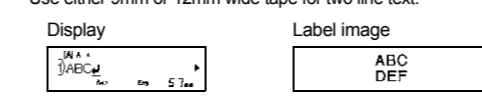

Entering Tab



To change tab length:

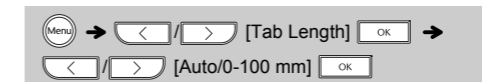

Changing Label Length

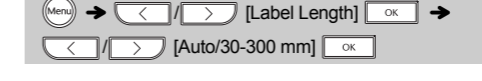

NOTE

- After the label is printed, cut along the printed dots (.) with scissors so that the label length matches the machine setting.
- If a specific label length has been selected, also appears in the LCD.

To Clear

By pressing , the letters will be deleted one by one.

To delete all text and settings :



To delete text only :



Printing Labels

Preview

You can preview the text before printing.

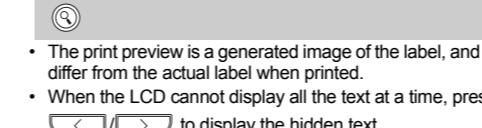

Feeding (Tape Feed)



Printing



- If you need only 1 copy of the label, press without selecting the number of copies.
- The number of copies can also be specified by pressing a number key.
- To prevent damage to the tape, do not touch the cutter lever while the message "Printing..." or "Feeding..." is displayed.
- To cut off the label, push in the tape cutter lever on the upper-right corner of the machine.
- To remove the backing, fold the label lengthwise with the text facing inward, to expose the inside edges of the backing. Peel off the backing one piece at a time and apply.
- You can print up to 9 copies of each label.

Using Print Options

[Numbering]
You can print many copies of the same text while increasing a selected number by 1 after each label is printed.
Example: To print copies of a label containing a serial number (0123, 0124 and 0125)

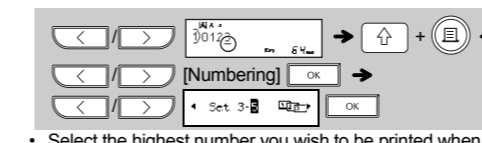

- Select the highest number you wish to be printed when setting the number.
- You can also print Thai numbers the same as above by entering Thai numbers.

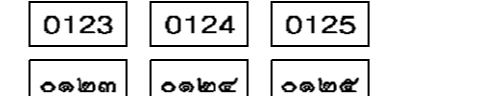

[Mirror]

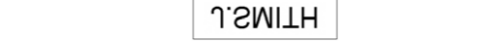

Saving Label Files

You can save up to 9 labels and recall them for printing at a later date. A maximum of 80 characters can be saved per file, a maximum total of 720 characters for the total memory. You can also edit and overwrite the stored label.

Save

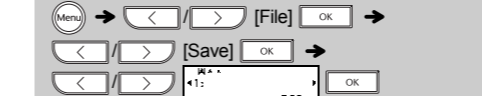

Print



Open

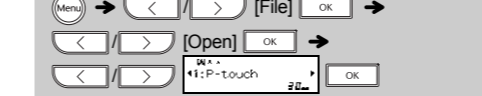

You can also enter the File menu by pressing .

NOTE

- If you try to store a label when there is already a label stored to that number, a message "Overwrite?" will appear. Press to save your new label. Press to cancel.

USING TEMPLATES

Name Label

This function allows you to create various name labels using the built-in templates.

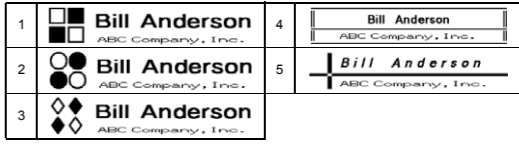
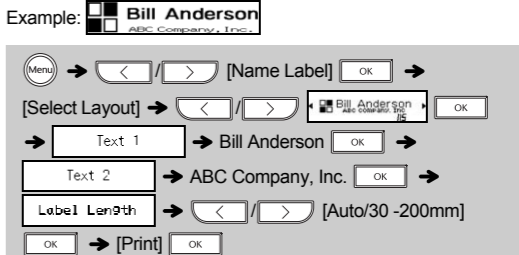

NOTE

- Depending on the format you have selected, the entire contents of your text may not be printed. For example, if you selected a fixed Label Length and the text is too long, an error message "Text Limit" will appear.
- The templates cannot be edited.

To clear all text, press and , then "Clear?" appears.

Press to clear. Press to cancel.

When you access Decorative Mode or Name Label function, your most recently printed Decorative Mode or Name Label function text and label length will be recalled.

Press to return to the previous step.

Only the highlighted symbols on the enclosed insertion sheet can be used in Decorative Mode.

USEFUL FUNCTION KEYS

Font Key

1 Press to select the settings to enter the text.



2 Press to select the settings.

Size	Large	Medium	Small
Width	Normal	× 2	× 1/2
Style	Normal	Bold	Outline
	Shadow	Solid	Italic
	I+Bold	I+Outline	I+Shadow
	Vertical (English only)		

NOTE

To cancel operations, press .

Frame Key

Press to select the frame design. Refer to the frame design table on the enclosed insertion sheet.



NOTE

- To cancel operations, press .
- Frames cannot be printed on 3.5mm tape.

Symbol Key

Press to select various symbols. Refer to the table of symbols on the enclosed insertion sheet.

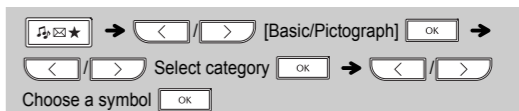

NOTE

To cancel operations, press .

Decorative Mode

This function allows you to create unique labels by using built-in templates.

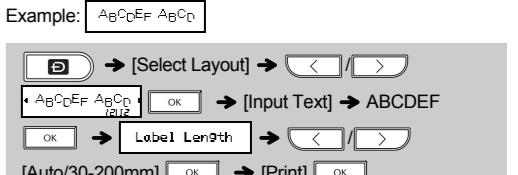

NOTE

- To exit the Decorative Mode or Name Label function and return to the text input screen, do one of the following:

a) Press .

b) Press to select [Cancel], and then press when "Print" appears.

- These features are only available when using 12mm wide tape cassettes.

- The maximum label length is 200mm for Decorative Mode and Name Label function.

- When [Auto] is selected for "Label Length", the label will automatically adjust to the correct length for printing the text one time.

- Press to return to the [Auto] setting for "Label Length" mode.

Resetting the P-touch

You can reset the P-touch labeler when you want to initialize the settings, or in the event the P-touch labeler is not working properly.

1 Turn off the P-touch labeler, hold down and and then press to turn the P-touch back on.

2 Release and .

The P-touch labeler turns on with the internal memory reset.

NOTE

All text, settings and stored files are cleared.

Accessories

Tape Cassettes: See the included "TAPE GUIDE".

AC Adapter: AD-24ES (Optional on the PT-D200)

Cutter Unit: TC-4 (replacement)

If the cutter blade becomes blunt after repetitive use and the tape cannot be cut cleanly, replace with new cutter unit (stock no. TC-4) by obtaining from an authorized Brother reseller.

Replacing the Cutter Unit

1. Pull out the two sections of the cutter unit (green) in the direction of the arrows shown in the illustration.

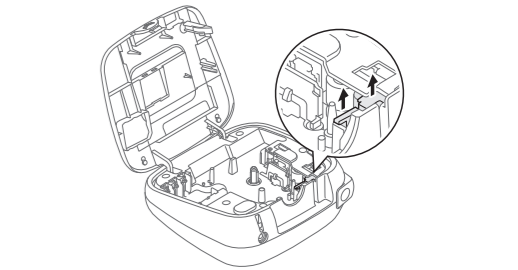

2. Install a new cutter unit. Push it in until it snaps into place.

Do not touch the cutter blade directly with your fingers.

Power Supply and Tape Cassette

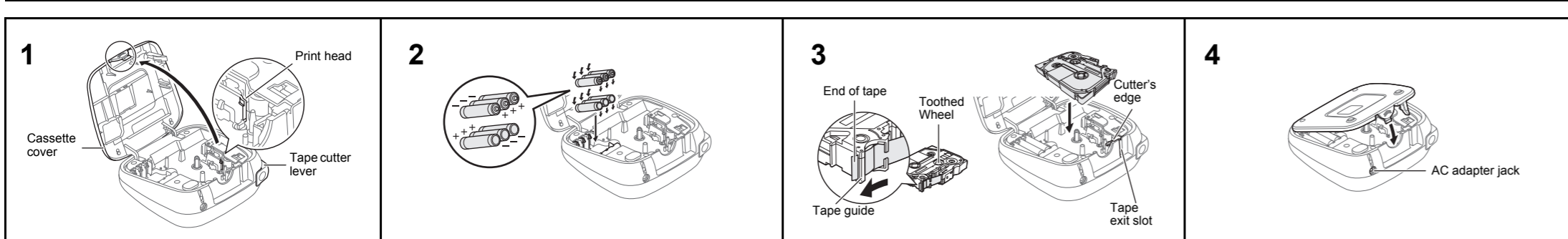

Open the cassette cover by pressing the above indicated area at the top end of the machine.

If a tape cassette is already installed, remove it by pulling it straight up. Also, if batteries are already installed, remove them.

- Make sure that the power is turned off when replacing batteries or tape cassettes.

Insert six new AAA alkaline batteries (LR03) or fully charged Ni-MH batteries (HR03), making sure that their poles point in the correct directions.

Users of alkaline batteries:
Always replace all six batteries at the same time with brand new ones.

Users of Ni-MH batteries:
Always replace all six batteries at the same time with fully charged ones.

NOTE

Visit us at <http://support.brother.com/> for the latest information about the recommended batteries.

Insert a tape cassette, making sure that it snaps into place.

- Make sure that the end of the tape feeds under the tape guides.
- Use only Brother TZe tapes with this machine.

Securely close the cassette cover, making sure that it snaps into place.

NOTE

When using AC adapter (AD-24ES: Optional on the PT-D200)

- Insert the plug on the adapter cord into the AC adapter jack on the top end of the machine.
- Insert the plug into the nearest standard electrical outlet. For memory back up, we recommend using AAA alkaline batteries (LR03) or Ni-MH batteries (HR03) together when using the AC adapter.

LCD Display & Keyboard

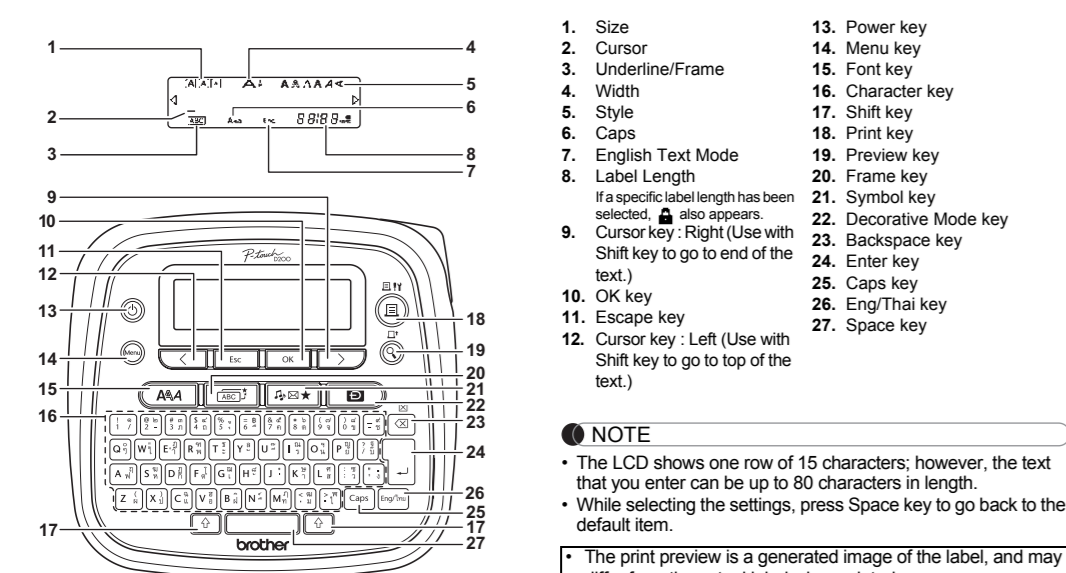

- Size
- Cursor
- Underline/Frame
- Width
- Style
- Caps
- Preview Text Mode
- Label Length
- Symbol key also appears
- Cursor key: Right (Use with Shift key to go to end of the text.)
- OK key
- Escape key
- Cursor key: Left (Use with Shift key to go to top of the text.)
- Power key
- Menu key
- Font key
- Character key
- Shift key
- Print key
- Preview key
- Frame key
- Symbol key
- Decorative Mode key
- Backspace key
- Enter key
- Caps key
- Eng/Thai key
- Space key

NOTE

- The LCD shows one row of 15 characters; however, the text that you enter can be up to 80 characters in length.
- While selecting the settings, press Space key to go back to the default item.

- The print preview is a generated image of the label, and may differ from the actual label when printed.
- Label length shown on LCD may slightly differ from the actual label length when printed.

Specifications

Dimensions: Approx. 165(W) × 155(D) × 68(H)mm (W x D x H)

Weight: Approx. 490 g (without batteries and tape cassette)

Power supply: Six AAA alkaline batteries (LR03) Six AAA Ni-MH batteries (HR03)¹ AC adapter (AD-24ES: Optional on the PT-D200)

Tape cassette: Brother TZe tape (width) 3.5mm, 6mm, 9mm, 12mm

Carrying Case:

This accessory is only applicable to the PT-E200.

¹ Visit us at <http://support.brother.com/> for the latest information about the recommended batteries.

Initial Settings

1 Start your machine.

Supply power by using six AAA batteries or the AC adapter (AD-24ES: Optional on the PT-D200), and then press .

2 Set the language.

The default setting is [Tha].



NOTE

- The machine automatically turns off if no keys are pressed within five minutes.
- To cancel any operation, press .

Troubleshooting

Error message

Message	Cause/Remedy
Low Battery!	The batteries are weak. If using AAA alkaline batteries: Replace them with new ones. If using Ni-MH batteries: Charge them fully.
Battery Dead	The installed batteries are running low. <ul style="list-style-type: none"> There is no text above the cursor when you selected [Numbering]. Invalid character is selected for [Numbering]. Invalid number is selected for [Tab Length] or [Label Length]. An invalid value was entered as the label length while using the Decorative Mode or Name Label function.
Invalid!	<ul style="list-style-type: none"> You tried to print a text file when there is no data stored in the memory. is pressed when no text is entered. You tried to select [Numbering], [Mirror], or Text Preview when no text is entered. or was pressed when no text was entered while using the Decorative Mode or Name Label function.
No Text!	<ul style="list-style-type: none"> You tried to enter a 3rd line by pressing . You tried to print or preview two lines of text while 3.5mm or 6 mm tape is installed. Install tape of a larger size.

Message	Cause/Remedy
No Cassette!	You tried to print or preview a label when there is no cassette installed.
Cutter Error	Tape cutter lever is used in the middle of printing process.
Text Full!	The maximum number of characters (80 characters, 50 characters for Decorative Mode or Name Label function) have already been entered.
Text Limit!	With the Decorative Mode or Name Label function: Since the number of entered characters exceeds the label length, reduce the text. All other functions: Since the number of entered characters exceeds the label length, reduce the text, or select [Auto] as the label length.
No Frame OK?	Printing on 3.5mm tape with invalid Frame setting ON. (Select to print with no Frame, to cancel.)
OK to Feed?	Feeding tape after printing when [Chain Print] is selected. Refer to "Setting Margin".
Insert 12mm	Only 12mm tape cassette is available for Decorative Mode or Name Label function.
Wrong Tape!	Use a tape cassette with the mark.
No VRT OK?	Vertical printing is impossible if entry was made in Thai characters. (Select to print no Vertical, to cancel.)

What to do when...

Problem	Solution
The display stays blank after you have turned on the machine.	<ul style="list-style-type: none"> Check that the batteries are correctly inserted. If the batteries are weak, replace them. Check that the AC adapter (AD-24ES: Optional on the PT-D200) is correctly connected.
When the label is printed out, there is too much margin (space) on both sides of the text.	<ul style="list-style-type: none"> See "Setting Margin" in this users guide and select [Half] or [Narrow] to have smaller margins for your label.
The machine does not print, or the printed characters are not formed properly.	<ul style="list-style-type: none"> Check that the tape cassette has been inserted correctly. If the tape cassette is empty, replace it. Check the cassette cover is properly closed.
The setting has cleared on its own.	<ul style="list-style-type: none"> The batteries may be weak. Replace them. When power is disconnected for more than three minutes, all text & formats in the display will be lost. Language and Unit settings will also be cleared.