



P-touch

E800T Quick Setup Guide English

Thank you for purchasing the P-touch model E800T. Your new E800T is an intuitive, easy to operate and feature-rich labeller that produces professionally looking, high-quality labels. This manual contains basic procedures for using the P-touch. Read the whole guide before using your product and keep it for later reference. The available options and supplies may vary depending on the country.

Available Manuals

Visit the Brother support website at support.brother.com and click **Manuals** on your model page to download the latest manuals.

■ Product Safety Guide

This guide provides safety information; read it before you use the P-touch.

■ Quick Setup Guide (this guide)

This guide provides basic information about using the P-touch along with detailed troubleshooting tips.

■ User's Guide

This guide provides additional information about the P-touch settings and operations, troubleshooting tips, and maintenance instructions. This guide is on the included CD-ROM.

Unpacking Your P-touch

Before using your P-touch, check that the package contains the following:

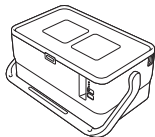

P-touch



Product Safety Guide

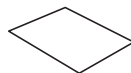

Quick Setup Guide



CD-ROM



AC adapter

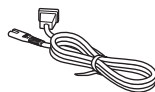

Power supply cord

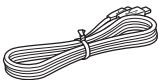

USB cable

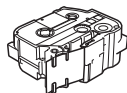

Tape cassette



Ribbon cassette

The components included in the box may differ depending on your country.

General Description

Front

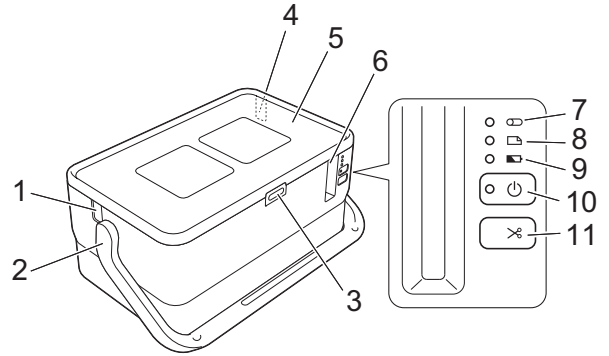

Back

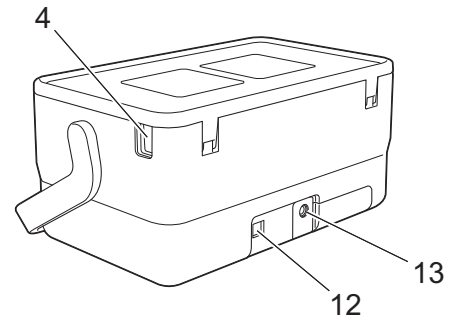

- | | |
|---------------------|--------------------------|
| 1 Tube exit slot | 8 (Label) indicator |
| 2 Handle | 9 (Battery) indicator |
| 3 Cover open button | 10 (Power) button |
| 4 Tube insert slot | 11 (Feed and Cut) button |
| 5 Top cover | 12 USB port |
| 6 Tape exit slot | 13 AC adapter socket |
| 7 (Tube) indicator | |

Inside

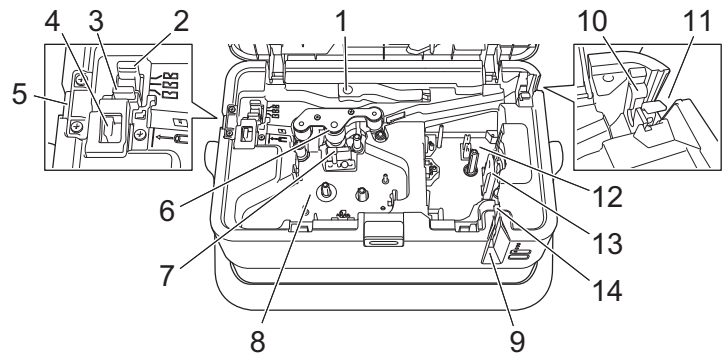

- | | |
|--|------------------------------|
| 1 Tube release lever | 9 Tape exit slot |
| 2 Tube half-cut adjuster | 10 Tube cleaner |
| 3 Tube cutter board | 11 Tube insert slot |
| 4 Tube cutter | 12 Tape cassette compartment |
| 5 Tube exit slot | 13 Print head (for tape) |
| 6 Platen roller | 14 Tape cutter unit |
| 7 Print head (for tube) | |
| 8 Ribbon cassette compartment (for tube) | |

IMPORTANT

Before using the P-touch, make sure you remove the protective material according to the following procedure.

- Press the cover open button to open the top cover.
- Pull the tape to remove the tape together with the protective material.

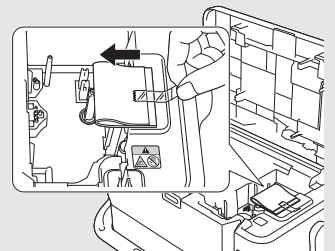

Connecting the Power Supply

AC Adapter

Use the AD9100ESA (AC adapter) for this P-touch. Connect the AC adapter directly to the P-touch.

1. Insert the plug on the AC adapter cord into the AC adapter socket marked DC IN 24 V on the P-touch.
2. Insert the plug on the power supply cord into the AC adapter.

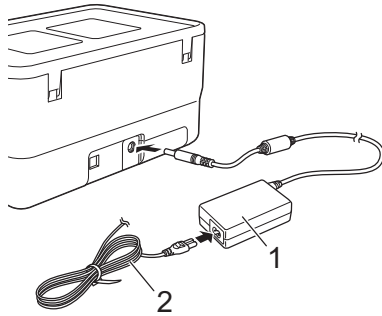

1 AC adapter
2 Power supply cord

3. Insert the power supply plug into a standard electrical socket.

IMPORTANT

- Turn the P-touch off before disconnecting the AC adapter.
- Do not pull or bend the AC adapter cord and power supply cord.
- After the power supply plug is inserted into the electrical socket, it may take a few seconds until the  (Power) button is enabled.

NOTE

To safeguard and backup the P-touch memory, when the power supply is unplugged it is recommended to leave the rechargeable Li-ion batteries (optional: PA-BT-4000LI), installed in the P-touch.

Using the Rechargeable Li-ion Battery (Optional)

Attach the battery base (PA-BB-003) to the P-touch. For more information about attaching the battery base, see its instruction manual.

■ Installing the Rechargeable Li-ion Battery

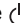
1. Press and hold the  (Power) button to turn the P-touch off.
2. Open the battery cover on the bottom of the P-touch.
3. Insert the battery into the battery compartment.
4. Close the battery cover.

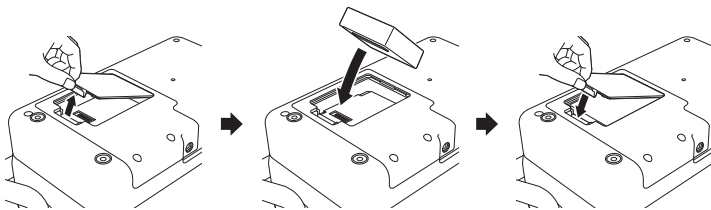



■ Removing the Rechargeable Li-ion Battery

Press and hold the  (Power) button to turn the P-touch off. Remove the battery cover and the battery, and then reattach the battery cover.

■ Charging the Rechargeable Li-ion Battery

NOTE

- Before use, fully charge the battery.
- Up to three hours may be needed to fully charge the battery.

1. Make sure that the battery is installed in the P-touch.
2. Use the AC adapter and power supply cord to connect the P-touch to an electrical socket.
Press the  (Power) button to turn the P-touch on if it is not on already.
The  (Battery) indicator lights in orange during charging, and it goes off when the battery is fully charged.

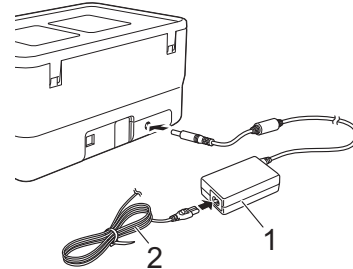

1 AC adapter
2 Power supply cord



NOTE

Although the charging stops if the P-touch is used to print, feed, or perform another operation, the charging will start again automatically after the operation is finished if the charging is not completed.

■ Stopping Rechargeable Li-ion Battery Charging

To stop the battery charging, disconnect the AC adapter.

Notes on Using the Rechargeable Li-ion Battery

- Before use, fully charge the battery. Do not use it before it is fully charged.
- The battery charging must take place in environments between 0°C and 40°C, otherwise the battery will not charge, and the  (Battery) indicator will remain lit. If the charging stops because the environment temperature is too low or too high, place the P-touch with a temperature between 0°C and 40°C and try charging again.
- If the P-touch is used to print, feed, or perform another operation when both the battery is installed and the AC adapter is connected, the  (Battery) indicator may turn off and charging may stop even if the battery is not fully charged.

Rechargeable Li-ion Battery Characteristics

To ensure the highest performance and longest life from the battery:

- Do not use or store the battery in a location exposed to extreme high or low temperatures as it may discharge more quickly. This may happen when using a rechargeable Li-ion battery with a high charge (90% charged or more) in a location exposed to high temperatures.
- Remove the battery when storing the P-touch for long periods of time.
- Store a battery with less than a 50% charge in a cool dry place out of direct sunlight.
- Recharge the battery every six months if it is stored for long periods of time.
- If you touch a part of the P-touch while the Li-ion battery is charging, that part of the P-touch may feel warm. This is normal, and the P-touch may be used safely. However, if the P-touch becomes extremely hot, discontinue use.

Inserting a Tube

1. Open the top cover.

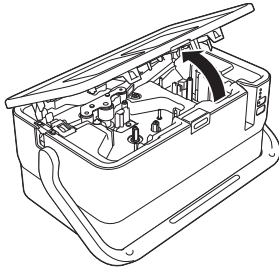

2. Pull the tube release lever up.

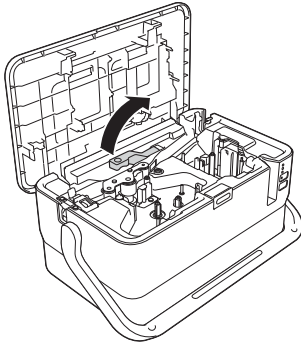

3. Pass the tube as shown in the illustration so that the end of the tube reaches the "P-touch" mark on the P-touch, and then push the tube release lever down.

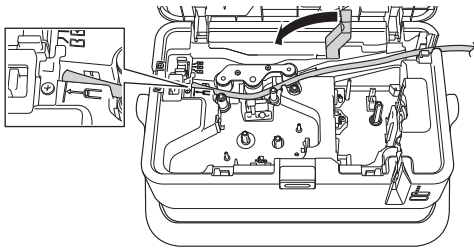

4. Close the top cover.

NOTE

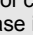
- Do not use tube which is dirty, bent, flattened, has a rough surface or uneven tube thickness, or is defective in any other way.
- When using the P-touch, position it so direct sunlight does not enter the P-touch through the tube exit slot.
- You can use the tube half-cut adjuster to adjust the depth of half cuts to one of three settings.
- If the tube is jammed or not cut completely, use the  (Feed and Cut) button to manually cut the tube completely. Press and hold the button for 2 to 10 seconds until the  (Power) indicator changes from being lit in green to flashing in green, and then release it. The tube will be cut when the button is released.

Inserting a Ribbon Cassette

1. Open the top cover.
2. Insert the ribbon cassette into the ribbon cassette compartment, and press it firmly until you hear a click.

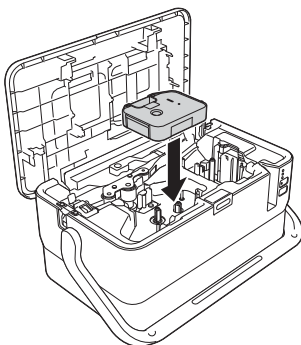

3. Close the top cover.

Inserting a Tape Cassette

The TZe tape, FLe label, and HSe tube cassettes can be used in your P-touch.

IMPORTANT

If the new tape cassette has a cardboard stopper, be sure to remove the stopper before inserting the cassette.

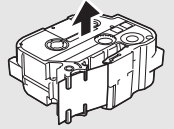

1. Check that the end of the tape is not bent and that it passes through the tape guide. If it does not, pass it through the tape guide as shown in the illustration.

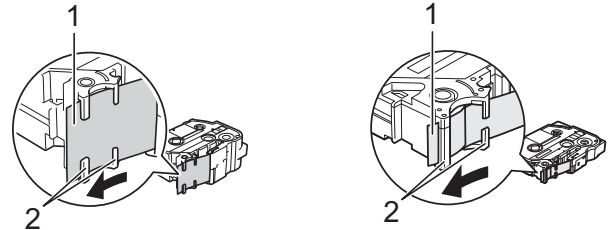

- 1 End of tape
- 2 Tape guides (The actual shape may be different depending on the tape width.)

2. Open the top cover.

3. Insert the tape cassette into the tape cassette compartment with the end of the tape facing the P-touch tape exit slot, then push down evenly until the tape cassette is installed correctly.

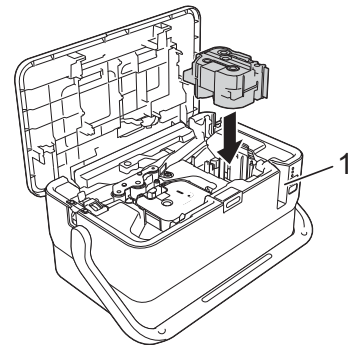

1 Tape exit slot

IMPORTANT

- When inserting the tape cassette, make sure that the tape and ink ribbon do not catch on the print head.
- Make sure that there is no slack in the tape, and then carefully insert the tape cassette. If there is slack in the tape, the tape will catch on the protrusion (2) when the cassette is inserted and become bent or wrinkled, causing the tape to jam. To fix the slack in the tape, refer to the illustration in step 1 and pull the tape outside of the tape guide.
- When removing the tape cassette, make sure that the tape does not catch on the protrusion (2).

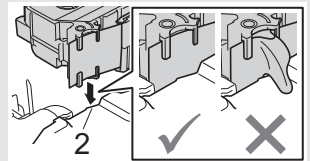





4. Close the top cover.

IMPORTANT

Store tape cassettes in a cool dark location, away from direct sunlight and high temperature, high humidity, or dusty locations. After opening the sealed package, use the tape cassette as quickly as possible.

Turning Power On/Off

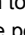
On: Press the  (Power) button to turn the P-touch on. The  (Power) indicator lights in green.

Off: Press and hold the  (Power) button again to turn the P-touch off. The  (Power) indicator may light in orange until the power is off.

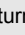
IMPORTANT
When turning the P-touch off, do NOT remove the battery or disconnect the AC adapter until the  (Power) indicator turns off.

Feeding Tape

IMPORTANT

- Be sure to feed tape to remove any slack in the tape and ink ribbon after inserting the tape cassette.
- Do not pull the label when the P-touch is ejecting it from the tape exit slot.** Doing so will cause the ink ribbon to be discharged with the tape. The tape may no longer be functional after the ink ribbon discharges.
- Do not block the tape exit slot during printing or when feeding tape. Doing so will cause the tape to jam.

Feed and Cut

The Feed and Cut function feeds approximately 22.3 mm of blank tape, and then cuts the tape.

Press the  (Feed and Cut) button.

LED Indicators

The indicators light and flash to indicate the P-touch status. The symbols used in this section explain the meaning of the different indicator colours and patterns:

 = Indicator is lit

 = Indicator is flashing











 = Indicator can be off, lit or flashing in any colour

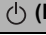













(Off) = Indicator is off

G = Green
O = Orange
R = Red









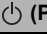

Example:  = Indicator is flashing in green

■ Tube, Label, Power indicator

 (Tube)	 (Label)	 (Power)	Condition
(Off)	(Off)	O ●	Power is turning off Top cover open
(Off)	(Off)	G  (1 time in 1 second)	Transferring data
		O 	Now cooling
(Off)	R 	R 	System error 1 System error 2 System error 3
(Off)	G 	O ●	Reset mode (when the mode is starting)
(Off)	G ●	O ●	Reset mode (when the button is pressed 2/6 times)
(Off)	(Off)	G  (2 times in 1.8 seconds)	In cutting mode (Tube)

 (Tube)	 (Label)	 (Power)	Condition
O 	(Off)	O 	Cutter error (Tube)
R  (2 times in 1.8 seconds)	(Off)	G ●	No tube error (Tube) Media end error (Tube)
O  (1 time in 1 second)	(Off)	G ●	Top cover open error when printing (Tube)
R 	(Off)	O ●	No ribbon cassette error (Tube)
R  (1 time in 1 second)	(Off)	G ●	Ink ribbon jam error (Tube) No remaining ink ribbon error (Tube) Tube jam error (Tube) Tube feeding problem (Tube)
(Off)	O 	O 	When blinking alternately: Cutter error (Label) When blinking simultaneously: High temperature error (Label)
(Off)	R  (1 time in 1 second)	O ●	Wrong media error (Label)
(Off)	R  (2 times in 1.8 seconds)	G ●	No cassette error (Label) Media end error (Label)
(Off)	O 	G ●	Top cover open error when printing (Label)

■ Battery indicator

 (Battery)	 (Power)	Condition
(Off)		Rechargeable battery power: full
O ●		Charging
O  (1 time in 4 seconds)		Rechargeable battery power: half
O  (2 times in 4 seconds)		Rechargeable battery power: low
R 	R ●	Rechargeable battery error
R 	G ●	Rechargeable battery power: empty
O 	O 	Adapter connection/disconnection error

Product Specifications

P-touch Specifications

Model Name	E800T
Size	
Dimensions	approx. 338 mm (W) × 188 mm (D) × 151 mm (H)
Weight	approx. 3.9 kg
Printing	
Method	Thermal Transfer
Compatible tubes ¹	<ul style="list-style-type: none">• Inner diameter: Φ2.5–Φ6.5 mm• Thickness: 0.5 mm• Material: PVC
Cassette	<ul style="list-style-type: none">• Brother TZe tape cassette (3.5 mm, 6 mm, 9 mm, 12 mm, 18 mm, 24 mm, 36 mm widths)• Brother FLe label cassette (21 mm × 45 mm)• Brother HSe tube cassette (5.8 mm, 8.8 mm, 11.7 mm, 17.7 mm, 23.6 mm widths)• Brother TR ribbon cassette (12 mm width)
Interface	
USB	Version 2.0 Full Speed
Environment	
Operating temperature/humidity	<ul style="list-style-type: none">• TZe engine When running: between 10°C and 35°C / between 20% and 80% max. wet bulb temperature: 27°C
	<ul style="list-style-type: none">• Tube engine When running: between 15°C and 35°C / between 20% and 80% max. wet bulb temperature: 27°C

¹ You may not be able to obtain high-quality printing results depending on the type of tube you are using. Before using a tube, print a test to check the results.

Operating Environment

Item	Specifications
OS	Windows Vista / Windows 7 / Windows 8 / Windows 8.1 / Windows 10
Memory	Windows Vista: 512 MB or more Windows 7 / Windows 8 / Windows 8.1 / Windows 10: 1 GB or more (32-bit) or 2 GB or more (64-bit)
Others	CD-ROM drive

Brother support website

Please visit our support website at support.brother.com.

You can find following information:

- Software downloads
- Manuals/Documents
- Frequently Asked Questions (Troubleshooting, Useful tips on using printer)
- Consumable information
- Latest OS compatibility information

The contents of this website are subject to change without notice.

Installing the Software and Printer Driver to a Computer

To print from your computer, install the printer driver, Cable Label Tool, P-touch Editor and other applications to your computer.

IMPORTANT

DO NOT connect the P-touch to the computer until asked to do so.

1. Insert the CD-ROM into your CD-ROM drive.

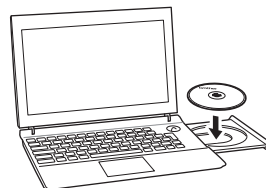

NOTE

Make sure you are logged on with administrator rights.

The latest software and manuals can be downloaded from the Brother support website at support.brother.com.

2. Click the [commoninstaller.exe] button.
3. Follow the on-screen instructions to proceed with the installation.
4. Close the dialog box when the installation is complete.

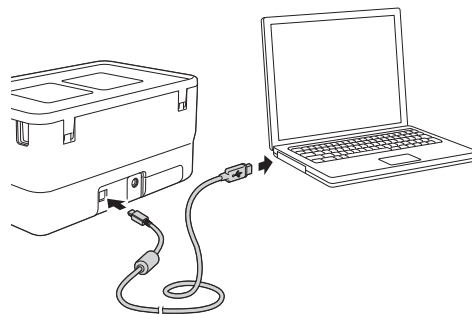

Connecting the P-touch to a Computer

1. Make sure the P-touch is turned off before connecting the USB cable.
2. Connect the P-touch end of the USB cable to the USB port on the back of the P-touch.
3. Connect the other end of the USB cable to the USB port on the computer.



4. Turn the P-touch on.

Available Applications for Use with Computers

Available Applications	Features	Connection
Cable Label Tool 	Create and print labels for cables, patch panels, faceplates, electrical equipment and more.	USB
P-touch Editor 	Design and print custom labels with built in drawing tools, text using different fonts and styles, imported graphic images and barcodes.	

Starting P-touch Applications

For Windows Vista / Windows 7

From the Start button, click **[All Programs]** - **[Brother P-touch]** - **[Cable Label Tool 1.0]** or **[P-touch Editor 5.1]**, or double-click the **[Cable Label Tool 1.0]** or **[P-touch Editor 5.1]** shortcut icon on the desktop.

For Windows 8 / Windows 8.1

Click **[Cable Label Tool 1.0]** or **[P-touch Editor 5.1]** on the **[Apps]** screen, or double-click **[Cable Label Tool 1.0]** or **[P-touch Editor 5.1]** on the desktop.

For Windows 10

From the Start button, select **[All apps]** and click **[Cable Label Tool 1.0]** or **[P-touch Editor 5.1]** under **[Brother P-touch]**, or double-click **[Cable Label Tool 1.0]** or **[P-touch Editor 5.1]** on the desktop.

■ Cable Label Tool

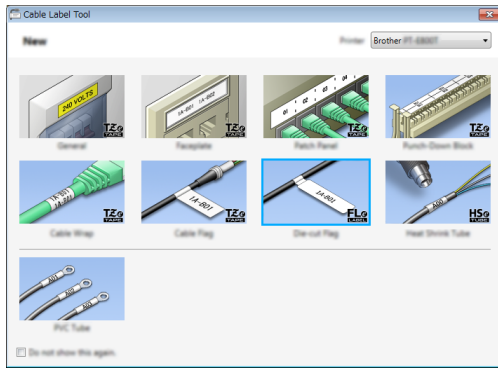

Select the type of label you want to create, set the necessary items, and then print the label.

■ P-touch Editor

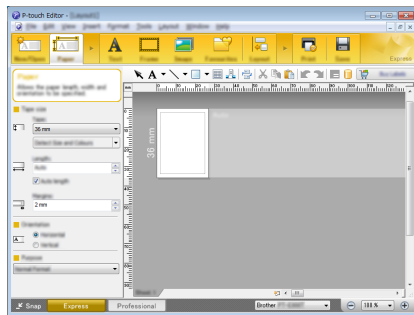

Enter the text and images, and then print the label.

For more information, see the *User's Guide*.

Cable Label Tool

For more information about cable label tool, see the User's Guide.

Faceplate

Labels of this type can be used to identify various faceplates. Blocks of text are evenly spaced on each label.

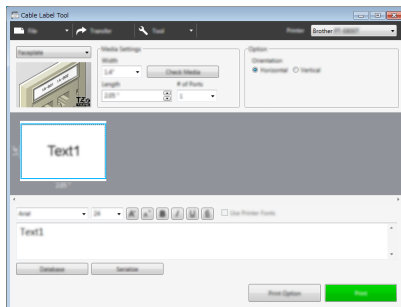

One block

1A-B01

Two blocks

1A-B01 1A-B02

Cable Wrap

Labels of this type can be wrapped around a cable or wire.

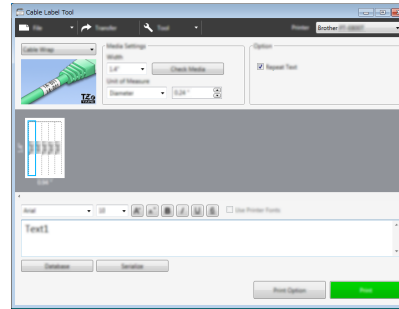

2A-C14
2A-C14
2A-C14
2A-C14
2A-C14
2A-C14

2A-C14
2A-C14
2A-C14
2A-C14

NOTE

When using Flexible ID Tape:

- We recommend using Flexible ID Tape for "Cable Wrap" labels.
- When wrapping labels around cylindrical objects, the diameter (1) of the object should be at least 3 mm.
- The overlapping (2) ends of the label should be at least 5 mm.
- Labels made with Flexible ID Tape are not designed for use as electrical insulation.

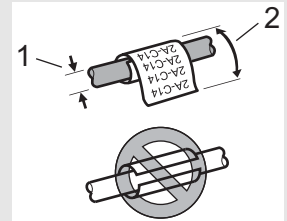

NOTE

When using Self-Laminating Tape:

- We recommend using Self-Laminating Tape For "Cable Wrap" labels.
- The text is horizontally printed.
- Labels made with Self-Laminating Tape are not designed for use as electrical insulation.

Cable Flag

Labels of this type can be wrapped around a cable or wire, and both ends of the label stick together to form a flag. The text on flag labels is printed on both ends of the label, leaving a blank space in the middle that wraps around the cable.

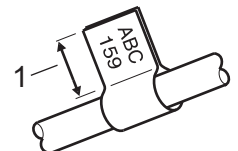
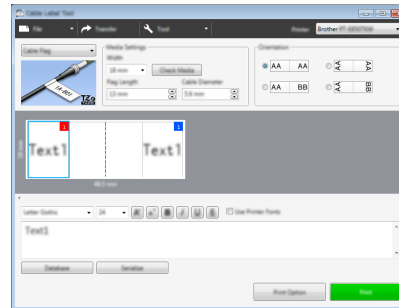

1 Flag length at least 15 mm

NOTE

- We recommend using Flexible ID Tape for "Cable Flag" labels.

Patch Panel

Labels of this type can be used to identify various types of panels.

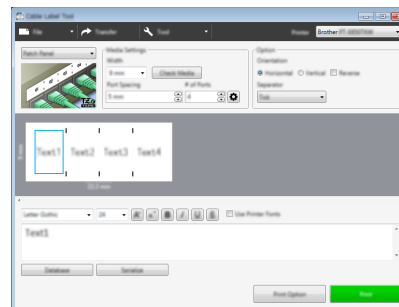

IP01(1) IP02(1) IP03(1) IP03(1) IP02(1) IP01(1)

Punch-Down Block

Labels of this type can be used to identify a type of electrical connection often used in telephony. You can enter up to eight lines for each block on a single label.

B01	B02	B03	B04	B05	B06
B07	B08	B09	B10	B11	B12

1	4	6	12	14	22	24
25	28	32	36	40	44	48

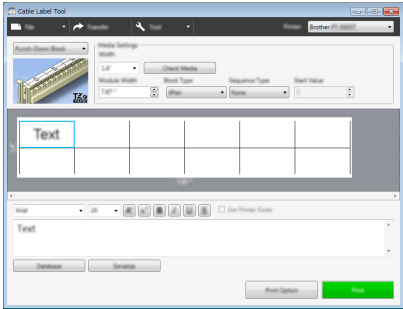

Die-cut Flag

Labels of this type can be printed on special die-cut flag labels to create flag labels for cables and wires. Use the FLe label cassettes for this type of application.

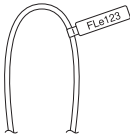
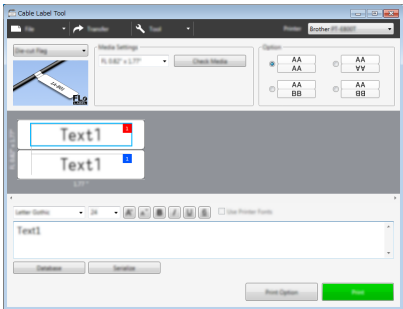

PVC tube

Tubes of this type can be used to identify or insulate cables, or to protect them from heat.

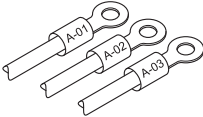
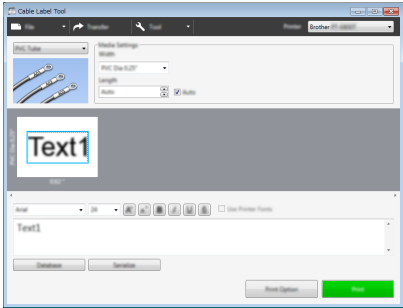

Heat Shrink Tube

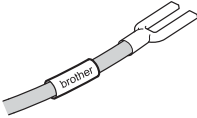
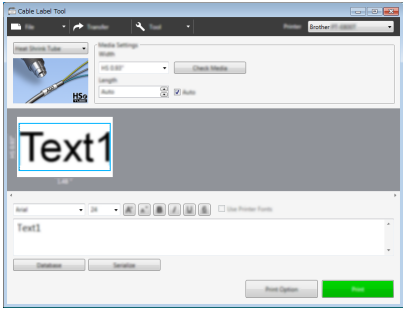

Tubes of this type shrink by heat to fit a cable. Use the HSe tube cassettes for this type of application.



Troubleshooting

Printing Problems

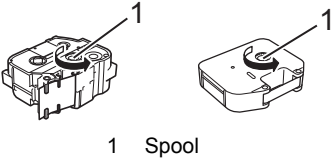
Problem	Solution
The label or tube is not printed.	<ul style="list-style-type: none">• Check that text has been entered and that the tape cassette or tube is installed correctly with sufficient tape or tube remaining.• Do not use a tube that is dirty, bent, or flattened, has a rough surface or uneven tube thickness, or is defective in any other way.• If the tape or tube is bent, cut off the bent section and thread the tape or tube through the exit slot.• When printing from a computer, make sure the computer is connected correctly to the P-touch.
The label or tube is not printed correctly, or the print result is not satisfactory (faint or smudged ink).	<ul style="list-style-type: none">■ Remove the tape cassette or ribbon cassette and reinstall it, pressing it firmly until it locks into place.■ If the label print head is dirty, clean it with a dry cotton swab or optional print head cleaning cassette (TZe-CL6 for label print head only). If the quality of the printed characters is poor even after wiping the label print head, wipe the label roller with a dry cotton swab. See the <i>User's Guide</i>.■ If the tube print head is dirty, clean it with a dry cotton swab. See the <i>User's Guide</i>.■ If the tube or tube cleaner is dirty, replace the tube cleaner. For more information about replacing the tube cleaner, see the <i>User's Guide</i>.■ If the rollers for tubes are dirty, remove the roller cover, pull out the rollers, and clean them using a cloth. Do not use alcohol or other organic solvents. For more information about removing the roller cover, see the <i>User's Guide</i>.■ The rollers may be worn and need to be replaced. For more information about replacing the rollers, see the <i>User's Guide</i>.■ Try changing one of the following settings using the [Tube Settings] tab in [Device Settings] in the "Printer Setting Tool".• Change the printing speed. If you use the P-touch in an environment with a temperature of 20°C or lower, we recommend setting [Print Speed] to [Better Quality].• Change the feeding pressure. If the characters are faint, change [Feeding Pressure] to a stronger setting.• Change the printing density. If the characters are faint, change [Print Density] to a higher setting. For more information, see "Tube Settings Tab" in the <i>User's Guide</i>.■ Try changing one of the following settings when small characters printed on the tube are faint.• Change the font style to bold.• Change the font size to a larger size.■ Try changing one of the following settings when the characters printed on the label are faint.• Change the font style to bold.• Change the font size to a larger size.• High quality printing can be used if you are printing from a computer, and TZe laminated tape with black ink is installed. Use the printer driver to select the high quality mode when printing the labels. You cannot use this function for TZe-FX**1 tape.
The fed tube is dirty.	Replace the tube cleaner. For more information about replacing the tube cleaner, see the <i>User's Guide</i> .

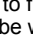
Problem	Solution
The tape or tube is jammed.	<ul style="list-style-type: none"> Feeds the tube backward. In the [Device Settings] menu bar in the "Printer Setting Tool", click [Maintenance] - [Feed Tube] - [Backward]. If you are unable to clear the tube jam by feeding the tube backward, remove the roller cover and remove the tube. For more information about removing the roller cover, see the <i>User's Guide</i>. If the tape or tube is jammed, remove the tape cassette or tube, and then pull out the jammed tape or tube and cut it. For the tape cassette, check that the end of the tape passes through the guide before reinstalling the tape cassette. When the tube is jammed, the ribbon of the ribbon cassette will be damaged. Because the ribbon may break if you use it in this condition, pull out approximately 10 cm of ribbon from the cassette and wind the damaged portion completely onto the spool. You can use the ribbon to print starting from the portion that is not damaged.
The ink ribbon is broken.	Insert a new ribbon cassette. If you use the P-touch in an environment with a temperature of 20°C or lower, we recommend setting [Print Speed] to [Better Quality] . For more information, see "Tube Settings Tab" in the <i>User's Guide</i> .
Although some ink ribbon remains and the tube is not jammed, a message appears indicating that there is no ink ribbon remaining, there is a tube feeding error, or there is a tube jam error.	If the P-touch cannot feed the tube correctly because the tube is twisted or the tube is caught on something outside of the P-touch, this error may occur. Check that the tube is not twisted and that the tube can be fed smoothly outside of the P-touch.
The ink ribbon is separated from the ink roller.	<p>If the ink ribbon is broken, replace the tape cassette or ribbon cassette. If not, leave the tape uncut and remove the tape cassette or ribbon cassette, then wind the loose ink ribbon onto the spool as shown in the figure.</p>  <p>1 Spool</p>
The P-touch stops while printing a label or tube.	<ul style="list-style-type: none"> Replace the tape cassette if striped tape is visible, as this indicates that you have reached the end of the tape. Connect the AC adapter directly to the P-touch, or charge the rechargeable Li-ion battery.
The label or tube is not cut automatically.	<p>For labels, check the Cut Option setting using the printer driver.</p> <p>To cut labels manually, press the  (Feed and Cut) button to feed and cut the tape.</p> <p>To cut tubes manually, press and hold the  (Feed and Cut) button for 2 to 10 seconds until the  (Power) indicator changes from being lit in green to flashing in green, and then release it. The tube will be cut when the button is released.</p>
A tape or tube jam error cannot be cleared despite following the troubleshooting steps.	Contact Brother customer service.
The tube is not cut or is difficult to cut.	<p>Replace the tube cutter.</p> <p>Replace the tube cutter after approximately 50,000 cutting operations (this number may vary depending on the operating conditions). You can confirm the current number of cutting operations from a computer by executing [Help] - [Software Information Scan] in P-touch Editor.</p> <p>If the tube cutter has reached the recommended number of cutting operations, replace it with a new one (model number PA-TC-001).</p> <p>After replacing the tube cutter, reset the counter. You can reset the counter for the tube cutter by selecting [Reset Tube Cutter Counter] in the [Device Settings] menu bar in the "Printer Setting Tool". For more information, see the <i>User's Guide</i>.</p>

Problem	Solution
I want to adjust the depth of half cuts for tubes.	Half cuts can be adjusted to one of three depths. Press the cover open button to open the top cover, and then move the tube half-cut adjuster to adjust the cutting depth. To specify a more advanced setting, change the [Cut Depth] setting on the [Tube Settings] tab in [Device Settings] in the "Printer Setting Tool" .
Tubes are not fed correctly.	The rollers may be worn and need to be replaced. For more information about replacing the rollers, see the <i>User's Guide</i> .
The length of printed tubes is shorter than the set tube length.	
The tube rollers have become worn.	Replace the rollers. For more information, see the <i>User's Guide</i> .
The tube is not ejected correctly after printing.	Feeds the tube forward. In the [Device Settings] menu bar in the "Printer Setting Tool" , click [Maintenance] - [Feed Tube] - [Forward] .
I want to make fine adjustments to the print result.	The length and margins can be adjusted in the "Printer Setting Tool" . For more information, see the <i>User's Guide</i> .
I want to faster printing.	High speed printing can be used if the AC adapter is connected, and TZe laminated tape with black ink is installed. Use the printer driver to select the high speed mode when printing the labels. You cannot use this function for TZe-FX**1 tape.
I want to print in higher resolution.	High resolution printing can be used if the AC adapter is connected and TZe laminated tape with black ink is installed. Use the printer driver to select the high resolution mode when printing the labels. You cannot use this function for TZe-FX**1 tape.
The print result is poor.	High resolution printing can be used if the AC adapter is connected and TZe laminated tape with black ink is installed. Use the printer driver to select the high resolution mode when printing the labels. You cannot use this function for TZe-FX**1 tape. If using the high speed printing setting, print using the standard setting.
The high resolution or high speed printing setting was specified, but an error occurred and printing could not be completed.	As conditions for high resolution or high speed printing, the AC adapter must be connected, and TZe laminated tape with black ink must be installed. You cannot use this function for TZe-FX**1 tape. To clear the error, cancel the print job, and then connect the AC adapter or cancel high resolution or high speed printing.
FLe labels cannot be positioned correctly.	If the FLe sensor is dirty, FLe labels cannot be positioned correctly. Wipe the FLe sensor using a cotton swab moistened with alcohol to clean the sensor. See the <i>User's Guide</i> .

Version information

Problem	Solution
I do not know the version number of the firmware of my P-touch.	<p>The version number and other information for the firmware can be confirmed using the following procedure:</p> <p>Use 24 mm or 36 mm tape.</p> <ol style="list-style-type: none"> Turn the P-touch on. Press and hold the  (Feed and Cut) button for more than 10 seconds to print the report. For more information, see the <i>User's Guide</i>.
I want to confirm whether I am using the latest version of the software.	Use the P-touch Update Software to confirm if you have the latest version. See the <i>User's Guide</i> for more information about the P-touch Update Software.