

brother

TZ[®]
TAPE

P-touch

***H110* User's Guide**

English

H110 User's Guide

English

With your new Brother P-touch labelling machine, you can create a wide variety of custom, self-adhesive labels. This machine uses Brother "TZe" tapes from 3.5 mm to 12 mm widths. "TZe" tape cassettes are available in many colours and sizes. Visit www.brother.com for a complete list of tapes that work with your machine. Read this manual carefully before starting and keep it in a handy place for future reference.

Printed in China
LAK038001



1 GETTING STARTED

Power Supply and Tape Cassette

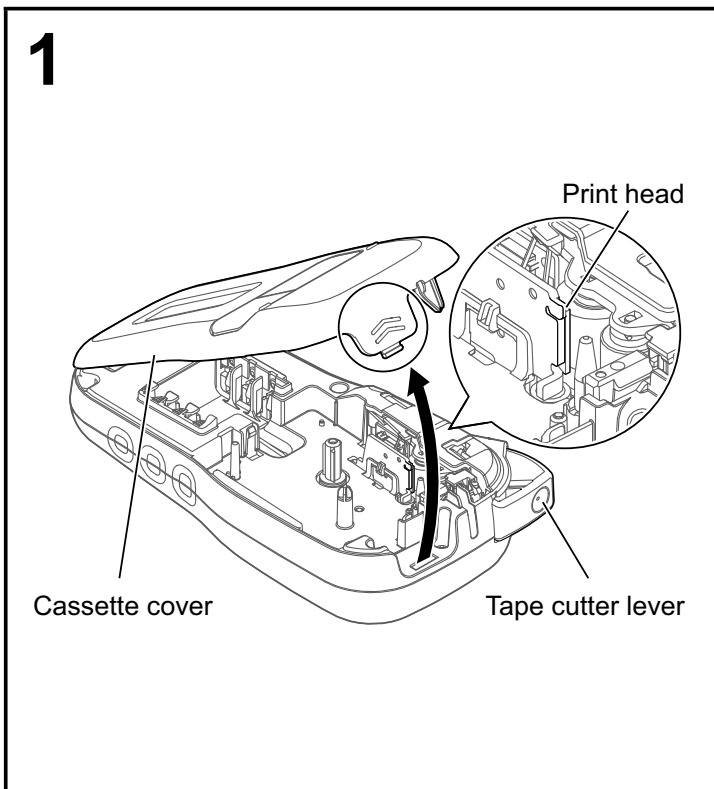

Open the cassette cover by pressing the highlighted area at the top end of the machine.

- Make sure you turn the power off when replacing batteries or tape cassettes.

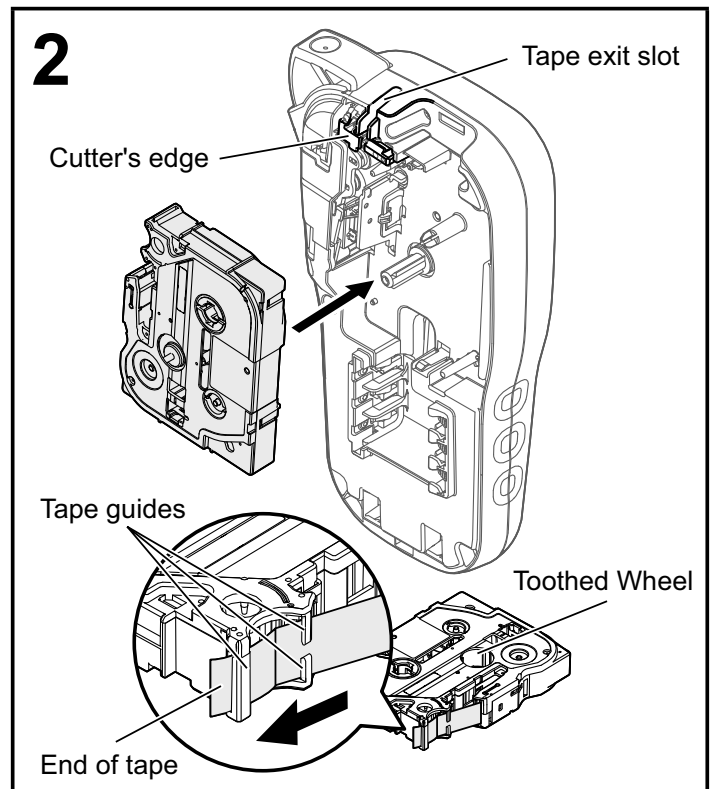

Insert a tape cassette, making sure it snaps into place.

- Make sure the end of the tape feeds under the tape guides.
- Use Genuine Brother P-touch TZe tapes with this machine.

NOTE

When using the optional AC adapter

1. Insert adapter cord into the AC adapter socket at the bottom of the machine.
2. Insert the plug into the nearest standard electrical socket.

For the memory backup feature, use either AAA alkaline batteries (LR03) or Ni-MH batteries (HR03) together when using the AC adapter.

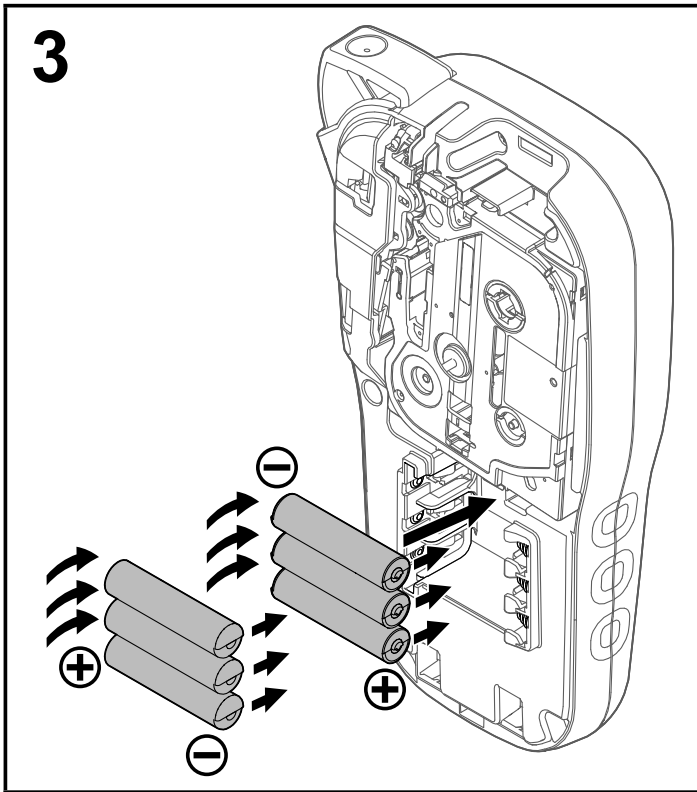

Insert six new AAA alkaline batteries (LR03) or fully charged Ni-MH batteries (HR03), making sure their positive and negative ends point in the correct directions.

Users of alkaline batteries:

Always replace all six batteries at the same time with brand new ones.

Users of Ni-MH batteries:

Always replace all six batteries at the same time with fully charged ones.

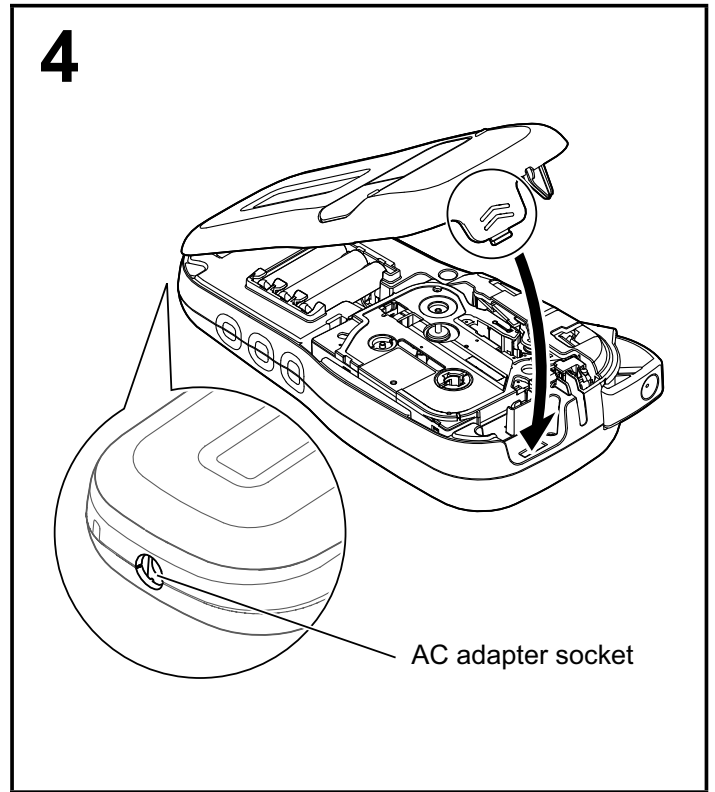

1 Insert the two hooks at the bottom of the cassette cover into the slots on the machine.

2 Securely close the cassette cover making sure it snaps into place.

LCD

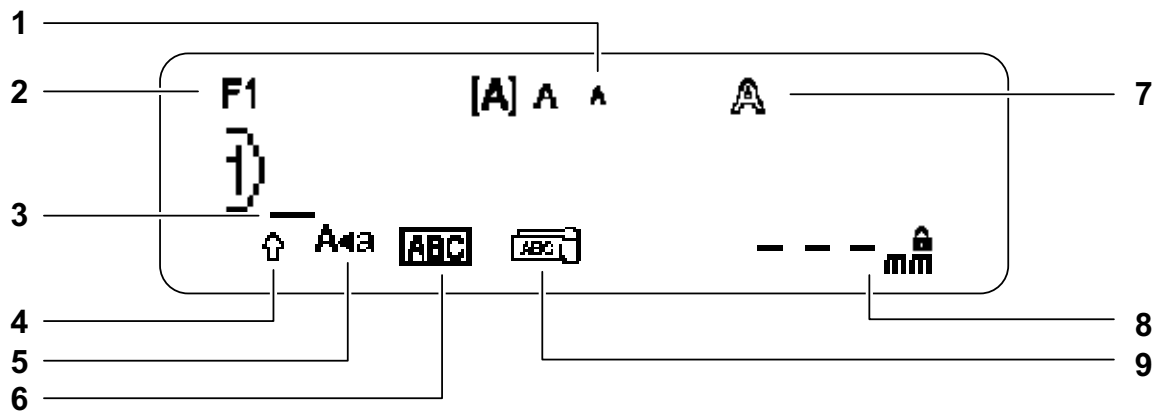

- | | | |
|-----------|--------------------|--------------------------------|
| 1. Size | 5. Caps | 8. Label Length |
| 2. Font | 6. Underline/Frame | If a specific label length has |
| 3. Cursor | 7. Style | been selected, also appears. |
| 4. Shift | | 9. Cable |

NOTE

- The LCD displays one row of 15 characters; however, the text you enter can be up to 80 characters in length.
- Label length displayed on the LCD may differ slightly from the actual printed label length.

Initial Settings

1 Turn your machine on.

Supply power using six AAA batteries or the optional AC adapter (AD-24ES/AD-5000ES: For Australia, New Zealand only), and then press to turn the power on.

2 Set the language.

The default setting is [English].

Menu → / [Language] OK → / [English/Español/Français/Hrvatski/Italiano/Magyar/Melayu/Nederlands/Norsk/Polски/Português/Portug. (BR)/Română/Slovenski/Slovenský/Suomi/Svenska/Türkçe/Čeština/Dansk/Deutsch] OK .

3 Set the unit of measurement.

The default setting is [mm].

Menu → / [Unit] OK → / [inch/mm] OK .

NOTE

- The machine automatically turns off if no keys are pressed within five minutes.
- To cancel any operation, press .
- After pressing , the machine displays "Accepted" to confirm your settings.

Keyboard

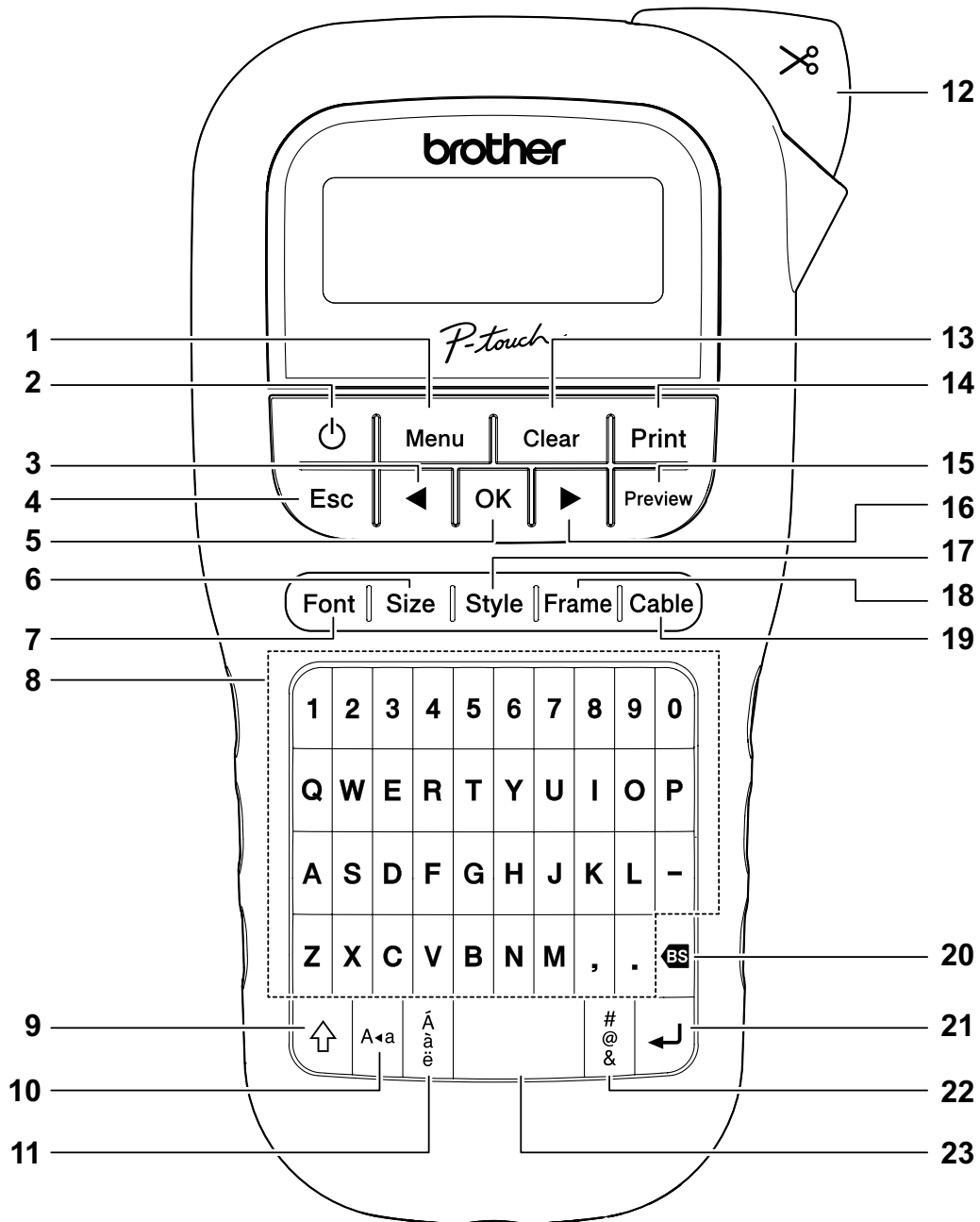

- | | | |
|--|--|-------------------|
| 1. Menu key | 9. Shift key | 17. Style key |
| 2. Power key | 10. Caps key | 18. Frame key |
| 3. Cursor key: Left (Use with the Shift key to go to the top of the text.) | 11. Accent key | 19. Cable key |
| 4. Escape key | 12. Tape cutter lever | 20. Backspace key |
| 5. OK key | 13. Clear key | 21. Enter key |
| 6. Size key | 14. Print key | 22. Symbol key |
| 7. Font key | 15. Preview key | 23. Space key |
| 8. Character key | 16. Cursor key: Right (Use with the Shift key to go to the end of the text.) | |

NOTE

- While selecting the settings, press the Space key to revert to the default item.
- Pressing the Preview key displays a generated image of the label, and may differ from the actual label when printed.

1 GETTING STARTED (Continued)

Contrast

This function allows you to set the brightness of the LCD. You can select from five levels of brightness.

The default setting is [0].

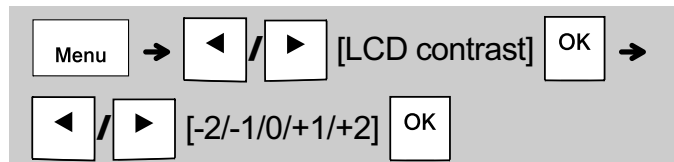

- To change a setting back to default, press the Space key.

2 BASIC USAGE

Entering Text

► Switching Upper-Case/Lower-Case



Press to switch between upper and lower case text.

Upper-case (ON) Lower-case (OFF)

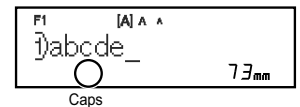
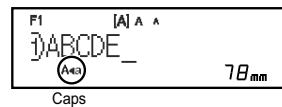

► Creating Two-Line Labels

Move the cursor to where you want to start the next line and press . Use either 9 mm or 12 mm wide tape for two line printing.

Line 1

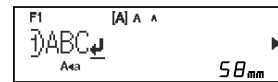

Label image



Line 2

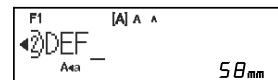

● NOTE

- The return symbol () is displayed when you press the Enter key, indicating you have chosen to input a second line of text.

► Entering Accented Characters

Press to add an accented character.

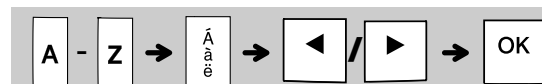

- See the table of accented characters included in this guide.
- To cancel an operation, press .
- The order of accented characters depends on the selected LCD language.

Entering Text (continued)

► Changing Label Width

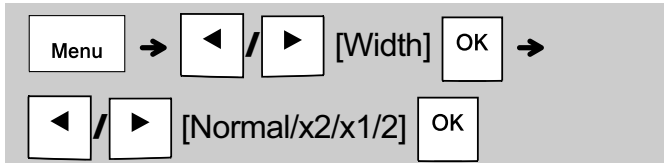

Width		Normal	
		× 2	
		× 1/2	

► Changing Label Length

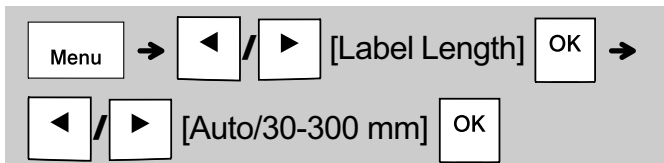

NOTE

- After the label is printed, cut along the printed dots (:) with scissors so that the label length matches what is displayed on the LCD.
- If a specific label length has been selected, also appears in the LCD.
- By pressing the Space key, [Auto] is displayed.
- To change a setting back to default, press the Space key.

► Deleting Text



NOTE

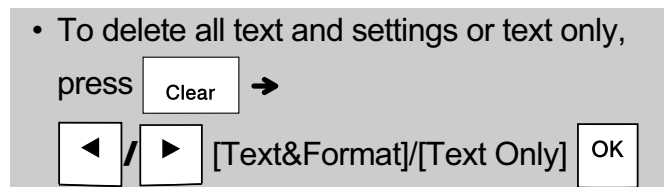

Printing Labels

► Preview

You can preview the text before printing.



- Pressing the Preview key displays a generated image of the label, and may differ from the actual label when printed.
- When the LCD cannot display all the text at once, press [Left Arrow] / [Right Arrow] to display the hidden text.
- Press [OK] / [Enter] / [Esc] to leave the preview mode.

► Feeding (Tape Feed)



- This function feeds approximately 25 mm of blank tape.

2 BASIC USAGE (Continued)

Printing Labels (continued)

► Printing

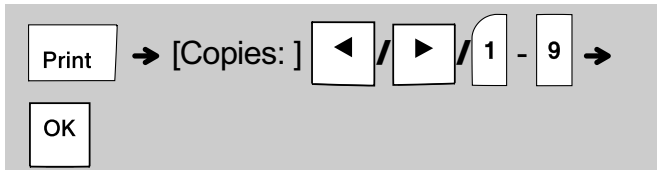

- If you need only one copy of the label, press **OK** without selecting the number of copies.
- You can print up to nine copies of each label.
- The number of copies can also be specified by pressing a number key.
- To cut the label, press the tape cutter lever on the upper-right corner of the machine after the message "Please Cut" is displayed. "Please Cut" is displayed on the screen for two seconds.
- To prevent damage to the tape, do not touch the cutter lever while the message "Please Wait" is displayed.
- To remove the backing, fold the label lengthwise with the text facing inward to expose the inside edges of the backing. Peel off the backing one piece at a time and apply.

► Using Print Options

[Numbering]

You can print a series of up to nine labels at a time using auto-numbering. Using this feature you can automatically increase a selected number by one after each label is printed. The numbers of labels you can print at one time depend on the initial number.

Example: To print copies of a label containing a serial number (0123, 0124 and 0125)

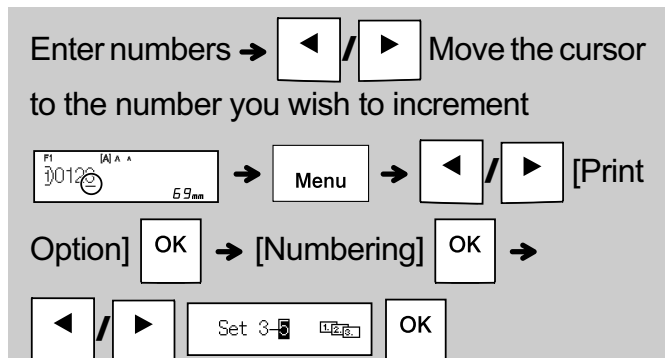

- Select the highest number you want to be printed when setting the number.

[Mirror]

Example: Follow the instructions below after entering "J.SMITH" if you want to Mirror Print "J.SMITH".

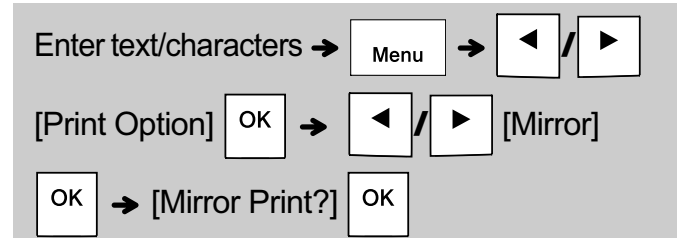

J.SMITH

- Use clear tape in [Mirror], so you can read the labels correctly from the opposite side when attached on glass, windows or other transparent surfaces.

► Setting Margin (Menu)



[Full]/[Half]/[Narrow]

For leaving equal margins on both sides of the text.

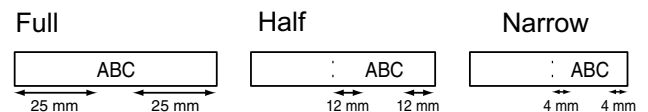

NOTE

- The 25 mm piece of tape that is produced prior to every label cannot be eliminated due to the construction of the tape mechanism. However, when you print more than one label continuously, the subsequent labels can be printed without the excess tape. (Except for the full margin setting)

Printing Labels (continued)

[Chain Print]

Use this setting when printing several labels with minimum margins.

1. Enter text.
2. Press **Print**, then [Copies:] appears.
3. Press **Left/Right** or enter a number with number keys to select the number of copies.
4. Press **OK**. Printing starts, and then the message "Feed OK?" appears.
5. Press **Esc** to enter more text.
6. Clear the text, enter the text for the next label, and then press **Print**.
7. When the message "Feed OK?" appears after the last label is printed, press **OK**.
8. After the tape is fed, press the cutter lever to cut off the chain of labels.

NOTE

- When you set [Chain Print], feed the tape before using the cutter otherwise a part of the text may be cut off.
- When you set [Half] or [Narrow], the displayed label length is the length from the printed dots (:) to the end of the label. Cut along the printed dots (:) with scissors.

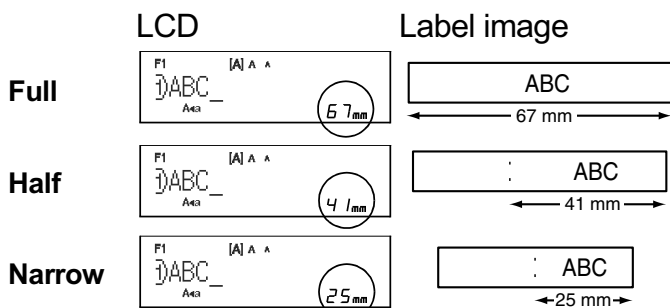

- To print more than one copy of a label with minimum margins, set the margin to [Narrow].
- Do not pull the tape since this may damage the tape cassette.

Saving Label Files

You can save up to 15 labels and recall them for printing at a later date. A maximum of 80 characters can be saved per file, a maximum of 1200 characters can be saved in total memory. You can also edit and overwrite the stored labels.

► Save

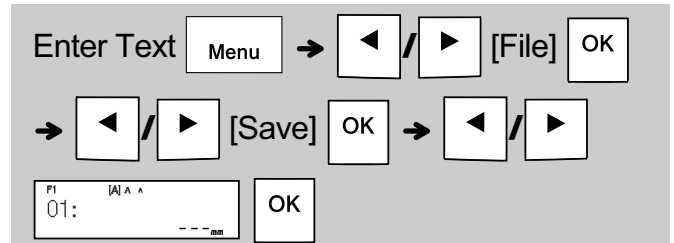

► Print

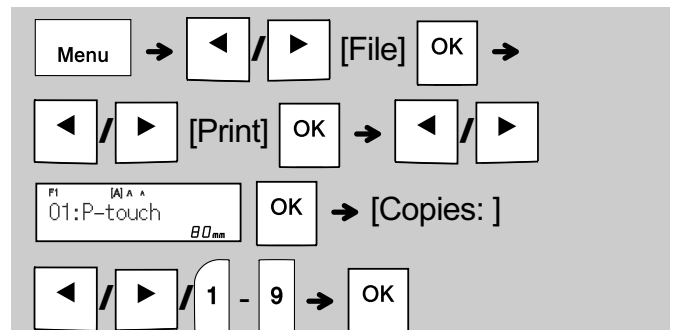

► Open

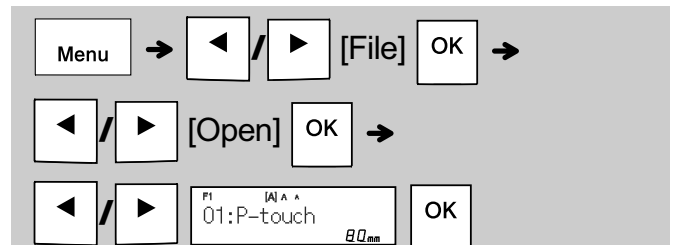

NOTE

- You can also enter the File menu by pressing **Menu** → **4**.
- If you try to store a label when there is already a label stored to that number, a message "Overwrite OK?" appears. Press **OK** to save your new label. Press **Esc** to cancel.
- You must type text before starting the save function.

3 USING TEMPLATES

Cable Label

This function allows you to create two types of cable labels.

Cable Label template 1 : 

Cable Label template 2 : 

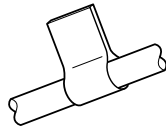

Example: Cable Label 1

The flowchart shows the steps to create Cable Label 1: Press 'Cable', select a layout (AAA AAA), press OK, enter text, press Print, and set the number of copies (1-9) before pressing OK.

NOTE



- Label length is auto only. You cannot set label length.
- To clear all text and settings or text only, press

  /  [Text&Format]/[Text Only]



- You can set the Font, Size, Style and Frame while entering texts.
- To exit templates and return to the text input screen, do one of the following:

a) Press .

b) Press  /  to select [Exit], and then press

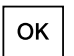
 when "Print" appears.

- To preview labels, press the Preview key when [Print] is displayed on the LCD.
- You cannot save labels created using templates to memory.

Text Label

This function allows you to create various labels using the built-in templates. See the Text Label templates table included in this guide.



► Example:





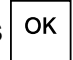
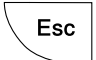

[Template that includes one repeated graphic]

The flowchart shows the steps to create a text label: Press Menu, select a decorative template, press OK, select the Text category, press OK, select a design (stars), press OK, enter text, press OK, set label length (Auto/30-999 mm), press OK, press Print, press OK, and set the number of copies (1-9) before pressing OK.

NOTE

- Press the Space key to return to the initial setting for "Label Length" mode. The initial setting is [Auto].
- To clear the text, move the cursor to the right side where you want to clear, and then press .
- To clear all text, press , then "All Clear" appears. Press  to clear. Press  to cancel.
- You cannot set the Font, Size, Style and Frame while entering text.
- If you set the longer label length than the default ([Auto]), the text label is printed repeatedly within the set length. The text label may not be fully printed depending on the set length.
- The available label length setting changes depending on the number of texts you entered.
- These templates are available when using 12 mm wide tape cassettes.
- You cannot edit the templates.

Text Label (continued)

- To exit templates and return to the text input screen, do one of the following:
 - Press .
 - Press  /  to select [Exit], and then press  when "Print" appears.
- To preview labels, press the Preview key when [Print] is displayed on the LCD.
- You cannot save labels created using templates to memory.
- When you access Text Label or Pattern Label templates, your most recently printed Text Label or Pattern Label template label length is recalled.

Pattern Label



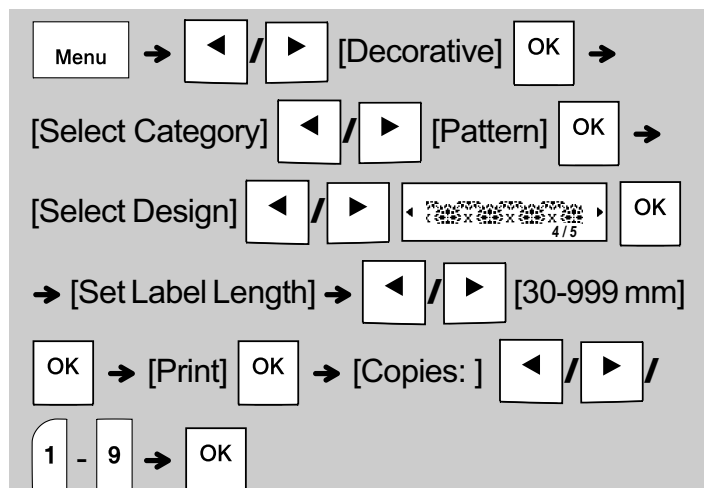

This function allows you to create unique labels using built-in templates. See the Pattern Label templates table included in this guide.

You cannot enter text when using Pattern Label templates.

Example: 

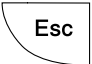

NOTE

- Press the Space key to return to the initial setting for "Label Length" mode. The initial setting is [100 mm].
- These templates are available when using 12 mm wide tape cassettes.
- You cannot edit the templates.
- To exit templates and return to the text input screen, do one of following:
 - Press .
 - Press  /  to select [Exit], and then press  when "Print" appears.
- To preview labels, press the Preview key when [Print] is displayed on the LCD.
- You cannot save labels created using templates to memory.
- When you access Text Label or Pattern Label templates, your most recently printed Text Label or Pattern Label template label length is recalled.

4 FORMATTING KEYS

Font Key



Press  to change the font settings.





 →  /  Select the settings 

Font		Helsinki	A 1
		Brussels	A 1
		Florida	A 1

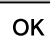
Size Key

Press  to change the size settings.











 →  /  Select the settings 

Size		Large	
		Medium	
		Small	

Style Key

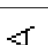

Press  to change the style settings.

 →  /  Select the settings 

Style		Normal	
		Bold	
		Outline	
		Shadow	
		Italic	
		I+Bold	
		I+Outline	
		I+Shadow	
		Vertical	
		V+Bold	

Frame Key

Press  to select the frame design. See the Frame designs table included in this guide.

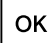
 →  /  Select a frame 

NOTE

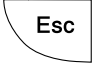
- To cancel an operation, press .
- See the Font samples table included in this guide.
- The actual printed font size depends on the tape width, number of characters, and number of input lines. When characters reach a minimum size, the selected font defaults to a custom font based on the Helsinki style. This allows you to print labels using the smallest text possible on narrow or multi-line labels.

Specifications

Dimensions: Approx. 109(W) mm X 202(D) mm X 55(H) mm
(W x D x H)

Weight: Approx. 400 g
(without batteries and tape cassette)

Power supply: Six AAA alkaline batteries (LR03)
Six AAA Ni-MH batteries (HR03)*1
Optional AC adapter (AD-24ES/AD-5000ES:
For Australia, New Zealand only)

Tape cassette: Brother P-touch TZe tape widths:
3.5 mm, 6 mm, 9 mm, 12 mm

*1 Visit <http://support.brother.com/> for the latest information about recommended batteries.

Accessories

Tape Cassettes: See the included “Supplies and Accessories Guide”.

AC Adapter: AD-24ES/AD-5000ES: For Australia, New Zealand only

Cutter Unit: TC-4 (replacement)

If the cutter blade becomes blunt after repetitive use and the tape cannot be cut cleanly, turn around the cutter board as shown in the illustration ①.

If you still have difficulty, replace with a new cutter unit (stock no. TC-4) by obtaining one from an authorised Brother reseller.

▶ Replacing the Cutter Unit

1. Pull out the two sections of the cutter unit (green) in the direction of the arrows shown in the illustration ②.
2. Install the new cutter unit. Push it in until it snaps into place.

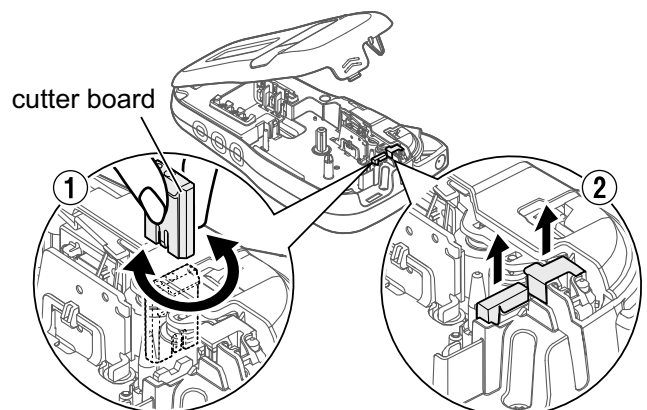

⚠ WARNING

Do not touch the cutter blade directly with your fingers.

Symbol key

▶ Entering Symbols

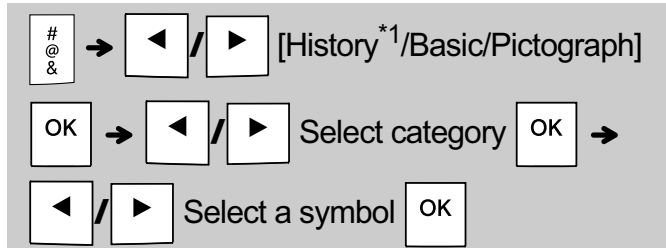

- See the table of symbols included in this guide.
- To cancel an operation, press .
- *1 When you select symbols, up to seven recently used symbols are added to History.
- If you choose History, you cannot select the category.
- You can also select from basic and pictograph categories by pressing the shortcut keys included in this guide.

▶ Basic

Punctuation	Space key	Unit	
Mathematics		Greek Letter	
Brackets		Number	
Arrows		Shape	







▶ Pictograph

Fun	Space key	Kitchen	
Smiley		Garden	
Clothing		DIY	
Vehicle		School	
Sports		Office	
Animal		Signs	
Holiday		Datacom/AV	
Food/Drink		Electrical	

6 HELPFUL HINTS

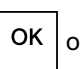
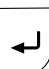
Troubleshooting

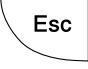
► Error message

Message	Cause/Remedy
Battery Low!	The batteries are low. If using AAA alkaline batteries: Replace them with six new AAA alkaline batteries. Do not use old and new batteries together or mix alkaline batteries with other battery types. If using Ni-MH batteries: Charge them fully.
Battery Empty!	The installed batteries are running low and need to be changed for continued operation.
Invalid!	<ul style="list-style-type: none"> • There is no text above the cursor when you selected [Numbering]. • You selected an invalid character for [Numbering]. • You selected an invalid number for [Label Length]. • You entered an invalid value as the label length while using templates.
No Text!	<ul style="list-style-type: none"> • You tried to print a text file when there is no data stored in the memory. • You pressed  when no text is entered. • You pressed  when no text is entered. • Do not press  or  when no text was entered while using templates.
2 Line Limit/ 1 Line Limit!	<ul style="list-style-type: none"> • Make sure you do not exceed the maximum number of lines allowed (two). • You tried to print or preview two lines of text while 3.5 mm or 6 mm tape is installed. Install a larger tape size.
No Cassette!	You tried to print, feed or preview a label when there is no cassette installed.
Cutter Pressed	You pressed the tape cutter lever in the middle of the printing process.
Text Full!	Make sure you do not exceed the maximum number of characters allowed (80 characters for text, 50 characters for templates. If your message contains symbols, the maximum number of characters may be reduced.).
Text Limit! Change Length	Since the number of entered characters exceeds the label length, reduce the text, or select [Auto] as the label length.
No Frame OK?	<ul style="list-style-type: none"> • Printing on 3.5 mm tape with invalid Frame setting ON. (Select  to print with no Frame,  to cancel.)
Feed OK?	<ul style="list-style-type: none"> • Feeding tape after printing when [Chain Print] is selected. See "Setting Margin".
Insert 12 mm	<ul style="list-style-type: none"> • Only 12 mm tape cassette is available for templates.
Wrong Tape! Use TZe tape	<ul style="list-style-type: none"> • Use a tape cassette with the  mark.

► What to do when...

Problem	Solution
The display stays blank after you have turned on the machine.	<ul style="list-style-type: none"> • Check that you installed the batteries with the positive and negative ends in the correct position. • If the batteries are low, replace them with six new AAA alkaline batteries. Do not use old and new batteries together or mix alkaline batteries with other battery types. • Check that you connected the AD-24ES/AD-5000ES: For Australia, New Zealand only adapter correctly.
When the label is printed out, there is too much margin (space) on both sides of the text.	See "Setting Margin" in this user's guide and select [Half] or [Narrow] to have smaller margins for your label.
The machine does not print, or the printed characters are not formed correctly.	<ul style="list-style-type: none"> • Check that you have inserted the tape cassette correctly. • If the tape cassette is empty, replace it. • Check that you closed the cassette cover correctly.
The machine's settings have reset themselves.	<ul style="list-style-type: none"> • The batteries may be low. Replace them with six new AAA alkaline batteries. Do not use old and new batteries together or mix alkaline batteries with other battery types. • When power is disconnected for more than three minutes, all text and formats in the display are lost.
A blank horizontal line appears through the printed label.	There may be some dust on the print head. Remove the tape cassette and use a dry cotton swab to gently wipe the print head with an up-and-down motion. The optional print head cleaning cassette (TZe-CL3) is also available.
The machine has "locked up" (that is, nothing happens when a key is pressed, even though the machine is on.)	See "Resetting the machine".
The power turns off when you try to print.	<ul style="list-style-type: none"> • The batteries may be low. Replace them with six new AAA alkaline batteries. Do not use old and new batteries together or mix alkaline batteries with other battery types. • Check that you inserted the batteries correctly. • A wrong adapter is used; the recommended adapter is the AD-24ES/AD-5000ES: For Australia, New Zealand only.
The tape does not feed correctly or the tape gets stuck inside the machine.	<ul style="list-style-type: none"> • Check that the end of the tape feeds under the tape guides. • The cutter lever is pressed while printing. Do not touch the cutter lever during printing.
To change the language setting.	See "Initial Settings".

6 HELPFUL HINTS (continued)

Shortcuts

Language	Menu → Space key
Width	Menu → 1
Label Length	Menu → 2
Margin	Menu → 3
File	Menu → 4
Decorative	Menu → 5
Print Option	Menu → 6
Feed	Menu → 7
Unit	Menu → 8
LCD Contrast	Menu → 9

Resetting the machine

You can reset the machine when you want to restore it to factory settings, or when it is not working correctly. All text, settings and stored files are cleared.

1 Turn the machine off, press and hold

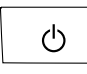
 and **R**, and then press and hold 
to turn the machine back on.

2 First release the power button, and then

release  and **R**.

The machine turns on with the internal memory reset.

For Australia Only:

Support - For technical support of your Brother Product other than what you can resolve through the User's Guide, please visit our Web Site or Solutions Web Site (see below) to find an answer to FAQs/ Troubleshooting, locating Drivers & Software. Alternatively, please contact the Product Support Centre for any customer care/technical support enquiry.

To contact Brother International (Aust) Pty Ltd for support on a Brother product please see the details listed below:

Product Support Centre: **Australia**
Brother International (Aust) Pty Ltd
Phone: 02 8875 6000
Fax: 02 9870 7223

Solutions Site: **support.brother.com**

Web Site: **www.brother.com.au**

E-mail: To submit an e-mail enquiry, visit **www.brother.com.au** go to **Service and Support** area and follow the prompts.

Our Technical Support Consultants are available 5 days a week by phone during the hours of 8.30am to 5.00pm (EST/EDST) Monday to Friday.

CAUTION

USING A COMBINATION OF DIFFERENT BATTERIES (SUCH AS Ni-MH AND ALKALINE), MAY RESULT IN AN EXPLOSION. DISPOSE OF USED BATTERIES ACCORDING TO THE INSTRUCTIONS.

NOTE

Battery Recommendations

- Remove the batteries if you do not intend to use the machine for an extended period of time.
- Dispose of the batteries at an appropriate collection point, not in the general waste stream. In addition, be sure to observe all applicable federal, state, and local regulations.
- When storing or discarding the batteries, wrap each battery (for example with cellophane tape), to prevent it from short-circuiting. (See the picture on the lower right)

(Battery insulation example)

1. Cellophane tape
2. Alkaline or Ni-MH battery

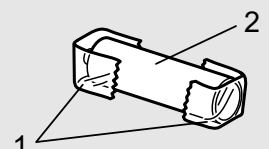

Category	Symbols (Basic)	% a
Punctuation ?!&	. , : ; " ' • ? ! ¿ ¡ - & ~ _ \ / * @ #	
Mathematics +x±	+ - × ÷ ± = ≥ ≤ ≠	
Brackets ()[]	() [] < > « » 【 】	
Arrows →↑	→ ← ↑ ↓ ↔ ⇌ ↕	
Unit %\$	% \$ € £ ¥ ¢ ° ft.in.m²m³cc ℓ oz.lb.°F°C	
Greek Letter αβ	α β γ δ μ Ω φ Σ α̇ α̈	
Number ²³IV	₂ ₃ ² ³ ¼ ⅓ ½ ⅔ ¾ I II III IV V VI VII VIII IX X	
Shape ●☆	● ○ ■ □ ★ ☆ ♠ ♣ ♥ ♠ ♦ ◆ ♣ ♣ ▲ △ ▼ ▽	

Category	Symbols (Pictograph)	
Fun		
Smiley		
Clothing		
Vehicle		
Sports		
Animal		
Holiday		
Food/Drink		
Kitchen		
Garden		
DIY		
School		
Office		
Signs		
Datacom/AV		
Electrical		

Accented Characters

A	Á À Ã Ä Å Æ Æ Ā Ā Ā Ā	a	á à â ä å æ ã ç å ā ā				
C	Ç Ć Ć	D	Đ Đ	c	ç Ć Ć	d	d' ð đ
E	É È Ê Ë Ę Ě Ě Ě	e	é è ê ë ě ě ě ě				
G	Ĝ Ĝ	I	Í Î Ï Ĳ Ĳ Ĳ	g	ĝ ĝ	i	í î ï ĳ ĳ ĳ
K	Ḳ	L	Ł Ł Ł Ł	k	ḳ	l	ł ł ł ł
N	Ñ Ñ Ñ Ñ	R	Ŕ Ŕ Ŕ Ŕ	n	ñ ñ ñ ñ	r	ŕ ŕ ŕ
O	Ó Ò Ô Ø Ö Õ Œ Œ	o	ó ò ô ø ö õ œ õ				
S	Š Ś Ş Ş ß	T	Ŧ Ŧ Ŧ Ŧ	s	š ś ş ş ß	t	ŧ ŧ ŧ ŧ
U	Ú Û Ü Ü Ů Ů Ů Ů	u	ú û ü ü ů ů ů ů				
Y	Ý Ÿ	Z	Ž Ž Ž	y	ý ŷ	z	ž ž ž

Font samples

Helsinki	ABC\$£€39	Florida	ABC\$£€39
Brussels	ABC\$£€39		

Text Label templates

01		05		08	
02		06		09	
03		07		10	
04					

Pattern Label templates

01		03		05	
02		04			

Frame designs

01	Off (No frame)	05		09		13	
02		06		10		14	
03		07		11		15	
04		08		12		16	

* Images are only for illustrative purposes.