

With your new Brother P-touch label maker, you can create a wide variety of custom, self-adhesive labels. This label maker uses Brother "TZe" tapes from 3.5 mm to 12 mm widths. "TZe" tape cassettes are available in many colors and sizes. Visit www.brother.com for a complete list of tapes that work with your machine. Read this manual carefully before starting and keep it in a handy place for future reference.



D01CHP001

1 GETTING STARTED

Power Supply and Tape Cassette

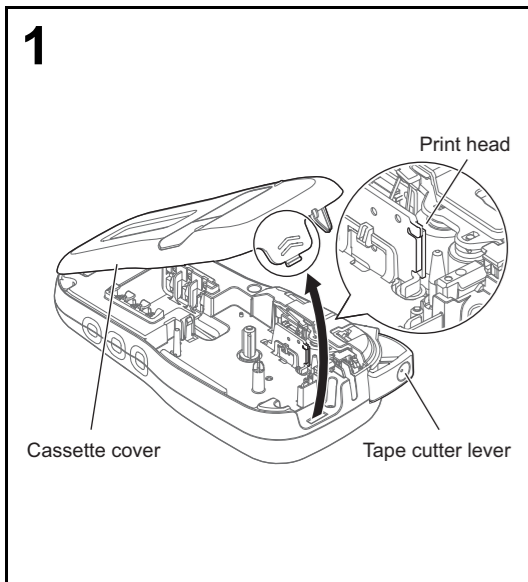

Open the cassette cover by pressing the above indicated area at the top end of the label maker.

- Make sure you turn off the power when replacing batteries or tape cassettes.

NOTE

When using optional AC adapter (AD-24ESA)

1. Insert the plug on the adapter cord into the AC adapter jack on the bottom end of the label maker.
2. Insert the plug into the nearest standard electrical outlet.
For memory backup, use either AAA alkaline batteries (LR03) or Ni-MH batteries (HR03) together when using the AC adapter.

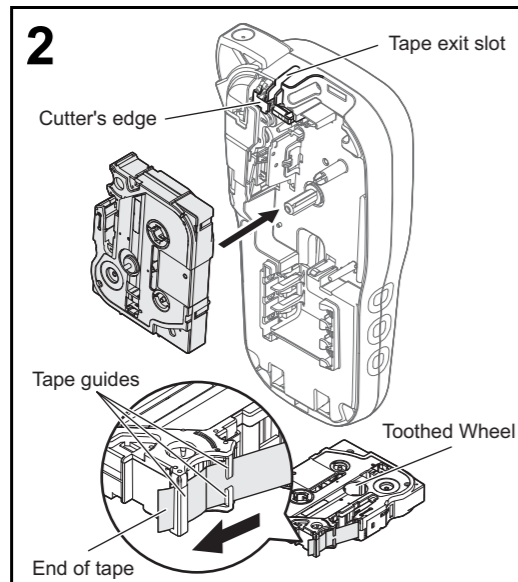

Insert a tape cassette, making sure it snaps into place.

- Make sure the end of the tape feeds under the tape guides.
- Use Genuine Brother P-touch TZe tapes with this label maker.

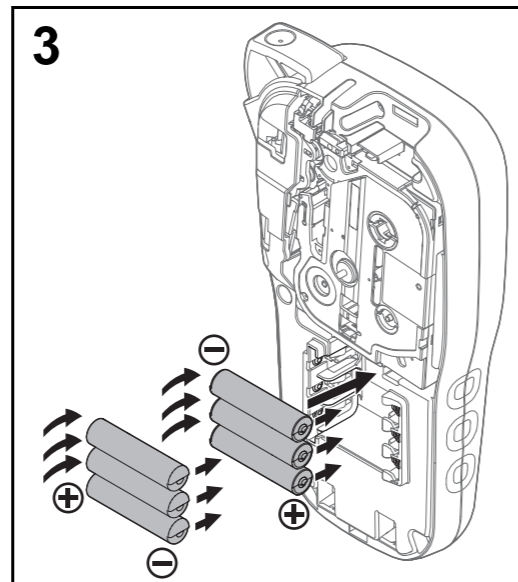

Insert six new AAA alkaline batteries (LR03) or fully charged Ni-MH batteries (HR03), making sure their poles point in the correct directions.

- Users of alkaline batteries:**
Always replace all six batteries at the same time with brand new ones.
- Users of Ni-MH batteries:**
Always replace all six batteries at the same time with fully charged ones.

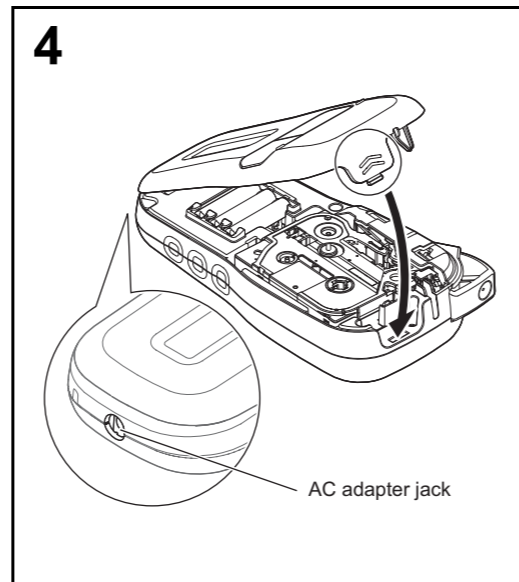

1 Insert the two hooks at the bottom of the cassette cover into the slots on the label maker.

2 Securely close the cassette cover making sure it snaps into place.

LCD

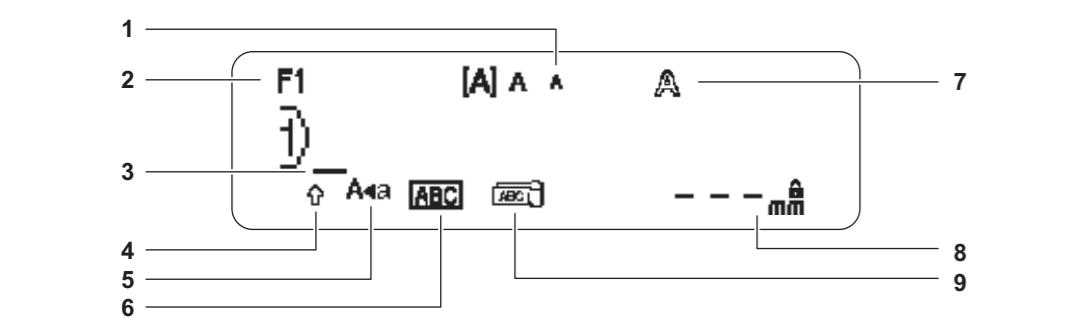

1. Size
2. Font
3. Cursor
4. Shift
5. Caps
6. Underline/Frame
7. Style
8. Label Length
9. Cable

NOTE

- The LCD displays one row of 15 characters; however, the text you enter can be up to 80 characters in length.

• Label length displayed on LCD may differ slightly from the actual label length when printed.

Initial Settings

1 Turn on your label maker.

Supply power using six AAA batteries or the optional AC adapter (AD-24ESA), and then press

2 Set the language.

The default setting is [English].

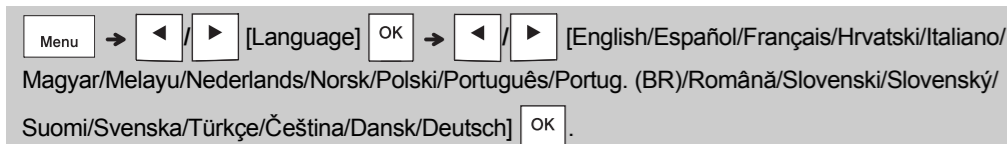

3 Set the unit of measurement.

The default setting is [mm].



NOTE

- The label maker automatically turns off if no keys are pressed within five minutes.
- To cancel any operation, press .
- After pressing , "Accepted" is displayed for approximately one second.

Keyboard

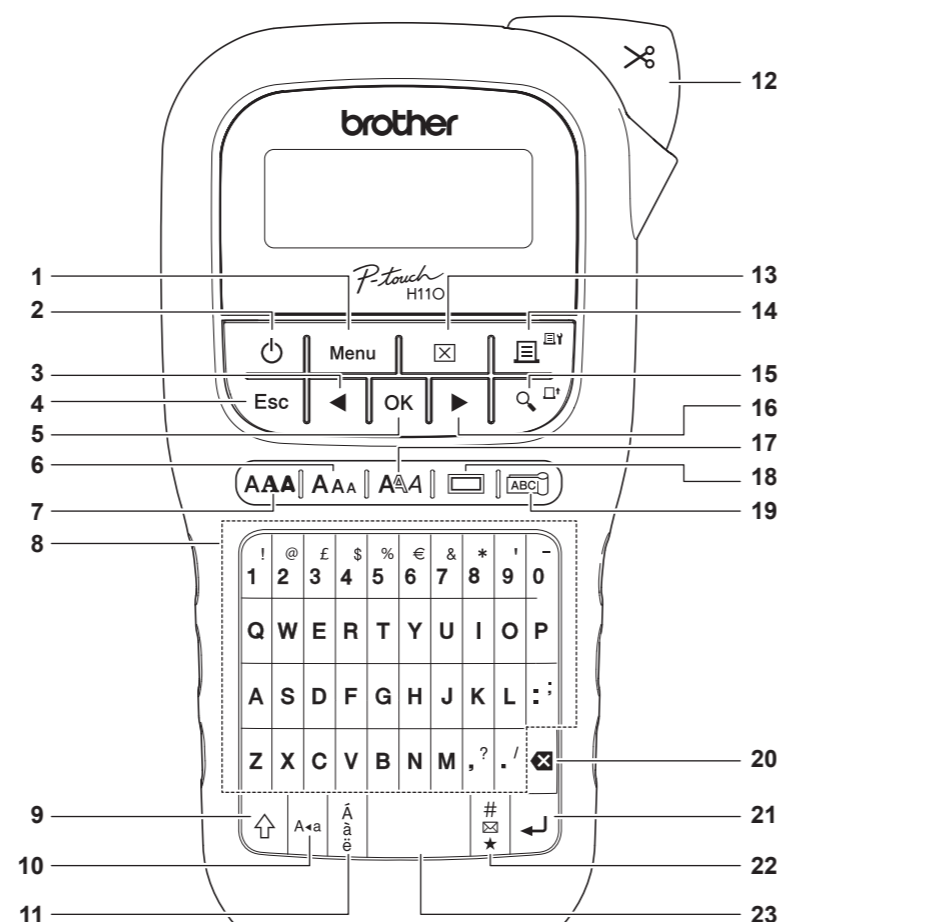

1. Menu key
2. Power key
3. Cursor key : Left (Use with Shift key to go to top of the text.)
4. Escape key
5. OK key
6. Size key
7. Font key
8. Character key
9. Shift key
10. Caps key
11. Accent key
12. Tape cutter lever
13. Clear key
14. Print key
15. Preview key
16. Cursor key : Right (Use with Shift key to go to end of the text.)
17. Style key
18. Frame key
19. Cable key
20. Backspace key
21. Enter key
22. Symbol key
23. Space key

NOTE

- While selecting the settings, press the Space key to revert to the default item.

• Pressing the Preview key displays a generated image of the label, and may differ from the actual label when printed.

1 GETTING STARTED (Continued)

Contrast

This function allows you to set the brightness of the LCD. You can select from five levels of brightness.

The default setting is [0].

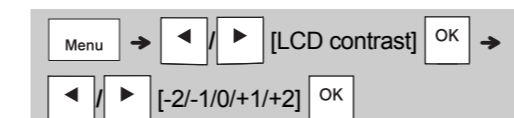

- To change back to default setting, press the Space key.
- After pressing , "Accepted" is displayed for approximately one second.

2 BASIC USAGE

Entering Text

▶ Switching Upper Case/Lower Case

Press to switch between upper and lower case text.

Upper case (ON) Lower case (OFF)



▶ Creating Two-Line Labels

Move the cursor to where you want to start the next line and press . Use either 9 mm or 12 mm wide tape for two line printing.

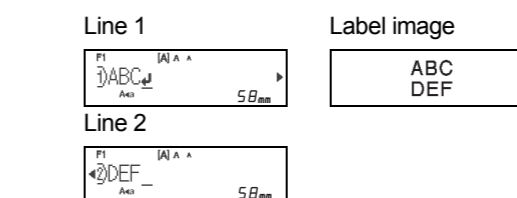

NOTE

- The return symbol () is displayed when you press the Enter key, indicating you have chosen to input a second line of text.

▶ Entering Accented Characters

Press to add an accented character.



- See the table of accented characters included in this insertion sheet.
- To cancel operations, press .
- The order of accented characters differs by the selected LCD language.

2 BASIC USAGE (Continued)

Printing Labels (continued)

▶ Using Print Options [Numbering]

You can print a series of up to nine labels at a time using auto-numbering. Using this feature you can automatically increase a selected number by one after each label is printed. The numbers of labels you can print at one time are dependent upon the initial number.

Example: To print copies of a label containing a serial number (0123, 0124 and 0125)

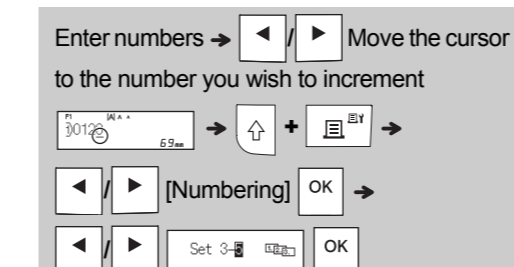

- Select the highest number you wish to be printed when setting the number.

[Mirror]

Example: Follow the instructions below after entering "J.SMITH" if you want to Mirror Print "J.SMITH".

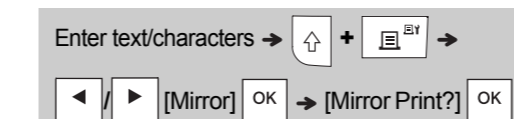

- Use clear tape in [Mirror], so you can read the labels correctly from the opposite side when attached on glass, windows or other transparent surfaces.

Entering Text (continued)

▶ Changing Label Width

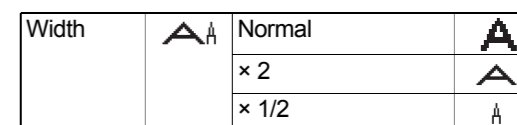
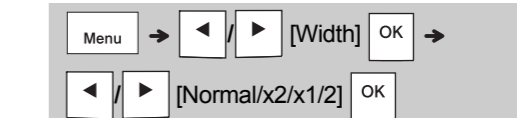

▶ Changing Label Length



NOTE

- After the label is printed, cut along the printed dots (:) with scissors so that the label length matches what is displayed on the LCD.
- If a specific label length has been selected, also appears in the LCD.
- By pressing the Space key, [Auto] is displayed.
- To change setting back to default, press the Space key.

• After pressing , "Accepted" is displayed for approximately one second.

▶ To Clear

By pressing , the letters are deleted one by one.

NOTE

- You can also delete all text and settings or text only by pressing



• After pressing , "Accepted" is displayed for approximately one second.

Printing Labels (continued)

NOTE

- When you set [Chain Print], feed the tape before using the cutter otherwise a part of the text may be cut off.
- When you set [Half] or [Narrow], displayed label length is the length from the printed dots (:) to the end of the label. Cut along the printed dots (:) with scissors.

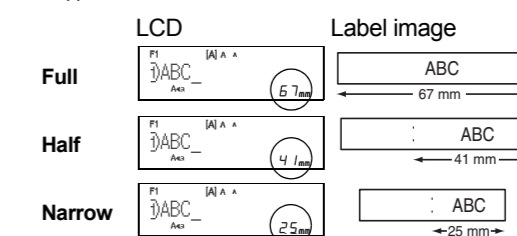

- To print more than one copy of a label with minimum margin, set the margin to [Narrow].
- Do not pull the tape since this may damage the tape cassette.

• After pressing , "Accepted" is displayed for approximately one second.

Printing Labels

▶ Preview

You can preview the text before printing.



- Pressing the Preview key displays a generated image of the label, and may differ from the actual label when printed.
- When the LCD cannot display all the text at once, press to display the hidden text.

• Press to leave the preview mode.

▶ Feeding (Tape Feed)



- This function feeds approximately 25 mm of blank tape.

▶ Printing



- If you need only one copy of the label, press without selecting the number of copies.

• You can print up to 9 copies of each label.

- The number of copies can also be specified by pressing a number key.
- To cut the label, push in the tape cutter lever on the upper-right corner of the label maker after the message "Please Cut" is displayed. "Please Cut" is displayed on the screen for two seconds.
- To prevent damage to the tape, do not touch the cutter lever while the message "Please Wait" is displayed.

• To remove the backing, fold the label lengthwise with the text facing inward, to expose the inside edges of the backing. Peel off the backing one piece at a time and apply.

Saving Label Files

You can save up to 15 labels and recall them for printing at a later date. A maximum of 80 characters can be saved per file, a maximum of 1200 characters can be saved in total memory. You can also edit and overwrite the stored labels.

▶ Save

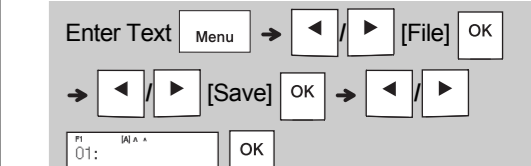

▶ Print

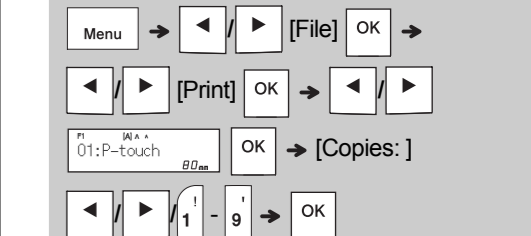

▶ Open

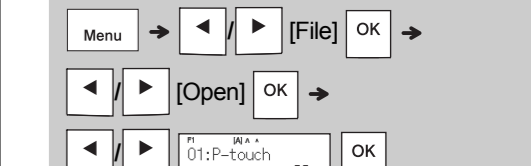

NOTE

- You can also enter the File menu by pressing .
- If you try to store a label when there is already a label stored to that number, a message "Overwrite OK?" appears. Press to save your new label. Press to cancel.
- You must type text before starting the save function.
- After pressing , "Accepted" is displayed for approximately one second.

