

PT-D200/E200
User's Guide
English
Thai

With your PT-D200/E200, you can create labels for multiple applications. Select from the many frames, character sizes and styles to design beautiful custom labels. In addition, the variety of tape cartridges available allows you to print labels with different widths and exciting colors.

Read this manual carefully before starting and keep the manual in a handy place for future reference.

Printed in China
LAB579001

Safety Precautions

WARNING Indicates a potentially hazardous situation which, if not avoided, could result in death or serious injuries.

Follow these guidelines to avoid the risk of fire, burns, injury, electric shocks, rupture, overheating, abnormal odours or smoke.

- Always use the specified voltage and the suggested AC adapter (AD-24ES: Optional on the PT-D200) for the P-touch labeler to prevent any damage or failure.
- Do not touch the P-touch labeler during a lightning storm.
- Do not use the P-touch labeler/AC adapter in places of high humidity such as bathrooms.
- Do not overload the power cord.
- Do not place heavy objects on, or damage the power cord or plug. Do not forcibly bend or pull the power cord. Always hold the AC adapter when disconnecting from the power outlet.
- Make sure that the plug is fully inserted to the power outlet. Do not use an outlet that is loose.
- Do not allow the P-touch labeler/AC adapter/power plug/batteries to get wet, for example, by handing them with wet hands or spilling beverages on to them.
- Do not use sharp objects, such as tweezers or a metallic pen, to change the batteries.
- Do not throw the batteries into fire or expose to heat.
- Disconnect the AC adapter and remove batteries immediately and stop using the P-touch labeler if you notice abnormal odor, heat, discoloration, deformation or anything unusual while using or storing it.
- Do not use a damaged or leaking battery as the fluid may get on your hands.
- Do not use a deformed or leaking battery or one whose label is damaged. There is a possibility of generating heat.
- Do not disassemble or modify the P-touch labeler/AC adapter/batteries.
- Do not allow a metal object to contact both the plus and minus ends of a battery.
- Do not use sharp objects, such as tweezers or a metallic pen, to change the batteries.
- Do not throw the batteries into fire or expose to heat.
- Disconnect the AC adapter and remove batteries immediately and stop using the P-touch labeler if you notice abnormal odor, heat, discoloration, deformation or anything unusual while using or storing it.
- Do not use a damaged or leaking battery as the fluid may get on your hands.
- Do not use a deformed or leaking battery or one whose label is damaged. There is a possibility of generating heat.

CAUTION

Indicates a potentially hazardous situation which, if not avoided, may result in minor or moderate injuries.

Follow these guidelines to avoid personal injury, liquid leakage, burns or heat.

- When the P-touch labeler is not being used, store it out of the reach of children. In addition, do not allow children to put the P-touch labeler parts or labels in their mouths. If any object has been swallowed, seek medical attention.
- Do not touch metal parts around the print head immediately after printing.
- Do not touch the cutter blade.
- If leaked fluid from batteries gets on your skin or clothes, immediately rinse them with clean water.
- Remove the batteries and disconnect the AC adapter if you do not intend to use the P-touch labeler.
- Do not use a battery other than that specified. Do not use combinations of old and new batteries or combinations of different types, different charging levels, different manufacturers or different models. Do not insert a battery with its plus and minus ends reversed.
- Do not drop or hit the P-touch labeler/AC adapter.
- Do not press on the LCD display.
- Do not put your finger inside the P-touch labeler when you close the cassette cover.
- Before using Ni-MH rechargeable batteries, carefully read the instructions for the batteries and battery charger, and be sure to use them correctly.
- When using Ni-MH rechargeable batteries, charge the batteries with a specialized battery charger before using the batteries.

General Precautions

- Depending on the location, material, and environmental conditions, the label may never or become irremovable, the color of the label may change or be transferred to other objects. Before applying the label, check the environmental conditions and the material.
- Do not use the P-touch labeler in any way or for any purpose not described in this guide. Doing so may result in accidents or damage the P-touch labeler.
- Use only Brother TZe tapes with the P-touch labeler. Do not use tapes that do not have the TZe mark.
- Only use a soft, dry cloth to clean the labeler; never use alcohol or other organic solvents.
- Use a soft wipe to clean the print head, never touch the print head.
- Do not put any foreign objects into the tape exit slot or AC adapter connector or battery compartment, etc.

BASIC USAGE

Entering Text

► Switching the character for entry[English/Thai]



► Switching Upper Case/Lower Case



► Making Two Lines Text

Move the cursor to where the second line starts and press [Enter] to display the hidden text.



► Entering Tab [Tab]



To change tab length:

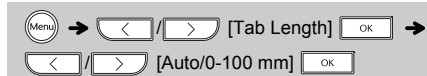

► Changing Label Length [Label Length]

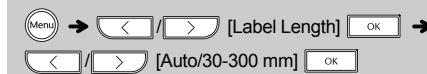

NOTE

- After the label is printed, cut along the printed dots (.) with scissors so that the label length matches the machine setting.
- If a specific label length has been selected, a also appears in the LCD.

► To Clear

By pressing [Clear], the letters will be deleted one by one.

To delete all text and settings :



To delete text only :



Printing Labels

► Preview

You can preview the text before printing.

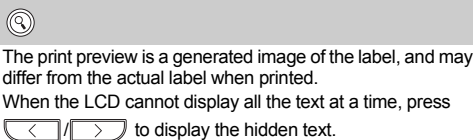

► Feeding (Tape Feed)



► Printing

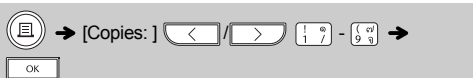

- If you need only 1 copy of the label, press [OK] without selecting the number of copies.
- The number of copies can also be specified by pressing a number key.
- To prevent damage to the tape, do not touch the cutter lever while the message "Printing..." or "Feeding..." is displayed.
- To cut off the label, push in the tape cutter lever on the upper-right corner of the machine.
- To remove the backing, fold the label lengthwise with the text facing inward, to expose the inside edges of the backing. Peel off the backing one piece at a time and apply.
- You can print up to 9 copies of each label.

► Using Print Options [Print Options]

[Numbering]

You can print many copies of the same text while increasing a selected number by 1 after each label is printed.

Example: To print copies of a label containing a serial number (0123, 0124 and 0125)

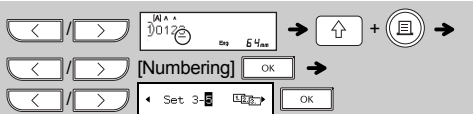

- Select the highest number you wish to be printed when setting the number.
- You can also print Thai numbers the same as above by entering Thai numbers.

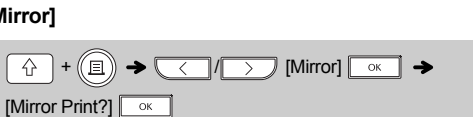
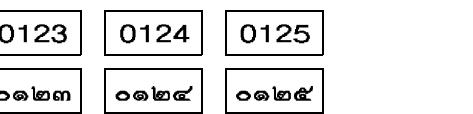

Saving Label Files

You can save up to 9 labels and recall them for printing at a later date. A maximum of 80 characters can be saved per file, a maximum total of 720 characters for the total memory. You can also edit and overwrite the stored label.

► Save

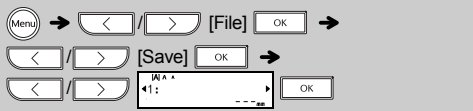

► Print



► Open



You can also enter the File menu by pressing [File].

NOTE

If you try to store a label when there is already a label stored to that number, a message "Overwrite?" will appear. Press [OK] to save your new label. Press [Esc] to cancel.

USING TEMPLATES

Name Label [Name Label]

This function allows you to create various name labels using the built-in templates.

Example: [Name Label]

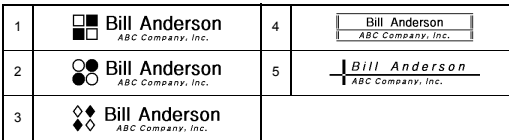
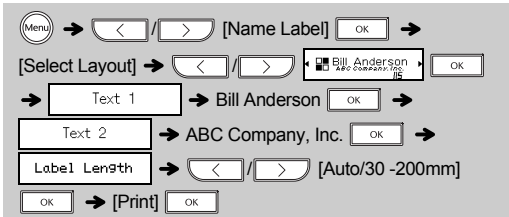

NOTE

- Depending on the format you have selected, the entire contents of your text may not be printed. For example, if you selected a fixed label length and the text is too long, an error message "Text Limit!" will appear.
- The templates cannot be edited.
- To clear all text, press [Clear] and [Clear], then "Clear?" appears. Press [OK] to clear. Press [Esc] to cancel.
- When you access Decorative Mode or Name Label function, your most recently printed Decorative Mode or Name Label function text and label length will be recalled.
- Press [Esc] to return to the previous step.
- Only the highlighted symbols on the list below can be used in Decorative Mode.

USEFUL FUNCTION KEYS

Font Key [Font Key]

1 Press [Font Key] to select the settings to enter the text.



2 Press [Font Key] to select the settings.

Size	Large	Medium	Small
Font	A	A	A
Width	Normal	× 2	× 1/2
Style	Normal	Bold	Outline
Shadow	Shadow	Solid	Italic
Vertical (English only)	Vertical (English only)	Vertical (English only)	Vertical (English only)

NOTE

To cancel operations, press [Esc].

Frame Key [Frame Key]

Press [Frame Key] to select the frame design.

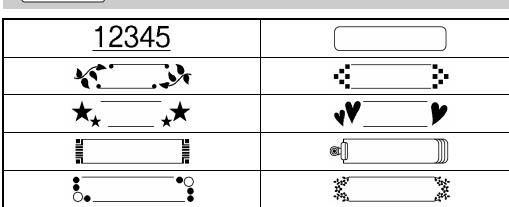

NOTE

- To cancel operations, press [Esc].
- Frames cannot be printed on 3.5mm tape.

Symbol Key [Symbol Key]

Press [Symbol Key] to select various symbols. Refer to the table of symbols below for a list of available symbols.

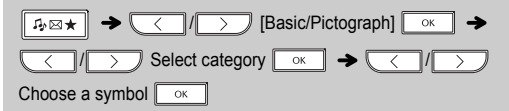

NOTE

To cancel operations, press [Esc].

Punctuation	1	2	3	4	5	6	7	8	9	10	11	
	,	.	:	"	'	•	?	!	¿	¡		
	&		_	/	\	*						
Business	1	2	3	4	5	6	7					
	©	#	%	®	©	™	✓					
Mathematics	1	2	3	4	5	6	7					
	+	-	×	÷	±	=	*					
Brackets	1	2	3	4	5	6	7	Arrows	1	2	3	4
	()	[]	<	>	§	→	←	↑	↓	
Unit	1	2	3	4	5	6	7					
	\$	¢	€	£	¥	°						
Greek Letter	1	2	3	4	5	6						
	α	β	γ	δ	μ	Ω						

Decorative Mode (Does not support Thai text.)

This function allows you to create unique labels by using built-in templates.

Example: [Decorative Mode]

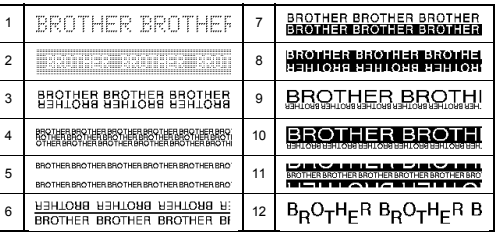
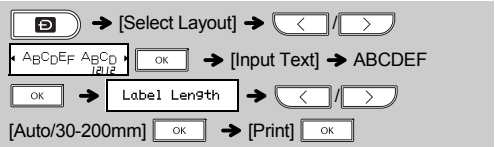

- To exit the Decorative Mode or Name Label function and return to the text input screen, do one of the following:

- Press [Esc].
- Press [Clear] to select [Cancel], and then press [OK] when "Print" appears.

- These features are only available when using 12mm wide tape cassettes.
- The maximum label length is 200mm for Decorative Mode and Name Label function.
- When [Auto] is selected for "Label Length", the label will automatically adjust to the correct length for printing the text one time.
- Press [Auto] to return to the [Auto] setting for "Label Length" mode.